

REV.	DATE	DESCRIPTION
NC	08/27/04	INITIAL RELEASE

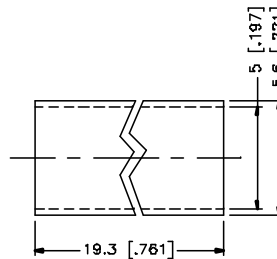
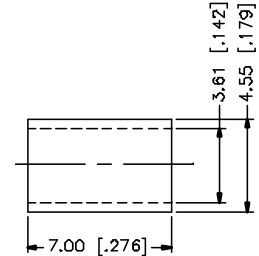
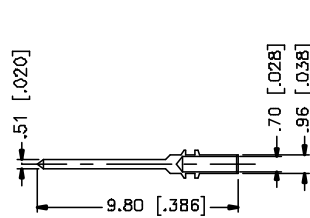
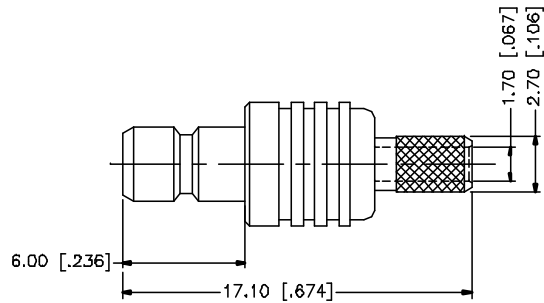
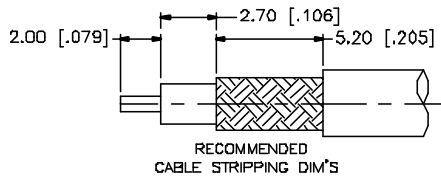

REV.	DATE	DESCRIPTION
NC	08/27/04	INITIAL RELEASE

8				UNLESS OTHERWISE SPECIFIED DIMENSIONS ARE IN MILLIMETERS. DIMENSIONS IN [] ARE IN INCHES AND FOR CUSTOMER REFERENCE ONLY.	APPROVALS	DATE	<h1 style="color: blue; margin: 0;">Amphenol Connex</h1>	
7				UNLESS OTHERWISE SPECIFIED TOLERANCES FOR MILLIMETERS ARE: 0.5 - 30mm ± 0.20mm 30 - 120mm ± 0.40mm	DRAWN	G.R.S.		08/27/04
6				UNLESS OTHERWISE SPECIFIED TOLERANCES FOR INCHES ARE: .020 - .315 = ± 0.007" .315 - 1.180 = ± 0.015" 1.180 - 4.724 = ± 0.020"	CHECKED			
5	HEAT SHRINK TUBE		1	DO NOT SCALE DRAWING	ISSUED			PART DESCRIPTION
4	FERRULE	COPPER	GOLD		SHEET	1 OF 1		SMB MINI 75ohm CRIMP JACK (FOR RG-179 BOUBLE BRAID CABLE)
3	CONTACT PIN	BRASS	GOLD				PART NO.	
2	INSULATOR	TEFLON	NATURAL				142190-75	
1	BODY	BRASS	GOLD					
	DESCRIPTION	MATERIAL	FINISH	QTY				

CAD FILE	C:/142/142190-75.DWG	DWG. NO.	142190-75.DWG	REV.	NC	SIZE	A	SCALE	NA
----------	----------------------	----------	---------------	------	----	------	---	-------	----