

REV.	DATE	DESCRIPTION
A	04/04/03	UPDATE DRAWING FORMAT

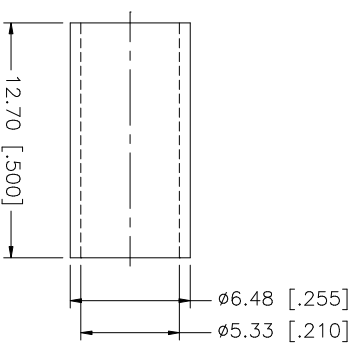
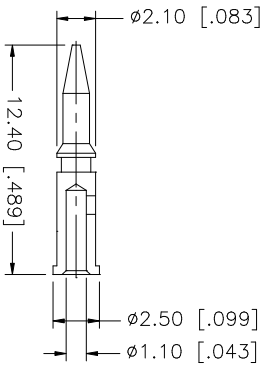
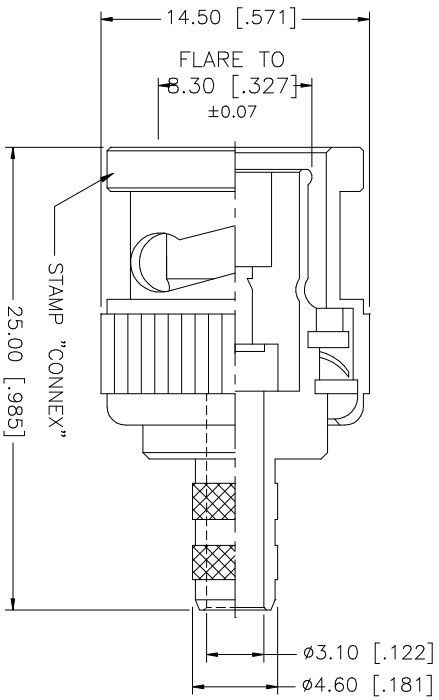
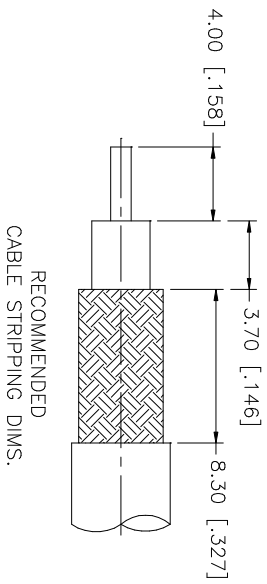

NO.	DESCRIPTION	MATERIAL	FINISH	QTY	UNLESS OTHERWISE SPECIFIED DIMENSIONS ARE IN MILLIMETERS. DIMENSIONS IN [] ARE IN INCHES AND FOR CUSTOMER REFERENCE ONLY. TOLERANCES FOR MILLIMETERS ARE: UNLESS OTHERWISE SPECIFIED: 0.5 - 8mm ± 0.20mm 8 - 30mm ± 0.40mm 30 - 120mm ± 0.50mm TOLERANCES FOR INCHES ARE: UNLESS OTHERWISE SPECIFIED: .020 - .315 = ± 0.007" .315 - 1.180 = ± 0.015" 1.180 - 4.724 = ± 0.020"	DO NOT SCALE DRAWING	APPROVALS	DATE	PART DESCRIPTION		
8								<h1 style="text-align: center;">Amphenol Connex</h1> <p style="text-align: center;">BNC CRIMP PLUG (FOR RG-58C/U CABLE)</p> <p style="text-align: center;">112116</p>			
7						DRAWN	G.R.S.		04/04/03		
6						CHECKED					
5						ISSUED					
4	FERRULE	COPPER	NICKEL	1		SHEET	1 OF 1				
3	CONTACT PIN	BRASS	GOLD	1		PART NO.					
2	INSULATOR	DELRI	NATURAL	1		DWG. NO.	112116.DWG				
1	SHELL/BODY	BRASS	NICKEL	1		REV.	A		SIZE	A	SCALE
DESCRIPTION											