

4

3

2

1

THIS DRAWING IS UNPUBLISHED. RELEASED FOR PUBLICATION N/A - N/A
COPYRIGHT N/A BY TYCO ELECTRONICS CORPORATION. ALL RIGHTS RESERVED.

LOC	DIST	REVISIONS					
DF	XO	F	LTR	DESCRIPTION	DATE	OWN	APPD
		O		PROPOSAL DRAWING	4-02	CT	RG

COMPONENT	MATERIAL	FINISH
HOUSING CLAMP NUT	STAINLESS STEEL PER ASTM-A-484 OR ASTM-A-582 TYPE 303	PASSIVATED PER QQ-P-35
DIELECTRIC	PTFE FLUOROCARBON PER ASTM-D-1457	-
CENTER CONTACT	BERYLLIUM COPPER PER ASTM-B-195 OR ASTM-B-197 ALLOY C17300, CONDITION H	COLD PLATED PER ASTM-B-48B
COLLAR	BRASS PER ASTM-B-16 1/2 HARD	COLD PLATED PER ASTM-B-48B

ENVIRONMENTAL
 TEMPERATURE RATING: -65°C TO +165°C
 VIBRATION: MIL-STD-202, METHOD 204, CONDITION D
 SHOCK: MIL-STD-202, METHOD 213, CONDITION 1
 MOISTURE RESISTANCE: MIL-STD-202, METHOD 106
 CORROSION: MIL-STD-202, METHOD 101, CONDITION B, 5% SALT SPRAY
 THERMAL SHOCK: MIL-STD-202, METHOD 107, CONDITION B

MECHANICAL
 INTERFACE DIMENSIONS: MIL-STD-348A FIG. 310.2
 RECOMMENDED MATING TORQUE: 7 - 10 IN-LBS
 FORCE TO ENGAGE & DISENGAGE (N-LBS MAX): 2.0
 WEIGHT (GRAMS): TBD
 INSERTION (MAX LBS): 3.0
 WITHDRAWAL (MIN OZ): 1.0
 MATING CHARACTERISTICS:
 AXIAL FORCE (LBS): 20.0
 TORQUE (IN-OZ): N/A
 CABLE RETENTION:
 AXIAL (LBS): 6.0
 RADIAL (IN-OZ): N/A
 CENTER CONTACT CAPTIVATION:
 AXIAL (LBS): 6.0
 RADIAL (IN-OZ): N/A

ELECTRICAL
 NORMAL IMPEDANCE (OHMS): 50
 FREQUENCY RANGE (GHz): DC TO MAX OPERATING FREQUENCY OF CABLE PER MIL-C-17
 VOLT RATING @ SEA LEVEL (VRMS MAX): 250
 VSWR: 1.15+0.2f(GHz)
 INSERTION LOSS: (dB MAX): .06 √f(GHz)
 RF LEAKAGE (dB MIN): -60-f(GHz)
 CORONA 70,000 FT (VRMS MIN): 190
 DIELECTRIC WITHSTANDING VOLTAGE (VRMS MIN) AT SEA LEVEL: 750
 I.R. (MEG OHMS MIN): 10,000
 RF HIGH POTENTIAL AT SEA LEVEL (VRMS MIN @ 5 MHz): 500
 CONTACT RESISTANCE (MILLIOHMS MAX):
 CENTER CONTACT: 3.0
 OUTER CONTACT: 2.0
 CABLE TO HOUSING: 0.5

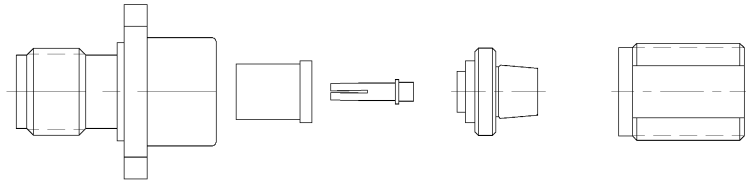

AS RECEIVED

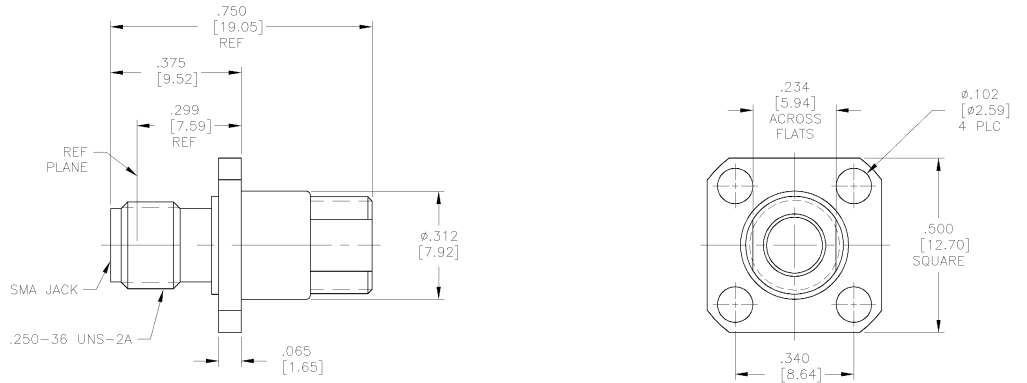

ASSEMBLED VIEW

DESIGNED TO USE RG-188U CABLE OR EQUIV. CABLE ENTRY DIAMETER MIN
DIELECTRIC: .066 [1.68]
CONTACT: .023 [0.58]
CLAMP NUT: .112 [2.84]
COLLAR: .065 [1.65]

THIS DRAWING IS A CONTROLLED DOCUMENT	DATE: 4-19-02
DIMENSIONS: INCHES (mm)	DATE: 4-19-02
NO DIMENSIONS UNLESS OTHERWISE SPECIFIED	DATE: 4-19-02
0 PLC # -	DATE: 4-19-02
1 PLC # -	DATE: 4-19-02
2 PLC # -	DATE: 4-19-02
3 PLC # .005 (0.13)	DATE: 4-19-02
4 PLC # -	DATE: 4-19-02
ANGLES: # -	DATE: 4-19-02

1484092-1 PART NO.
DESIGNED BY: C.C. THOMAS 4-19-02
CHECKED BY: C.C. THOMAS 4-19-02
DRAWN BY: S. GROSS 4-19-02
DATE: 4-19-02
APPLICATION SPEC: 20-075
WEIGHT: TBD
SCALE: A2 00779 C=1484092
CUSTOMER DRAWING
MA/CDM#: 2006-5218-02
SCALE: 1.0:1
SHEET: 1 OF 1
REV: 0

AMP 1471-9 REV 31MAR0000
28FEB2002 8:32am AMP16412 H:\docmod\1484092_1_c.dwg

1484092

A