

4

3

2

1

THIS DRAWING IS UNPUBLISHED.		RELEASED FOR PUBLICATION
COPYRIGHT BY TYCO ELECTRONICS CORPORATION. ALL INTERNATIONAL RIGHTS RESERVED.		
HOUSING CAP	STAINLESS STEEL PER ASTM-A484 AND ASTM-A582, TYPE 303	.000035-.000065 GOLD PL PER MIL-G-45204 OVER .000145-.000275 NICKEL PL PER AMS-QQ-N-290
DIELECTRIC	TFE FLUOROCARBON PER ASTM-D-1710	N/A
CENTER CONTACT CONTACT EXT.	BERYLLIUM COPPER PER ASTM-B-196, ALLOY C17300, CONDITION H	.000050-.000100 GOLD PL PER MIL-G-45204 OVER .000050 MIN NICKEL PL PER AMS-QQ-N-290
COMPONENT	MATERIAL	FINISH

LOC	DIST	REVISIONS		
P	LTR	DESCRIPTION	DATE	BY
C		REV PER ECO-10-009369	03JUN10	PY WM

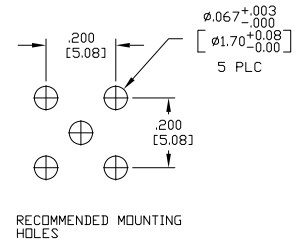
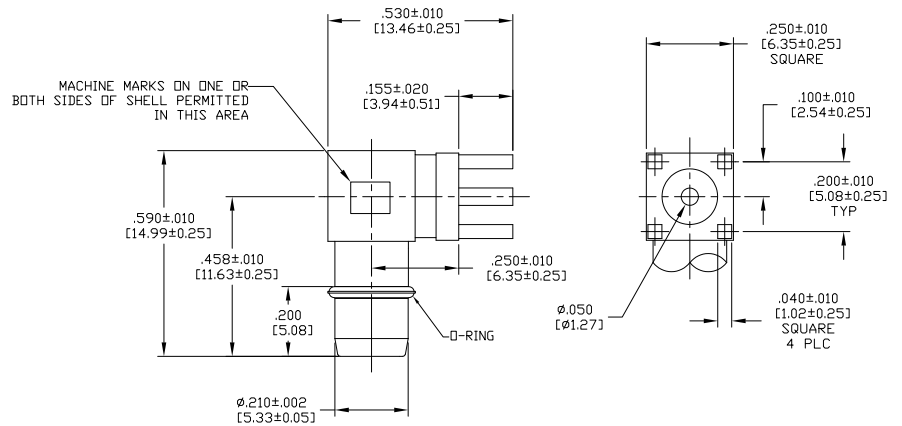

RECOMMENDED MOUNTING HOLES

ELECTRICAL	MECHANICAL	ENVIRONMENTAL
Nominal Impedance (Ohms) 50	Interface Dimensions: MIL-STD-348A, FIG 321-1	TEMPERATURE RATING -55°C TO +125°C
Frequency Range (GHz) DC to 22	Recommended Mating Torque N/A	Vibration MIL-STD-202, Method 204, Condition D
Volt Rating (VRMS MAX) @ Sea Level 335	Mating Characteristics: Insertion (MAX Lbs) 3.0	Shock MIL-STD-202, Method 213, Condition I
VSWR N/A	Withdrawal (MIN Oz) 1.0	Thermal Shock MIL-STD-202, Method 107, Condition B Except HIGH TEMP SHALL BE +125°C
Insertion Loss (dB MAX) N/A	Force to Engage (In-Lbs MAX) 3.0	Moisture Resistance MIL-STD-202, Method 106
RF Leakage (dB MIN) N/A	Force to Disengage (In-Lbs MAX) 1.5	Corrosion - MIL-STD-202, Method 101, Condition B, 5% salt spray
Corona, 70,000 Ft (VRMS MIN) 250	Center Contact Captivation: Axial (Lbs) 6.0	
Dielectric Withstanding Voltage (VRMS MIN) @ Sea Level 1,000	Radial (In-Oz) 4.0	
Contact Resistance (Milliohms MAX): Center Contact 3.0	Cable Retention: Axial Force (Lbs) N/A	
Outer Contact 2.0	Torque (In-Oz) N/A	
Cable to Housing N/A	Weight (Grams) TBD	
RF High Potential @ Sea Level (VRMS MIN @ 5 MHz) 670		
I.R.(Megohms MIN) 5,000		

1059691-1

PART NUMBER

THIS DRAWING IS A CONTROLLED DOCUMENT.		DATE	BY	APP'D	NAME	SIZE	CAGE CODE	DRAWING NO.	RESTRICTED TO
DIMENSIONS: INCHES		11FEB2009	P. YEACER			A2	00779	C=1059691	
TOLERANCES UNLESS OTHERWISE SPECIFIED:		12FEB09	W. MOYER						
Ø	PLC								
1	PLC								
2	PLC								
3	PLC								
4	PLC								
ANGLES									
MATERIAL	FINISH								
CUSTOMER DRAWING									

1471-9 (1/08)

1059691

A