

DESIGNED FOR USE WITH .085 S/R	
CABLE ENTRY DIAMETER MINIMUM	
HOUSING	.089
CONTACT	.0215

REVISIONS			
REV	DESCRIPTION	DATE	APPROVED
01 ₂	REVISED	K.L. 7-26-96	<i>[Signature]</i>
B	PER EC 0U20-0262-01	19DEC01	<i>[Signature]</i>

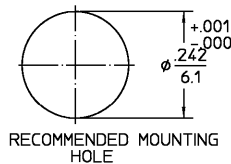

ELECTRICAL	MECHANICAL	ENVIRONMENTAL
Nominal Impedance (Ohms) 50	Interface Dimensions DESC SPEC 85071	Temperature Rating -65° to +125°C
Frequency Range (GHz) DC to 22	Mating Characteristics:	Vibration MIL-STD-202, Method 204, Condition D
Volt Rating (VRMS MAX) Sea Level 335	Insertion (MAX Lbs) 3	Shock ML-STD-202, Method 21B, Condition I
VSWR 1.05+0.005f(GHz) DC to 18 GHz	Withdrawal (MIN Oz) 1	Thermal Shock MIL-STD-202, Method 107, Condition B
1.05+0.009f(GHz) DC to 22 GHz	Force to Engage (In-Lbs MAX) 3 & Disengage (In-Lbs MAX) 15	Moisture Resistance MIL-STD-202, Method 106
Insertion Loss (dB MAX) .03x√f(GHz)	Center Contact Captivation Axial (Lbs) 6	Corrosion - MIL-STD-202, Method 101, Condition B
RF Leakage (dB MIN) (Interface Only, Fully Mated) -90-f(GHz)	Cable Retention Axial Force (Lbs MIN) 30 Torque (In-Oz MIN) 16	
Corona, 70,000 Ft (VRMS MIN) 250	Weight (Grams)	
Dielectric Withstanding Voltage (VRMS MIN) Sea Level 1000		
Contact Resistance (Milliohms MAX)		
Center Contact 2.0		
Outer Contact 2.0		
Cable to Housing 0.5		
RF High Potential Sea Level (VRMS MIN) 5 MHz 670		
IR (Megohms MIN) 5000		

COMPONENT	MATERIAL	FINISH
HOUSING MOUNTING NUT LOCKWASHER	STAINLESS STEEL PER ASTM-A484 AND ASTM-A582, TYPE 303	GOLD PLATE PER MIL-G-45204
DIELECTRIC	TFE FLUOROCARBON PER ASTM-D-1457	N/A
CENTER CONTACT	BERYLLIUM COPPER PER ASTM-B-196 OR ASTM-B-197, ALLOY C17300, CONDITION H	GOLD PLATE PER MIL-G-45204
O-RING	FLOUROSILICONE PER MIL-R-25988, CLASS 1, TYPE 1	N/A

UNLESS OTHERWISE SPECIFIED DIMENSIONS ARE IN INCHES	DRAWN BY H YUEN	DATE 1-9-88	AMP Incorporated 140 Fourth Avenue Waltham, MA 02451-7599								
FRAC. + 1/64	CHECKED BY MUM	1-12-88									
DEC. +.005	APPD BY BAR	1-12-88									
THESE DRAWINGS AND SPECIFICATIONS ARE THE PROPERTY OF M/A CDM INTERCONNECT DIV. AND SHALL NOT BE REPRODUCED OR COPIED OR USED IN WHOLE OR IN PART AS THE BASIS FOR THE MANUFACTURE OR SALE OF ITEMS WITHOUT WRITTEN PERMISSION.		USE ASSY PROCEDURE	TITLE OSP BULKHEAD FEEDTHRU CABLE PLUG DIRECT SOLDER ATTACHMENT								
NO. AP. 45-164		408-08291	<table border="1"> <tr> <td>SIZE B</td> <td>CODE IDENT NO. 26805</td> <td>4503-5023-00</td> <td>REV 01₂</td> </tr> <tr> <td>SCALE 5:1</td> <td colspan="2"></td> <td>SHEET 1 OF 1</td> </tr> </table>	SIZE B	CODE IDENT NO. 26805	4503-5023-00	REV 01 ₂	SCALE 5:1			SHEET 1 OF 1
SIZE B	CODE IDENT NO. 26805	4503-5023-00	REV 01 ₂								
SCALE 5:1			SHEET 1 OF 1								

COPY IN PUERTO RICO

CUSTOMER DRAWING

AMP PART # 1059386-1
SHEET 1 OF 1 REV B