

REVISIONS			
REV	DESCRIPTION	DATE	APPROVED
01	REVISED	02/23/95	<i>AP</i>

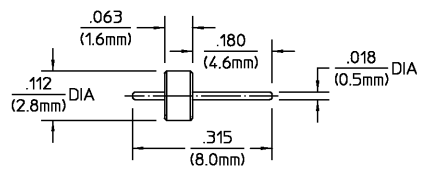

ELECTRICAL	MECHANICAL	ENVIRONMENTAL
Nominal Impedance (Ohms) 50	Interface Dimensions MIL-STD-348	Temperature Rating -65°C To +165°C
Frequency Range (GHz) DC - 18	FIG 310.2	Vibration - MIL-STD-202, Method 204, Condition D, 20G's
VSWR 1.06 + (.010 F(GHz))	Recommended Mating Torque N/A	Shock - MIL-STD-202, Method 107, Condition B
Insertion Loss (dB MAX) .04 √F(GHz)	Mating Characteristics: Insertion (MAX Lbs) 3.0	Thermal shock MIL-STD-202, Method 107, Condition B
RF Leakage (dB MIN) -(100 - F(GHz))	Withdrawal (MIN Oz) 1.0	Except High Temp 115°C
Corona, 70,000 Ft (VRMS MIN) 333	Force To Engage (In/Lbs MAX) 2.0	Moisture Resistance - MIL-STD-202, Method 106
Dielectric Withstanding Voltage (VRMS MIN) 1000 @ sea level	Force To Disengage (In/Lbs MAX) 2.0	Corrosion - MIL-STD-202, Method 101, Condition B, 5% salt spray
Contact Resistance (Milliohms MAX)	Center Contact Capcivation	Leak Test - MIL-STD-202, Method 112, Condition C, Procedure 1, 1 X 10 ⁻⁶ CC/SEC
Center Contact 10.0	Axial 6.0 Lbs	
Outer Contact 2.0	Radial N/A	
RF High Potential (VRMS MIN @ 5 MHz) 667 @ sea level	Weight (Grams) T.B.D.	
IR.(Megohms) 5000		

COMPONENT	MATERIAL	FINISH
HOUSING	STAINLESS STEEL PER ASTM-A484 AND ASTM-A582, TYPE 303	PASSIVATED PER ASTM-A380
DIELECTRIC	TFE FLUOROCARBON PER ASTM-D-1457	N/A
CENTER CONTACT	BERYLLIUM COPPER PER ASTM B 196, ALLOY C17300, CONDITION H	GOLD PLATE PER MIL-G-45204
CONTACT EXT BUSHING	IRON-NICKEL-COBALT ALLOY PER MIL-I-23011 (KOVAR)	GOLD PLATE PER MIL-G-45204
HERMETIC SEAL	GLASS BEAD	N/A
GASKET	CONDUCTIVE SILVER/SILICONE ELASTOMERS	N/A

UNLESS OTHERWISE SPECIFIED DIMENSIONS ARE IN INCHES TOLERANCE ON FRAC. DEC. ANGLES ± 1/64 ± .005 ± °	DRAWN BY <i>BB</i> DATE 7/1/94	AMP Incorporated 140 Fourth Avenue Waltham, MA 02451-7599							
	CHECKED BY								
APPROVED BY	USE ASSY PROCEDURE	TITLE OSM TWO-HOLE FLANGE MOUNT JACK RECEPTACLE WITH EMI/RFI GASKET							
NO. AP. 408-04866 (20-741)	<table border="1"> <tr> <td>SIZE B</td> <td>CODE IDENT NO. 26805</td> <td>2052-3357-02</td> <td>REV 01</td> </tr> <tr> <td>SCALE 5:1</td> <td colspan="2"></td> <td>SHEET 1 OF 1</td> </tr> </table>		SIZE B	CODE IDENT NO. 26805	2052-3357-02	REV 01	SCALE 5:1		
SIZE B	CODE IDENT NO. 26805	2052-3357-02	REV 01						
SCALE 5:1			SHEET 1 OF 1						

CUSTOMER DRAWING AMP PART # 1052639-1
SHEET 1 OF 1 REV A