

THIS DRAWING IS UNPUBLISHED.
 RELEASED FOR PUBLICATION
 BY TYCO ELECTRONICS CORPORATION. ALL RIGHTS RESERVED.

LOC	DATE	REVISIONS	DATE	BY	APP
AJ	16				

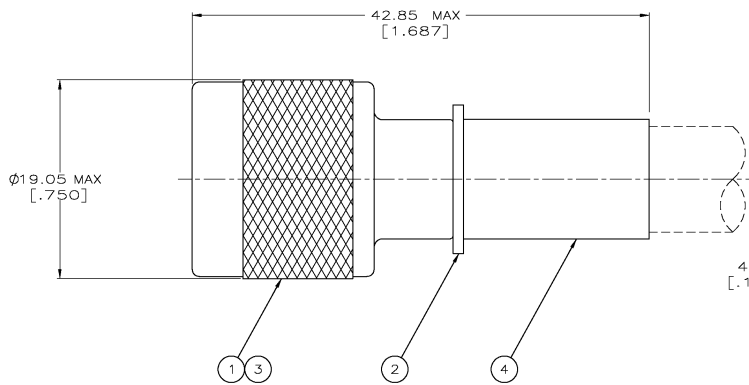

- ▲ KIT PACKAGED.
- ▲ SEE SEPARATE RESTRICTED CUSTOMER DRAWING.
- ▲ OBSOLETE PART NUMBER.
- ▲ SAME AS 3-227086-1 EXCEPT PACKAGED 10 PER BOX

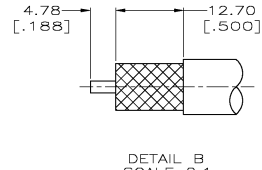
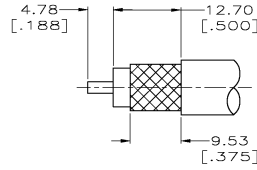

RECOMMENDED STRIP LENGTH

▲ SUPERSEDED BY 1-227086-0
 ▲ SUPERSEDED BY 1-227086-0
 ▲ SUPERSEDED BY 1-227086-0

										3-227086-6
A	220015-1	RG-8/U & 213/U	51713-9	2-51695-1	227116-1	227112-1				▲ 3-227086-5
										▲ 3-227086-1
										▲ 2-227086-3
										▲ 2-227086-1
										▲ 2-227086-0
A	220015-1	RG-8 & RG-213/U	51713-9	1-51695-6	227116-1	227112-1				▲ 1-227086-9
										▲ 1-227086-2
B	220015-1	RG-9/U & 214/U	1-51713-3	2-51695-1	227116-1	227112-1				▲ 1-227086-1
A	220015-1	RG-8/U & 213/U	9-51713-0	2-51695-1	227116-1	227112-1				▲ 1-227086-0
										▲ 227086-6
										▲ 227086-3
B	220015-1	RG-9/U & 214/U	1-51713-3	1-51695-3	227116-1	227112-1				▲ 227086-2
B	220015-1	RG-213/U	51713-9	1-51695-3	227116-1	227112-1				▲ 227086-1
DETAIL	CRIMP TOOL	CABLE SIZE	④ FERRULE QTY=1	③ CONTACT QTY=1	② CRIMP LOCATOR QTY=1	① PLUG ASSEMBLY QTY=1				PART NUMBER

THIS DRAWING IS A CONTROLLED DOCUMENT.		DWN B. MOYER 11-4-91 CHK M. SNEED 11-6-91 DSK R. HENRY 11-6-91 PROD R. HENRY PRODUCT SPEC 108-12056 APPLICATION SPEC		Tyco Electronics Corporation Harrisburg, PA 17105-3508 PLUG, COMMERCIAL, SERIES N	
DIMENSIONS:	TOLERANCES UNLESS OTHERWISE SPECIFIED:	SIZE	DATE CODE	DRAWING NO	RESTRICTED TO
INCHES:	0 R/L ± .010 1 R/L ± .010 2 R/L ± .010 3 R/L ± .010 (0.010) 4 R/L ± .010 ANGLES ± .010	A2	00779	227086	
MATERIAL:	FINISH:	SCALE	SHEET	OF	REV
		4:1	1	1	N