

4

3

2

1

THIS DRAWING IS UNPUBLISHED. RELEASED FOR PUBLICATION
 © COPYRIGHT BY TYCO ELECTRONICS CORPORATION. ALL RIGHTS RESERVED.

LOC	DIST	REVISIONS			
P	LTR	DESCRIPTION	DATE	MIN	APVD
AJ	16				
B		REVISED PER ECO 07-002853	21MAR2007	DW	JL

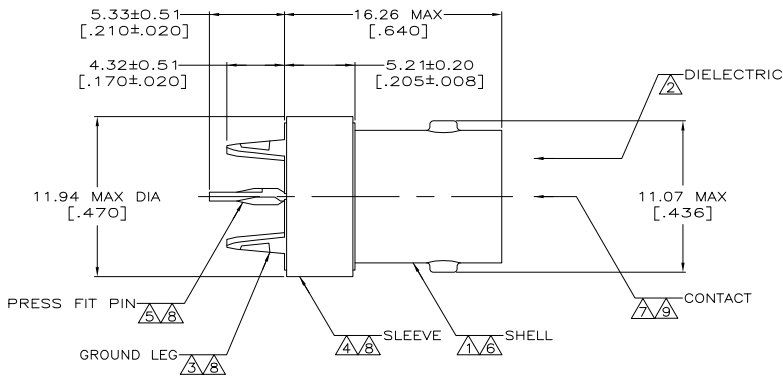

- △ ZINC PER QQ-Z-363.
 - △ PTFE PER ASTM D 1710.
 - △ COPPER-IRON ALLOY PER ASTM B 465.
 - △ COPPER PER QQ-C-576.
 - △ COPPER-NICKEL ALLOY PER ASTM B 122.
 - △ NICKEL PLATE PER QQ-N-290
3.81 μm [.000150] MINIMUM THICK.
 - △ GOLD PLATE PER ASTM B 488
0.76 μm [.000030] MINIMUM THICK.
 - △ TIN PLATE PER ASTM B 545,
2.54 μm [.000100] MIN THICK.
 - △ BERYLLIUM COPPER PER ASTM B 643.
10. INTERFACE DIMENSIONS PER LUCCENT SPEC WP-92009.
11. CONNECTOR PRESS FIT IS DESIGNED TO PROVIDE 100 LB. MINIMUM AXIAL RETENTION TO PCB COMPLIANT WITH TYCO APPLICATION SPEC 114-12001. AS A RESULT, DEFORMATION OF PLATED THROUGH HOLES WILL OCCUR. CUSTOMER VALIDATION AND ACCEPTANCE OF THIS DEFORMATION IS RECOMMENDED PRIOR TO SPECIFYING USE OF THIS PRODUCT.

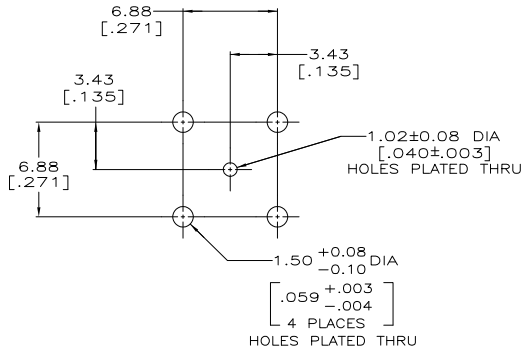

PCB CONFIGURATION

5414088-1
 PART NUMBER

THIS DRAWING IS A CONTROLLED DOCUMENT.		DWG: 22APR2005 A. FERNANDEZ-220015 OK: J. HAVENER 22APR2005 J. LIPPERT 22APR2005	 Tyco Electronics Corporation Harrisburg, PA 17105-3608
DIMENSIONS: mm (INCHES) 0 PLG ± - 1 PLG ± - 2 PLG ± 0.05 (0.02) 3 PLG ± - 4 PLG ± - ANGLES ± -	DIMENSIONS: mm (INCHES) 0 PLG ± - 1 PLG ± - 2 PLG ± 0.05 (0.02) 3 PLG ± - 4 PLG ± - ANGLES ± -	PRODUCT SPEC: J. LIPPERT APPLICATION SPEC: - WEIGHT: - FINISH: -	SIZE: A2 CASE CODE: 00779 DRAWING NO: C=5414088 RESTRICTED TO: - SCALE: 5:1 SHEET: 1 of 1 REV: B
NOTES 1-5, 9		NOTES 6-8	
MATERIAL		CUSTOMER DRAWING	

5414088

A