

4

3

2

1

THIS DRAWING IS UNPUBLISHED. RELEASED FOR PUBLICATION  
 © COPYRIGHT 2005 BY TYCO ELECTRONICS CORPORATION. ALL RIGHTS RESERVED.

LOC	DIST	REVISIONS			
F	LNK	DESCRIPTION	DATE	BY	APP'D
J		REVISED PER EC 0514-0457-04	04NOV05	TS	JL
J1		REVISED PER ECO-09-020932	04SEP09	KK	AEG

- △ CONTACT CRIMP TOOLING: CRIMP TOOL M22520/2-01 WITH POSITIONER DMC K997  
 SELECTOR SETTING #6 FOR RG-58/U AND RG-400/U CABLE  
 SELECTOR SETTING #7 FOR RG-142/U AND BELDEN YR20621 CABLE  
 SELECTOR SETTING #4 FOR RG-174/U, RG-188/U & RG-316/U  
 SINGLE AND DOUBLE SHIELDED CABLE.
- △ FERRULE CRIMP TOOLING: CRIMP TOOL M22520/5-01 WITH DIE SET M22520/5-11  
 OR USE A 5.41 [.213] X 10.16 [.400] HEX DIE SET.
- △ FERRULE CRIMP TOOLING: CRIMP TOOL M22520/5-01 WITH DIE SET M22520/5-35B  
 OR USE A 3.25 [.128] X 10.16 [.400] HEX DIE SET.
- 4. PRODUCT DESIGNED TO MEET PRODUCT SPECIFICATION 108-1574.
- 5. INSTRUCTION SHEET: 408-4032
- △ OBSOLETE PARTS: OBSOLETE CIS STREAMLINING PER  
 D.RENAUD/D.SINISI

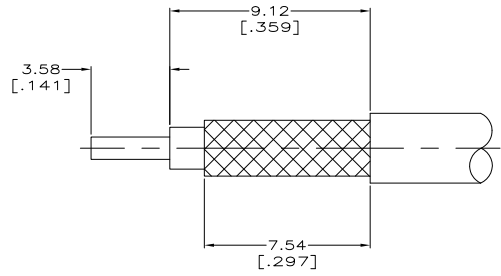
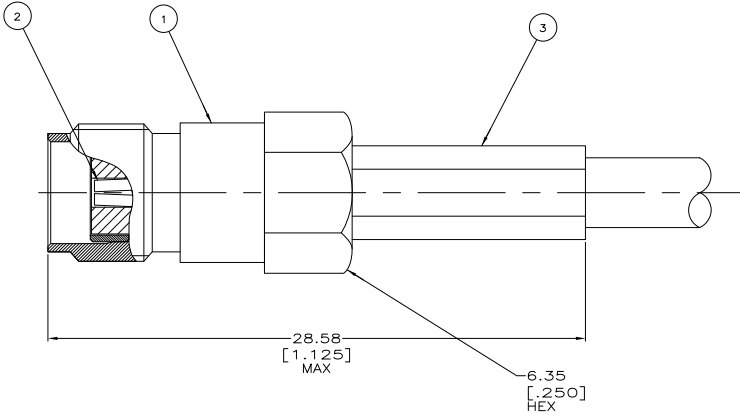

RECOMMENDED STRIP LENGTHS

△ OBSOLETE	△ △	RG-174, -188, & -316/U	9-446556-1	447842-3	447963-2	9-447648-0
OBSOLETE		RESTRICTED CUSTOMER DRAWING-SEE DASH NUMBER DRAWING				447648-6
OBSOLETE	△ △	BELDEN YR20621	2-446556-7	447961-3	447963-3	447648-5
OBSOLETE	△ △	RG-188 & -316 DOUBLE SHIELDED	2-446556-4	447842-3	447963-2	447648-4
	△ △	RG-174, -188, & -316/U	9-446556-1	447842-3	447963-2	447648-3
OBSOLETE	△ △	RG-142, -142A, -142B, & -400/U	9-446556-0	447961-3	447963-1	447648-2
OBSOLETE	△ △	RG-58, -58A, -58B & -58C/U	9-446556-2	447961-3	447963-1	447648-1
		CRIMP TOOLING	CABLE	③ FERRULE QTY=1	② CONTACT QTY=1	① JACK ASSY QTY=1
						PART NUMBER

THIS DRAWING IS A CONTROLLED DOCUMENT.

DIMENSIONS: mm [INCHES]	TOLERANCES UNLESS OTHERWISE SPECIFIED:	DRN: B. MOYER 13MAY97	CHK: J. CABARLO 14MAY97	DATE: 14MAY97	BY: J. CABARLO 14MAY97	NAME: J. CABARLO
0 P.L.C. ± .005	1 P.L.C. ± .005	2 P.L.C. ± .005	3 P.L.C. ± .005	4 P.L.C. ± .005	ANGLES ± .005	FINISH -
APPLICATION SPEC: -			SIZE: A2		QAGE CODE: 00779	DRAWING NO: C=447648
MATERIAL: -			WEIGHT: -		RESTRICTED TO: -	
CUSTOMER DRAWING			SCALE: 8:1		SHEET: 1 of 1 REV: J1	

Tyco Electronics Corporation  
 Harrisburg, PA 17105-3608  
**JACK, HEX CRIMP, COMMERCIAL, SMA**

AMP 1471-9 REV 31MMR2000

04NOV2005 2:44pm p9391 E:\0s14-0457-04\_client\447648\_1-c.dwg

447648

A