

4

3

2

1

THIS DRAWING IS UNPUBLISHED. RELEASED FOR PUBLICATION JUNE, 2006.

COPYRIGHT 2006 BY TYCO ELECTRONICS CORPORATION. ALL RIGHTS RESERVED.

NOTES:

- △ SINGLE PACK IN ACCORDANCE WITH AMP SPEC 107-3275
 △ 100 TRAY PACK IN ACCORDANCE WITH AMP SPEC 107-3275
 △ Ag PLATING

4 ELECTRICAL CHARACTERISTICS

FREQUENCY RANGE:	DC - 2 GHz
NOMINAL IMPEDANCE:	75 Ohm
INSULATION RESISTANCE:	5000 MOhm
WORKING VOLTAGE:	500 Volts RMS at Sea Level
DIELECTRIC WITHSTAND VOLTAGE:	1500 Volts RMS Max
CONTACT RESISTANCE:	1.50 mOhm Max
CENTRE CONTACT:	0.20 mOhm Max
OUTER CONTACT:	1.20:1 Max
VSWR @ 2GHz:	1.20:1 Max
INSERTION LOSS dB @ x 2 GHz:	0.20 Max

5 MECHANICAL CHARACTERISTICS

COUPLING RETENTION FORCE:	N/A
CABLE RETENTION FORCE:	85N Min
CLAMP NUT RECOMMENDED TORQUE:	4N
DURABILITY:	500 Cycles Min

6 ENVIRONMENTAL CHARACTERISTICS

OPERATING TEMPERATURE:	-65 to +165 DegC
------------------------	------------------

7 FOR TECHNICAL DATA REFER TO YOUR LOCAL TYCO ELECTRONICS SALES OFFICE

8 ALL DIMENSIONS ARE NOMINAL FOR REFERENCE ONLY UNLESS OTHERWISE STATED

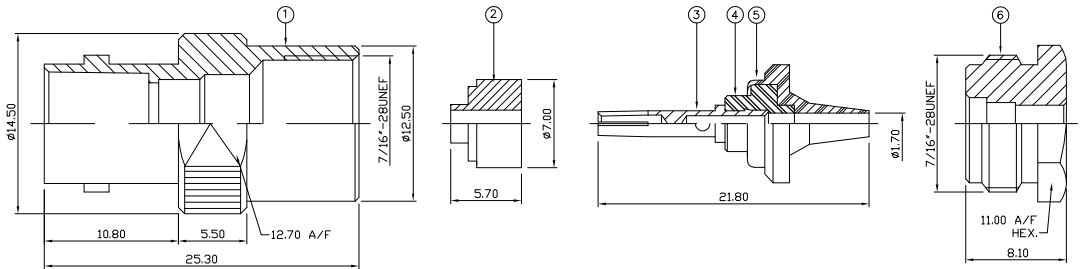

RECOMMENDED CABLE STRIPPING DIM'S

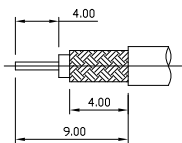

THIS DRAWING IS A CONTROLLED DOCUMENT.

DIMENSIONS:

mm

TOLERANCES UNLESS OTHERWISE SPECIFIED:

0 PLC	± .05
1 PLC	± .02
2 PLC	± .01
3 PLC	± .005
4 PLC	± .002
ANGLES	± .05

MATERIAL

FINISH

SEE TABLE

DWN J. SANDWELL 30JUN06

CHK S. PARLOW 30JUN06

APVD E. WHEELER-KING 30JUN06

PRODUCT SPEC

APPLICATION SPEC

WEIGHT

CUSTOMER DRAWING

30JUN06

30JUN06

30JUN06

QUANTITY PER ASSY	PARTS LIST			
1	1	BRASS	△ CLAMP NUT	6
1	1	BRASS	△ SLEEVE	5
1	1	PTFE	INSULATION	4
1	1	BRASS	△ CONTACT	3
1	1	PTFE	INSULATION	2
1	1	BRASS	△ BODY	1
6--0	1--0	MATERIAL	DESCRIPTION	ITEM

Tyco Electronics Corporation
 Bideford EX39 4HE
tyco
Electronics
 NAME BNC STRAIGHT WEDGE CLAMP JACK 75 OHM
 RG179B/U, 187A/U, URM111
 SIZE CAGE CODE DRAWING NO RESTRICTED TO
 A3 00779 C-1478115
 SCALE NTS SHEET 1 OF 1 REV B