

THIS DRAWING IS UNPUBLISHED. RELEASED FOR PUBLICATION. BY TYCO ELECTRONICS CORPORATION. ALL RIGHTS RESERVED.

LOC	DIST	REVISIONS			
		REV	DESCRIPTION	DATE	BY
AJ	16	A	REVISED PER EC 0514-0150-05	01SEP05	BM JL

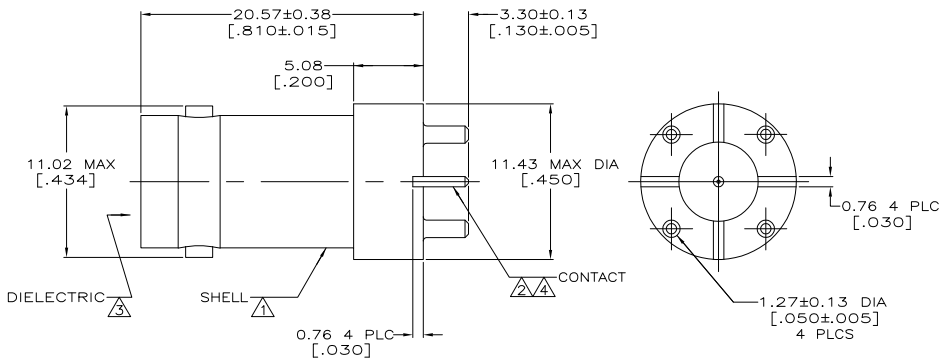

- △ ZINC PER QQ-Z-363
- △ BERYLLIUM COPPER PER ASTM-B-196
- △ PTFE PER MIL-P-1946B
- △ GOLD PLATE PER MIL-G-45204
0.76 μm [.000030] MINIMUM THICK.
- △ TIN PLATE PER ASTM-B-545,
3.04 μm [.000120] MINIMUM THICK.
- 6. SEE INSTRUCTION SHEET 408-9889.
- △ NICKEL PLATE PER QQ-N-290
5.08 μm [.000200] MINIMUM THICK.

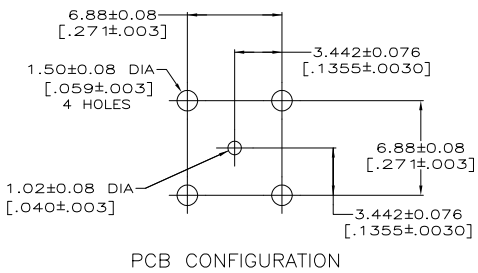

△	6274291-2
△	6274291-1
SHELL FINISH	PART NUMBER

THIS DRAWING IS A CONTROLLED DOCUMENT.		DRN L VARELA - 02FEB2005	Tyco Electronics Corporation	
DIMENSIONS: INCHES		CHK J HAVENER 02FEB2005	Harrisburg, Pa 17105-3608	
TOLERANCES UNLESS OTHERWISE SPECIFIED:		APPRO J LIPPERT 02FEB2005	NAME	
0 PLC ± -		PRODUCT SPEC	108-12078	
1 PLC ± -		APPLICATION SPEC	-	
2 PLC ± 0.30 (100%)		SIZE	CAGE CODE	DRAWING NO
3 PLC ± -		WEIGHT	A2 00779	C-6274291
4 PLC ± -		FINISH	CUSTOMER DRAWING	
ANGLES			SCALE	5:1
FINISH			SHEET	1 of 1
SEE NOTES 1 - 3	SEE NOTES 4, 5		REV	A