

4

3

2

1

THIS DRAWING IS UNPUBLISHED. RELEASED FOR PUBLICATION
 © COPYRIGHT BY TYCO ELECTRONICS CORPORATION. ALL RIGHTS RESERVED.

LOC	DIST	REVISIONS		
P	LTR	DESCRIPTION	DATE	BY
AJ	16			
E		PER EC 0514-0180-04	06OCT2004	JGH/JGH

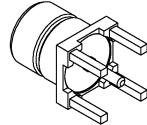

ISOMETRIC VIEW

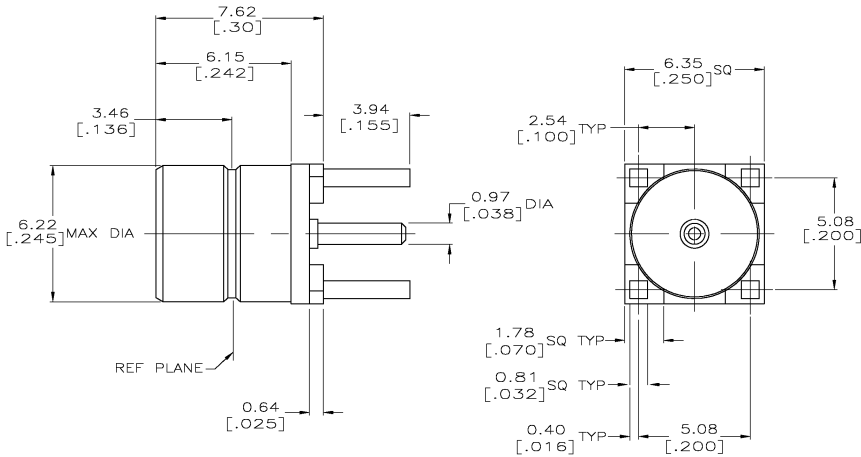

- 1 BRASS PER ASTM-B-453
- 2 TEFLON PER ASTM-D-1710
- 3 GOLD PLATE PER MIL-G-45204 OVER NICKEL PLATE PER QQ-N-290.
- 4 NICKEL PLATE PER QQ-N-290 OVER COPPER PER MIL-C-14550.
- 5 GOLD PLATE PER MIL-G-45204 .000050 MIN THK OVER NICKEL PLATE PER QQ-N-290.
- 6 TIN PLATE PER ASTM B 545.
- 7 TIN PLATE PER ASTM-B-545 .000050 MIN THK OVER NICKEL PLATE PER QQ-N-290

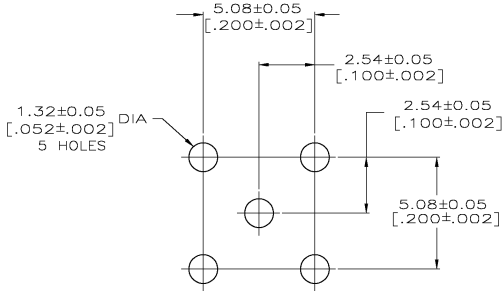

RECOMMENDED PCB CONFIGURATION

SUPERSEDED BY 414244-1
 SUPERSEDED BY 414244-4

---	1	9-414244-0
---	2	414244-4
---	3	414244-3
---	4	414244-2
---	5	414244-1
DIELECTRIC	CONTACT	FINISH BODY ASSY NO

THIS DRAWING IS A CONTROLLED DOCUMENT.		DWG		Tyco Electronics Corporation	
DIMENSIONS: INCHES		K. RIELY	1/6/92	Harrisburg, PA 17105-3608	
TOLERANCES UNLESS OTHERWISE SPECIFIED:		C. MICHAEL	1/6/92	JACK, RCPT, STR, SMB/PCB	
0 PLG ± .005		K. HELLIG	01-07-92	APPLICATION SPEC: ---	
1 PLG ± .005				PRODUCT SPEC: ---	
2 PLG ± .005				HEIGHT: ---	
3 PLG ± .005				WEIGHT: ---	
4 PLG ± .005				SCALE: 8:1	
ANGLES ± .005				SHEET 1 OF 1	
FINISH: SEE TABLE				REV E	
MATERIAL: SEE TABLE		CUSTOMER DRAWING		RESTRICTED TO: ---	