

4

3

2

1

THIS DRAWING IS UNPUBLISHED. RELEASED FOR PUBLICATION
 © COPYRIGHT BY TYCO ELECTRONICS CORPORATION. ALL RIGHTS RESERVED.

LOC	DIST	REVISIONS			
F	LTR	DESCRIPTION	DATE	OWN	APP
AJ	16	REV PER ECO 07-006131	15MAR2007	DW	JL

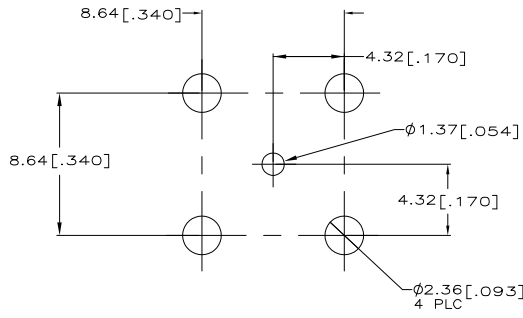
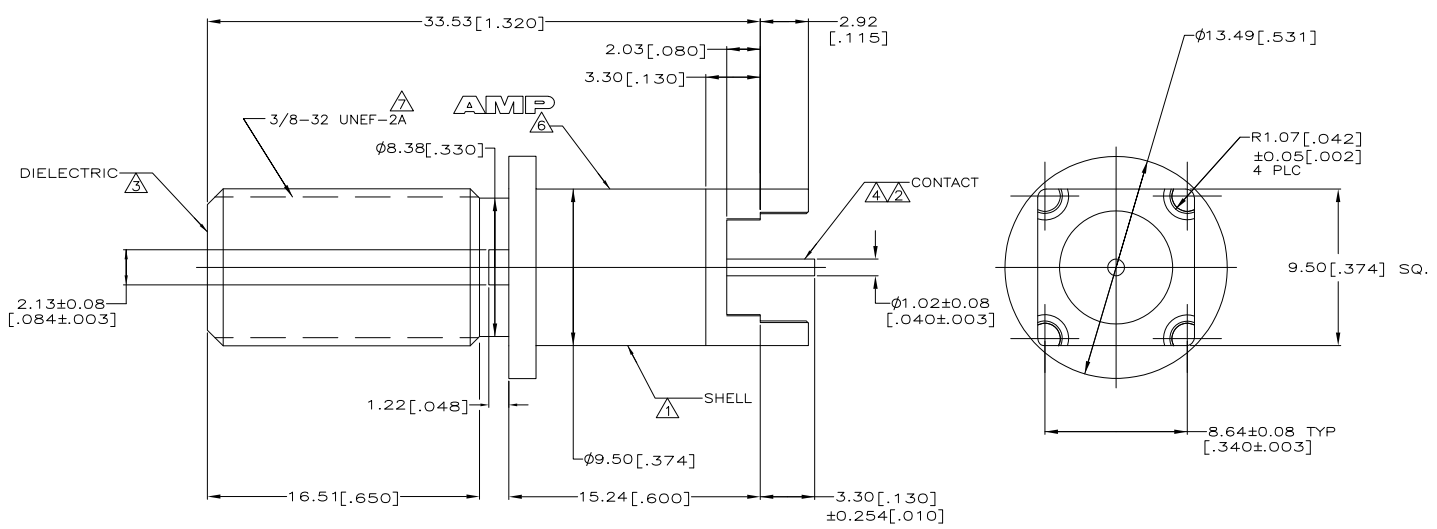

PCB CONFIGURATION
 TOLERANCE = ±0.08 [.003]

- △ ZINC PER QQ-Z-363.
- △ PHOSPHOR BRONZE PER QQ-B-750.
- △ POLYMETHYLPENTENE AND ACETAL, GENERAL PURPOSE.
- △ MATTE TIN PLATE PER ASTM-B-545, 3.81 μm [.000150] MINIMUM THICK.
- 5. CONNECTOR WILL ACCEPT A CENTER CONDUCTOR DIAMETER RANGE OF 0.56 [.022] - 1.19 [.047].
- △ LOGO WILL BE LOCATED ON SURFACE INDICATED.
- △ MAJOR DIA MODIFIED TO .363 REF.
- △ BRIGHT TIN PLATE PER ASTM-B-545, 3.81 μm [.000150] MINIMUM THICK.

△	6274020-2
△	6274020-1
SHELL FINISH	PART NO

THIS DRAWING IS A CONTROLLED DOCUMENT.		DN I. VARELA	01FER2005	Tyco Electronics Corporation	
DIMENSIONS: mm [INCHES]		CHK J. HAVENER	01FER2005	Harrisburg, Pa 17105-3608	
TOLERANCE UNLESS OTHERWISE SPECIFIED:		APP K. WEIDNER	01FER2005	NAME JACK, VERT, PCB, F SERIES	
0 PLC	±	APPLICATION SPEC	---	SIZE	CASE CODE (DRAWING NO)
1 PLC	±	WEIGHT	---	A2	00779C-6274020
2 PLC	± 0.20 (.008)	FINISH	---	CUSTOMER DRAWING	RESTRICTED TO
3 PLC	±	SEE TABLE	---	SCALE	6:1
4 PLC	±		---	SHEET	1 of 1
ANGLES	±		---	REV	A

AMP 1471-9 REV 31MM2000

6274020

A