

4

3

2

1

THIS DRAWING IS UNPUBLISHED. RELEASED FOR PUBLICATION JAN. 2006.
 © COPYRIGHT 2006 BY TYCO ELECTRONICS CORPORATION. ALL RIGHTS RESERVED.

LOC	DIST	REVISIONS			
P	LTR	DESCRIPTION	DATE	DWN	APVD
D1		ECO-10-015281	5Jul2010	AM	RITA

NOTES:

- ▲ PACK IN ACCORDANCE WITH AMP SPEC 107-3275
- ▲ 100 TRAY PACK IN ACCORDANCE WITH AMP SPEC 107-3275
- ▲ Au PLATING
- 4 ELECTRICAL CHARACTERISTICS
 - FREQUENCY RANGE: DC - 4 GHz
 - NOMINAL IMPEDANCE: 50 Ohm
 - INSULATION RESISTANCE: 1000 MOhm
 - WORKING VOLTAGE: 250 Volts RMS at Sea Level
 - DIELECTRIC WITHSTAND VOLTAGE: 750 Volts RMS Max
 - CONTACT RESISTANCE:
 - CENTRE CONTACT: 6.00 mOhm Max
 - OUTER CONTACT: 1.00 mOhm Max
- 5 MECHANICAL CHARACTERISTICS
 - DURABILITY: 500 Cycles Min
- 6 ENVIRONMENTAL CHARACTERISTICS
 - OPERATING TEMPERATURE: -65 to +165 DegC
- 7 FOR TECHNICAL DATA REFER TO YOUR LOCAL TYCO ELECTRONICS SALES OFFICE
- 8 ALL DIMENSIONS ARE NOMINAL FOR REFERENCE ONLY UNLESS OTHERWISE STATED

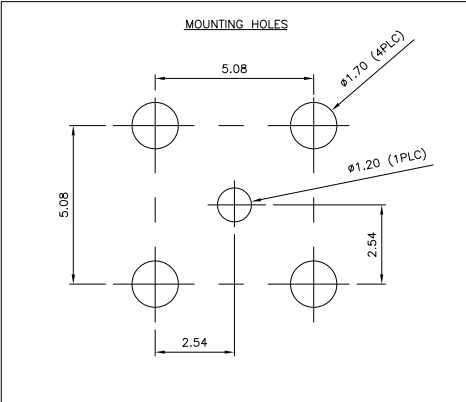
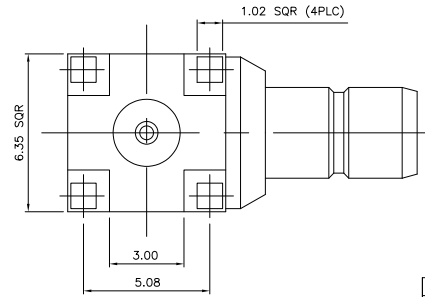
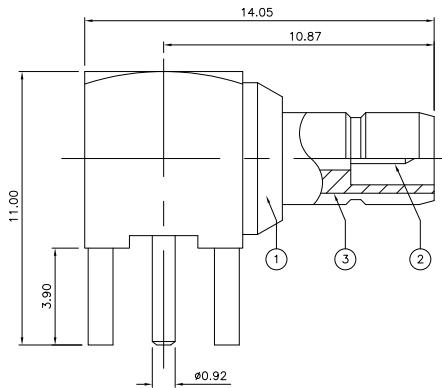

QTY	DESCRIPTION	ITEM
1	PTFE	INSULATION
1	PHOSPHOR BRONZE	CONTACT
1	BRASS	BODY
6--0	MATERIAL	DESCRIPTION

THIS DRAWING IS A CONTROLLED DOCUMENT.

DIMENSIONS:	TOLERANCES UNLESS OTHERWISE SPECIFIED:	DWN	12JAN06	Tyco Electronics		Tyco Electronics Corporation
mm	0 PLC ± .05	CHK	12JAN06	Bideford EX39 4HE		
	1 PLC ± .05	APVD	12JAN06	NAME		SMB ELBOW PCB SOCKET 50 OHM
	2 PLC ± .05	PRODUCT SPEC				
	3 PLC ± .05	APPLICATION SPEC				
	4 PLC ± .05	WEIGHT				
	ANGLES ± .05	SIZE				A3
MATERIAL	FINISH	CAGE CODE				00779
SEE TABLE		DRAWING NO				1337481
		RESTRICTED TO				
		CUSTOMER DRAWING				SCALE
		SHEET				1 OF 1
		REV				D1

AMP 1470-19 REV 31MAR2000