

THIS DRAWING IS UNAPPROVED FOR REVISIONS
 © 2007 BY TDS ELECTRONICS CORPORATION. ALL RIGHTS RESERVED.

REV	DATE	DESCRIPTION	BY	APP
00				
01	2/6/2007	REV PER ECO 06-03805	DW	JL

- ⚠ USE WITH HAND TOOL 220190-1
- ⚠ CABLE USED WITHOUT SPACER.
- ⚠ CABLE USED WITH SPACER.
- ⚠ BULK PACKAGE
- 5. SEE I.S. SHEET 9778

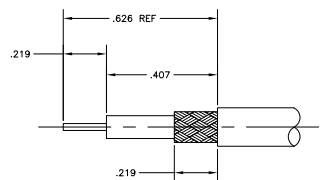
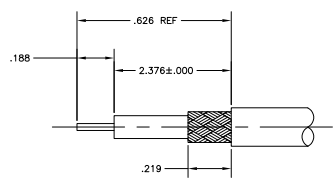
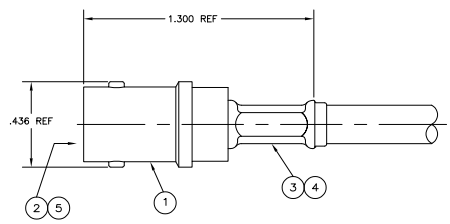

VIEW A VIEW B
 RECOMMENDED STRIP LENGTH

OBSOLETE	BELDEN 89907, 9907 & RG-141	A	.068	.213	58465-3	-	-	9-221132-0	2-413774-5	413780-1	9-413779-1
OBSOLETE	RG-174/U, 188/U & 316/U	B	.068	.178	58465-3	-	21427-2	9-413658-0	1-413774-5	413780-3	9-413779-0
OBSOLETE	BELDEN 89907, 9907 & RG-141	A	.068	.213	58465-3	-	-	9-221132-0	2-413774-5	413780-1	413779-6
OBSOLETE	RG-180 & RG-195	A	.068	.178	58465-3	-	-	9-413658-1	2-413774-0	413780-3	413779-5
OBSOLETE	RG-179U, 179A/U, 179B/U, 187/U & 187A/U	A	.068	.178	58465-3	-	21427-2	9-413658-0	2-413774-0	413780-3	413779-4
OBSOLETE	RG-174/U, 188/U & 316/U	B	.068	.178	58465-3	-	21427-2	9-413658-0	1-413774-5	413780-3	413779-3
OBSOLETE	RG-59/U, 59A/U, 59B/U, 62/U, 62A/U, 62B/U & BELDEN 88241	A	.068	.255	58465-1	227423-1	-	9-221132-1	1-413774-0	413780-2	413779-2
OBSOLETE	RG-58/U, 58A/U, 58B/U, 58C/U & BELDEN 88240	A	.068	.213	58465-1	-	-	9-221132-0	413774-5	413780-1	413779-1

FOR USE WITH CABLE VIEW CONTACT CRIMP (HEX) FERRULE CRIMP DIE SET (1) (5) SPACER QTY=1 (4) TUBING QTY=1 (3) FERRULE QTY=1 (2) CONTACT QTY=1 (1) JACK ASSEMBLY QTY=1 PART NUMBER

THIS DRAWING IS A CONTROLLED DOCUMENT

DESIGNED BY: L. COBET 02/07/07
 CHECKED BY: J. MADRZO 03/07/07
 DRAWN BY: M. PHILLIPS 03/07/07
 REVISED BY: M. PHILLIPS 03/07/07
 APPROVED BY: M. PHILLIPS 03/07/07

TDS Electronics Corporation
 Harrisburg, PA 17105-3608

JACK, HEX CRIMP,
 COMMERCIAL ENG.

SIZE: A1
 DATE: 00779
 DRAWING NO: 413779
 CUSTOMER DRAWING

REV: 1
 SHEET: 1
 OF: 1
 G2