

4

3

2

1

THIS DRAWING IS UNPUBLISHED. RELEASED FOR PUBLICATION NOV. 2005.  
 © COPYRIGHT 2005 BY TYCO ELECTRONICS CORPORATION. ALL RIGHTS RESERVED.

LOC	DIST	REVISIONS			
P	LTR	DESCRIPTION	DATE	DWN	APVD
C		ECR-05-016219	28NOV05	JMS	FWK

- NOTES:**
- ▲ PACK IN ACCORDANCE WITH AMP SPEC 107-3275
  - ▲ 100 TRAY PACK IN ACCORDANCE WITH AMP SPEC 107-3275
  - ▲ Au PLATING
  - ▲ Ni PLATING
- 5 **ELECTRICAL CHARACTERISTICS**  
 FREQUENCY RANGE: DC - 4 GHz  
 NOMINAL IMPEDANCE: 50 Ohm  
 INSULATION RESISTANCE: 5000 MOhm  
 WORKING VOLTAGE: 500 Volts RMS at Sea Level  
 DIELECTRIC WITHSTAND VOLTAGE: 1500 Volts RMS Max  
 CONTACT RESISTANCE:  
 CENTRE CONTACT: 1.50 mOhm Max  
 OUTER CONTACT: 0.20 mOhm Max  
 VSWR @ xGHz: N/A  
 INSERTION LOSS xdb: N/A
- 6 **MECHANICAL CHARACTERISTICS**  
 COUPLING RETENTION FORCE: N/A  
 CABLE RETENTION FORCE: N/A  
 MOUNT NUT RECOMMENDED TORQUE: 2.5N  
 DURABILITY: 500 Cycles Min
- 7 **ENVIRONMENTAL CHARACTERISTICS**  
 OPERATING TEMPERATURE: -65 to +165 DegC

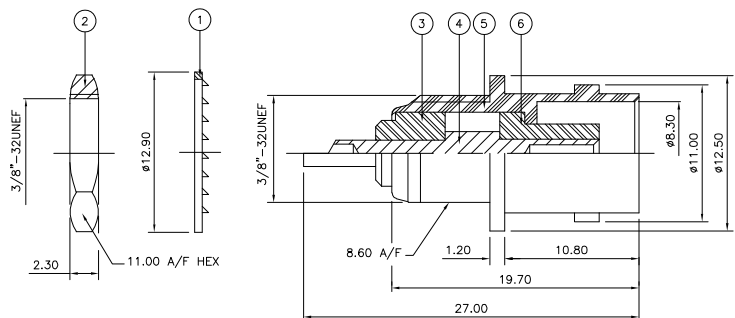

QTY	PER ASSY	MATERIAL	DESCRIPTION	ITEM
1	1	PTFE	INSULATION	6
1	1	BRASS	▲ BODY	5
1	1	BRASS	▲ CONTACT	4
1	1	PTFE	INSULATION	3
1	1	BRASS	▲ HEX NUT	2
1	1	STEEL	▲ LOCKWASHER	1
6--0	1--0	MATERIAL	DESCRIPTION	ITEM

THIS DRAWING IS A CONTROLLED DOCUMENT.		DWN J. SANDWELL 28NOV05	Tyco Electronics Corporation Bideford EX39 4HE	
DIMENSIONS: mm		CHK S. PARLOW 28NOV05		
TOLERANCES UNLESS OTHERWISE SPECIFIED:		APVD F. WHEELER-KING 28NOV05	NAME BNC BULKHEAD SOCKET FRONT MOUNT 50 OHM	
0 PLC ± .05		PRODUCT SPEC 108-3435	SIZE CAGE CODE DRAWING NO RESTRICTED TO	
1 PLC ± .02		APPLICATION SPEC	A3 00779 C=1337449	
2 PLC ± .01		WEIGHT	SCALE NTS SHEET 1 OF 1 REV C	
3 PLC ± .01				
4 PLC ± .01				
5 PLC ± .01				
6 PCC ± .01				
ANGLES ± .01				
MATERIAL SEE TABLE				
FINISH				