

4

3

2

1

THIS DRAWING IS UNPUBLISHED. RELEASED FOR PUBLICATION SEPT, 2005.  
 © COPYRIGHT 2005 BY TYCO ELECTRONICS CORPORATION. ALL RIGHTS RESERVED.

LOC	DIST	REVISIONS			
P	LTR	DESCRIPTION	DATE	DWN	APVD
D		ECR-05-015561	14NOV05	JMS	FWK
E		ECR-08-022547	29AUG08	PK	PB

- NOTES:**
- 1. SINGLE PACK IN ACCORDANCE WITH AMP SPEC 107-3275
  - 2. 100 TRAY PACK IN ACCORDANCE WITH AMP SPEC 107-3275
  - 3. FLASH Au PLATING
  - 4. 0.8µm Au PLATING
  - 5. Ni PLATING
  - 6. THIS ITEM MUST BE WHITE
  - 7. HAND TOOL : 9-1478240-0
  - 8. DIE SET : 9-1478242-0
  - 9. **ELECTRICAL CHARACTERISTICS**
    - FREQUENCY RANGE: DC - 2 GHz
    - NOMINAL IMPEDANCE: 75 Ohm
    - INSULATION RESISTANCE: 5000 MOhm
    - WORKING VOLTAGE: 500 Volts RMS at Sea Level
    - DIELECTRIC WITHSTAND VOLTAGE: 1500 Volts RMS Max
    - CONTACT RESISTANCE: 1.50 mOhm Max
    - CENTRE CONTACT: 0.20 mOhm Max
    - OUTER CONTACT: 1.20 mOhm Max
    - VSWR @ 4GHz: 1.20:1 Max
    - INSERTION LOSS dB @ x 3 GHz: 0.20 Max
  - 10. **MECHANICAL CHARACTERISTICS**
    - COUPLING NUT RETENTION FORCE: 445N Min
    - CABLE RETENTION FORCE: 170N Min
    - DURABILITY: 500 Cycles Min
  - 11. **ENVIRONMENTAL CHARACTERISTICS**
    - OPERATING TEMPERATURE: -65 to +165 DegC

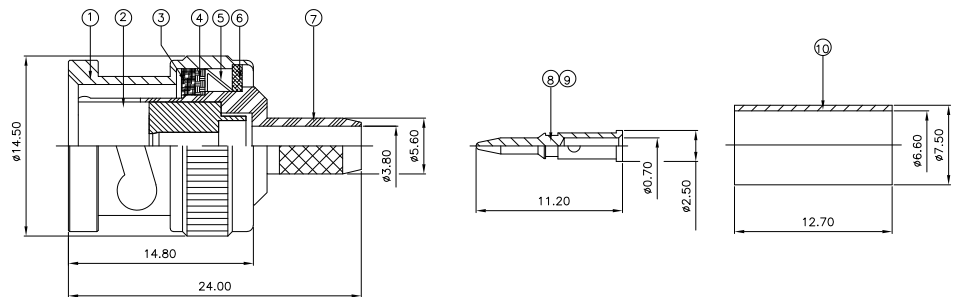

QTY	QTY PER ASSY	PARTS LIST	ITEM
1	1	BRASS	FERRULE 10
1	1	BRASS	CONTACT 9
-	-	BRASS	CONTACT 8
1	1	BRASS	BODY 7
1	1	BRASS	WASHER 6
1	1	SPRING STEEL	SPRING 5
1	1	BRASS	WASHER 4
1	1	SILICON RUBBER	GASKET 3
1	1	PTFE	INSULATION 2
1	1	BRASS	SHELL 1
6--1	1--1	6--0	1--0
△	△	△	△
		MATERIAL	DESCRIPTION
			ITEM

THIS DRAWING IS A CONTROLLED DOCUMENT.

DIMENSIONS: mm	TOLERANCES UNLESS OTHERWISE SPECIFIED:	DWN J. SANDWELL 12SEPT05	CHK S. PARLOW 12SEPT05	Tyco Electronics Tyco Electronics Corporation Bideford, UK, EX39 4HE	
0 PLC ±	1 PLC ±	APVD F. WHEELER-KING 12SEPT05	NAME	BNC STRAIGHT PLUG CRIMP 75 OHM	
2 PLC ±	3 PLC ±	PRODUCT SPEC	108-3435		RESTRICTED TO
4 PLC ±	ANGLES ±	APPLICATION SPEC	SIZE	CAGE CODE	DRAWING NO
MATERIAL	FINISH	WEIGHT	A3	00779	C=1337428
SEE TABLE	SEE TABLE	CUSTOMER DRAWING	SCALE	NTS	SHEET 1 OF 2 REV E

4

3

2

1

THIS DRAWING IS UNPUBLISHED.

RELEASED FOR PUBLICATION SEPT ,2005.

COPYRIGHT 2005 BY TYCO ELECTRONICS CORPORATION. ALL RIGHTS RESERVED.

LOC	DIST	REVISIONS			
P	LTR	DESCRIPTION	DATE	DWN	APVD
E	B	SEE SHEET 1	-	-	-

## ASSEMBLY INSTRUCTION

CABLES: RG59B/U

## STEP 1

1. SLIDE METAL CRIMP FERRULE OVER CABLE

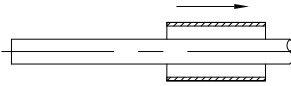

## STEP 2

1. STRIP CABLE TO DIMENSIONS AS SHOWN

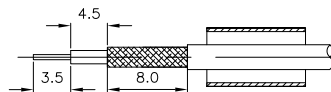

## STEP 3

1. FIT CONTACT OVER CENTRE CONDUCTOR TO BUTT AGAINST DIELECTRIC.
2. CRIMP USING TOOL AS NOTES ON PAGE 1.

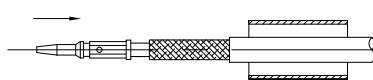
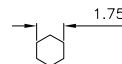
RECOMMENDED CENTRE CONTACT  
A/F HEX

## STEP 4

1. PRESS SUB-ASSEMBLY INTO BODY, UNTIL CONTACT IS FULLY LOCATED BY AN AUDIBLE CLICK.
2. ENSURE THAT KNURLED HOUSING INSERTS BETWEEN THE DIELECTRIC AND CABLE BRAID.

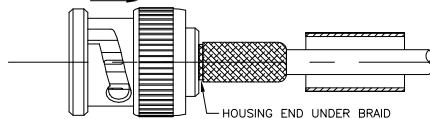

HOUSING END UNDER BRAID

## STEP 5

1. SLIDE CRIMP FERRULE ALONG THE CABLE UNTIL IT BUTTS AGAINST THE HOUSING BODY.
2. CRIMP USING TOOL AS NOTED ON PAGE 1.
3. CRIMP DIMENSION AS SHOWN.

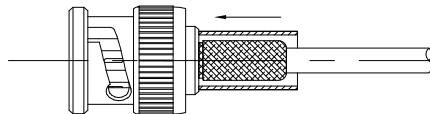

RECOMMENDED CRIMP SLEEVE

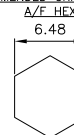

THIS DRAWING IS A CONTROLLED DOCUMENT.

DIMENSIONS:	TOLERANCES UNLESS OTHERWISE SPECIFIED:
mm	
0 PLC	± -
1 PLC	± -
2 PLC	± -
3 PLC	± -
4 PLC	± -
ANGLES	± -
MATERIAL	FINISH
SEE TABLE	SEE TABLE

DWN	J. SANDWELL	12SEPT05
CHK	S. PARLOW	12SEPT05
APVD	E. WHEELER-KING	12SEPT05
NAME	BNC STRAIGHT PLUG CRIMP 75 OHM	
PRODUCT SPEC	RG59B/U, 62A/U, 140/U, 210/U, URM90	
APPLICATION SPEC	KX6A, KX25, KX52, KX53	
WEIGHT	411-3247	
CUSTOMER DRAWING		

Tyco Electronics Corporation		Bideford, UK, EX39 4HE	
SIZE	A3	CAGE CODE	00779
DRAWING NO	1337428		
RESTRICTED TO	-		
SCALE	NTS	SHEET	2 OF 2
REV	E		

AMP 1470-19 REV 31MAR2000