

DRAWING MADE IN THIRD ANGLE PROJECTION
 THIS DRAWING IS UNPUBLISHED. RELEASED FOR PUBLICATION 19
 © COPYRIGHT 19 BY AMP INCORPORATED. ALL INTERNATIONAL RIGHTS RESERVED.

LOC	DIST	P	F	ZONE	LTR	DESCRIPTION	DATE	APPD
AJ	16					REL PER PR 92-3386-100	13/JUL/93	BMW
						REV PER 0220-0218-93	28/OCT/93	BMW
						REV PER 0220-0401-93	11/JAN/94	BMW
						REVISED PER 0503-0860-97	2-12-98	JG
						REVISED PER 0630-0096-98	3-18-98	JG

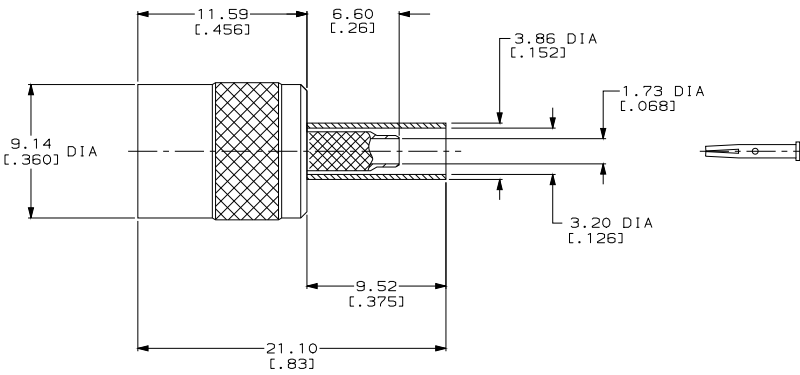

1. MATERIALS:
 BODIES...BRASS PER QQ-B-626
 INNER AND OUTER CONTACTS...
 BERYLLIUM COPPER PER QQ-C-576
 DIELECTRIC...TEFLON PER ASTM D1710
 FERRULE...ANNEALED COPPER PER QQ-C-576
- △ FINISH:
 CENTER CONTACT...GOLD PER MIL-G-45204
 OTHER METAL PARTS...NICKEL PER QQ-N-290
- △ FINISH:
 CENTER AND OUTER CONTACT...GOLD PER MIL-G-45204
 OTHER METAL PARTS...NICKEL PER QQ-N-290

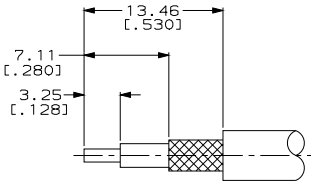

RECOMMENDED STRIP LENGTHS
 SCALE NTS

POSITION LETTER	AMP DIE SET	HEX SIZE	DANIELS DIE SET	SELECTOR NUMBER	DANIELS POSITIONER	NOTES	CABLE	PART NUMBER
B	58483-1	.128	HX4-1637	4	K699	△	RG 179,187	414618-2
B	58483-1	.128	HX4-1637	4	K699	△	RG 179,187	414618-1
AMP PRO-CRIMPER FOR BRAID CRIMP								
M 22520/5-01 FOR BRAID CRIMP								
M 22520/2-01 FOR CONTACT CRIMP								

TOOLING INFORMATION

DO NOT SCALE PRINT. UNLESS SPECIFIED DIMENSIONS IN mm [INCHES] TOLERANCES ON :				PART NO			
2 PLC DEC ± .25 [0.010]				DR 13/JUL/93			
3 PLC DEC ± .13 [0.005]				B. WERNER			
ANGLES ± -				CHK 13/JUL/93			
				J. MCLEOD			
MATERIAL				APPD 13/JUL/93			
SEE NOTES				B. WERNER			
FINISH				PRODUCT SPEC			
SEE NOTES							
APPLICATION SPEC				SIZE		CAGE CODE	
				C		00779	
WEIGHT				DRAWING NO		SHEET	
				C- 414618		1 OF 1	
				SCALE 5:1		CUSTOMER DRAWING	

THIS DRAWING IS A CONTROLLED DOCUMENT FOR AMP INCORPORATED. IT IS SUBJECT TO CHANGE AND THE CONTROLLING ENGINEERING ORGANIZATION SHOULD BE CONTACTED FOR THE LATEST REVISION.

AMP 1471-6 REV 3-92
 19-MAR-98 09:24:14 0000000000000000

414618

A