

4

3

2

1

THIS DRAWING IS UNPUBLISHED. RELEASED FOR PUBLICATION DEC. 2004.
 COPYRIGHT © 2004 BY TYCO ELECTRONICS CORPORATION. ALL RIGHTS RESERVED.

LOC	DIST	REVISIONS	DATE	BY	APP'D
E	B	F LWR			
		D	ECO-09-022031	29 SEP 09	RITA BOB

- NOTES
- 1. SINGLE PACK IN ACCORDANCE WITH AMP SPEC 107-3275
 - 2. 100 TRAY PACK IN ACCORDANCE WITH AMP SPEC 107-3275
 - 3. Au PLATING OVER Ni PLATING OVER Cu PLATING
 - 4. Ni PLATING OVER Cu PLATING
 - 5. HAND TOOL: 9-1478240-0
 - 6. DIE SET: 9-1478242-0
 - 7. FOR TECHNICAL DATA REFER TO YOUR LOCAL TYCO ELECTRONICS SALES OFFICE
 - 8. ALL DIMENSIONS ARE NOMINAL FOR REFERENCE ONLY UNLESS OTHERWISE STATED

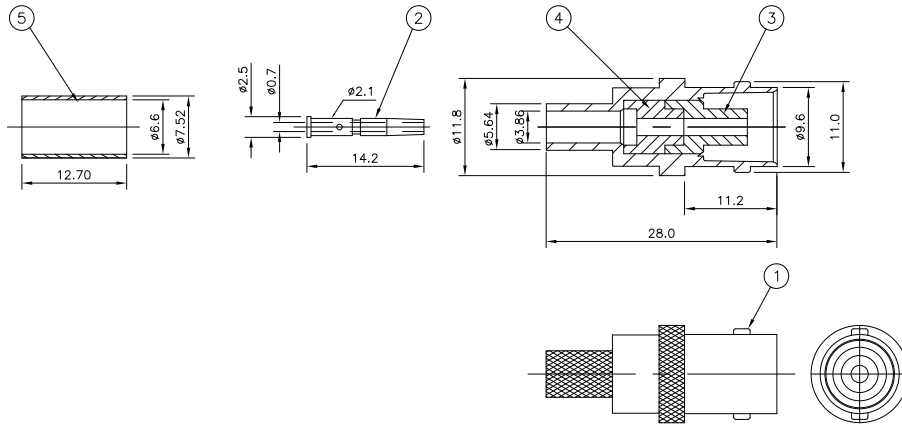

QTY	DESCRIPTION	ITEM
1	BRASS	CRIMP SLEEVE 5
1	POLYMETHYLENE	INSULATOR 4
1	POLYMETHYLENE	INSULATOR 3
1	PHOSPHOR BRONZE	CONTACT 2
1	ZINC ALLOY	BODY 1
8-15-0	MATERIAL	DESCRIPTION ITEM

THIS DRAWING IS A CONTROLLED DOCUMENT.		DRN RITA ZUO 11 Mar 09	Tyco Electronics Corporation	
DIMENSIONS: MM		CHK ANSON MA 11 Mar 09	Kunshan, Jiangsu, PRC 215312	
TOLERANCES UNLESS OTHERWISE SPECIFIED:		APCD BOB ZHAO 11 Mar 09	NAME	
0 PLG	± 0.5	PRODUCT SPEC	108-112000	
1 PLG	± 0.3	APPLICATION SPEC	SEE SHEET 2	
2 PLG	± 0.2	FINISH	SEE TABLE	
3 PLG	± 0.1	MATERIAL	SEE TABLE	
4 PLG	± 0.1	WEIGHT	SEE TABLE	
5 PLG	± 0.1	HEIGHT	SEE TABLE	
6 PLG	± 0.1	WIDTH	SEE TABLE	
7 PLG	± 0.1	DEPTH	SEE TABLE	
8 PLG	± 0.1	DIAMETER	SEE TABLE	
9 PLG	± 0.1	LENGTH	SEE TABLE	
10 PLG	± 0.1	AREA	SEE TABLE	
11 PLG	± 0.1	VOLUME	SEE TABLE	
12 PLG	± 0.1	WEIGHT	SEE TABLE	
13 PLG	± 0.1	WEIGHT	SEE TABLE	
14 PLG	± 0.1	WEIGHT	SEE TABLE	
15 PLG	± 0.1	WEIGHT	SEE TABLE	
16 PLG	± 0.1	WEIGHT	SEE TABLE	
17 PLG	± 0.1	WEIGHT	SEE TABLE	
18 PLG	± 0.1	WEIGHT	SEE TABLE	
19 PLG	± 0.1	WEIGHT	SEE TABLE	
20 PLG	± 0.1	WEIGHT	SEE TABLE	
21 PLG	± 0.1	WEIGHT	SEE TABLE	
22 PLG	± 0.1	WEIGHT	SEE TABLE	
23 PLG	± 0.1	WEIGHT	SEE TABLE	
24 PLG	± 0.1	WEIGHT	SEE TABLE	
25 PLG	± 0.1	WEIGHT	SEE TABLE	
26 PLG	± 0.1	WEIGHT	SEE TABLE	
27 PLG	± 0.1	WEIGHT	SEE TABLE	
28 PLG	± 0.1	WEIGHT	SEE TABLE	
29 PLG	± 0.1	WEIGHT	SEE TABLE	
30 PLG	± 0.1	WEIGHT	SEE TABLE	
31 PLG	± 0.1	WEIGHT	SEE TABLE	
32 PLG	± 0.1	WEIGHT	SEE TABLE	
33 PLG	± 0.1	WEIGHT	SEE TABLE	
34 PLG	± 0.1	WEIGHT	SEE TABLE	
35 PLG	± 0.1	WEIGHT	SEE TABLE	
36 PLG	± 0.1	WEIGHT	SEE TABLE	
37 PLG	± 0.1	WEIGHT	SEE TABLE	
38 PLG	± 0.1	WEIGHT	SEE TABLE	
39 PLG	± 0.1	WEIGHT	SEE TABLE	
40 PLG	± 0.1	WEIGHT	SEE TABLE	
41 PLG	± 0.1	WEIGHT	SEE TABLE	
42 PLG	± 0.1	WEIGHT	SEE TABLE	
43 PLG	± 0.1	WEIGHT	SEE TABLE	
44 PLG	± 0.1	WEIGHT	SEE TABLE	
45 PLG	± 0.1	WEIGHT	SEE TABLE	
46 PLG	± 0.1	WEIGHT	SEE TABLE	
47 PLG	± 0.1	WEIGHT	SEE TABLE	
48 PLG	± 0.1	WEIGHT	SEE TABLE	
49 PLG	± 0.1	WEIGHT	SEE TABLE	
50 PLG	± 0.1	WEIGHT	SEE TABLE	
51 PLG	± 0.1	WEIGHT	SEE TABLE	
52 PLG	± 0.1	WEIGHT	SEE TABLE	
53 PLG	± 0.1	WEIGHT	SEE TABLE	
54 PLG	± 0.1	WEIGHT	SEE TABLE	
55 PLG	± 0.1	WEIGHT	SEE TABLE	
56 PLG	± 0.1	WEIGHT	SEE TABLE	
57 PLG	± 0.1	WEIGHT	SEE TABLE	
58 PLG	± 0.1	WEIGHT	SEE TABLE	
59 PLG	± 0.1	WEIGHT	SEE TABLE	
60 PLG	± 0.1	WEIGHT	SEE TABLE	
61 PLG	± 0.1	WEIGHT	SEE TABLE	
62 PLG	± 0.1	WEIGHT	SEE TABLE	
63 PLG	± 0.1	WEIGHT	SEE TABLE	
64 PLG	± 0.1	WEIGHT	SEE TABLE	
65 PLG	± 0.1	WEIGHT	SEE TABLE	
66 PLG	± 0.1	WEIGHT	SEE TABLE	
67 PLG	± 0.1	WEIGHT	SEE TABLE	
68 PLG	± 0.1	WEIGHT	SEE TABLE	
69 PLG	± 0.1	WEIGHT	SEE TABLE	
70 PLG	± 0.1	WEIGHT	SEE TABLE	
71 PLG	± 0.1	WEIGHT	SEE TABLE	
72 PLG	± 0.1	WEIGHT	SEE TABLE	
73 PLG	± 0.1	WEIGHT	SEE TABLE	
74 PLG	± 0.1	WEIGHT	SEE TABLE	
75 PLG	± 0.1	WEIGHT	SEE TABLE	
76 PLG	± 0.1	WEIGHT	SEE TABLE	
77 PLG	± 0.1	WEIGHT	SEE TABLE	
78 PLG	± 0.1	WEIGHT	SEE TABLE	
79 PLG	± 0.1	WEIGHT	SEE TABLE	
80 PLG	± 0.1	WEIGHT	SEE TABLE	
81 PLG	± 0.1	WEIGHT	SEE TABLE	
82 PLG	± 0.1	WEIGHT	SEE TABLE	
83 PLG	± 0.1	WEIGHT	SEE TABLE	
84 PLG	± 0.1	WEIGHT	SEE TABLE	
85 PLG	± 0.1	WEIGHT	SEE TABLE	
86 PLG	± 0.1	WEIGHT	SEE TABLE	
87 PLG	± 0.1	WEIGHT	SEE TABLE	
88 PLG	± 0.1	WEIGHT	SEE TABLE	
89 PLG	± 0.1	WEIGHT	SEE TABLE	
90 PLG	± 0.1	WEIGHT	SEE TABLE	
91 PLG	± 0.1	WEIGHT	SEE TABLE	
92 PLG	± 0.1	WEIGHT	SEE TABLE	
93 PLG	± 0.1	WEIGHT	SEE TABLE	
94 PLG	± 0.1	WEIGHT	SEE TABLE	
95 PLG	± 0.1	WEIGHT	SEE TABLE	
96 PLG	± 0.1	WEIGHT	SEE TABLE	
97 PLG	± 0.1	WEIGHT	SEE TABLE	
98 PLG	± 0.1	WEIGHT	SEE TABLE	
99 PLG	± 0.1	WEIGHT	SEE TABLE	
100 PLG	± 0.1	WEIGHT	SEE TABLE	

4

3

2

1

THIS DRAWING IS UNPUBLISHED. RELEASED FOR PUBLICATION DEC 2004.
 © COPYRIGHT 2004 BY TYCO ELECTRONICS CORPORATION. ALL RIGHTS RESERVED.

LOC	DIST	REV	DESCRIPTION	DATE	BY	APPD
E	B	F	SEE SHEET 1	-	-	-

COMPONENTS

ITEM NO.	DESCRIPTION	QUANTITY	UNIT
	MAIN BODY (ITEM 1,3, & 4)		
	CONTACT (ITEM 2)		
	CRIMP FERRULES (ITEM 5)		

ASSEMBLY INSTRUCTION

CABLES: RG59B/U, 62A/U, 140/U, 210/U, URM90 KX6A, KX25, KX52, KX53

STEP 1
1. SLIDE METAL CRIMP FERRULE OVER CABLE

STEP 2
1. STRIP CABLE TO DIMENSIONS AS SHOWN

STEP 3
1. FIT CONTACT OVER CENTRE CONDUCTOR TO BUTT AGAINST DIELECTRIC.
2. CRIMP USING TOOL AS NOTES ON PAGE 1.

RECOMMENDED CENTRE CONTACT
A/E HEX
1.75

STEP 4
1. PRESS SUB-ASSEMBLY INTO BODY, UNTIL CONTACT IS FULLY LOCATED BY AN AUDIBLE CLICK.
2. ENSURE THAT KNURLED HOUSING INSERTS BETWEEN THE DIELECTRIC AND CABLE BRAID.

HOUSING END UNDER BRAID

STEP 5
1. SLIDE CRIMP FERRULE ALONG THE CABLE UNTIL IT BUTTS AGAINST THE HOUSING BODY.
2. CRIMP USING TOOL AS NOTED ON PAGE 1.
3. CRIMP DIMENSION AS SHOWN.

RECOMMENDED CRIMP SLEEVE
A/E HEX
6.50

THIS DRAWING IS A CONTROLLED DOCUMENT.

DRW	RITA ZUO	11 Mar 09
CHK	ANSON MA	11 Mar 09
APPD	BOB ZHAO	11 Mar 09

TYCO Electronics Corporation
Kunshan, Jiangsu, PRC 215312

NAME: BNC STRAIGHT JACK CRIMP 75 OHM
 PRODUCT SPEC: RG59B/U, 62A/U, 140/U, 210/U, URM90
 KX6A, KX25, KX52, KX53

108-112000
 APPLICATION SPEC: SHEET 2
 SIZE: A2
 CASE CODE: 00779
 DRAWING ID: C=1634514

MATERIAL: SEE TABLE
 FINISH: SEE TABLE

CUSTOMER DRAWING
 SCALE: NTS
 SHEET: 2 OF 2
 REV: D

1634514

A