

MATERIALS AND FINISHES:

BODY: STAINLESS STEEL
PLATED GOLD (SEE TABLE)

COUPLING NUT: STAINLESS STEEL
PASSIVATED -0031 -0032 -0033
PLATED GOLD (8 u" MIN) -0034

CENTER CONTACT: BRASS
PLATED GOLD (SEE TABLE)

INSULATOR: TEFLON

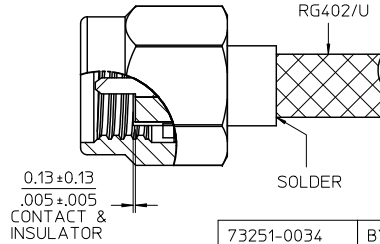
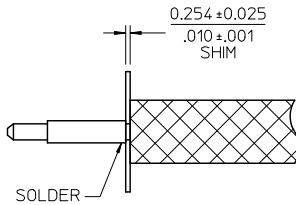
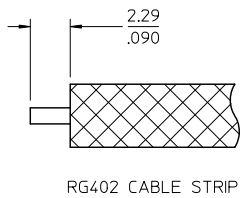
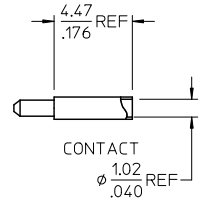
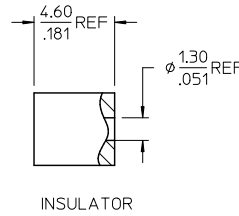
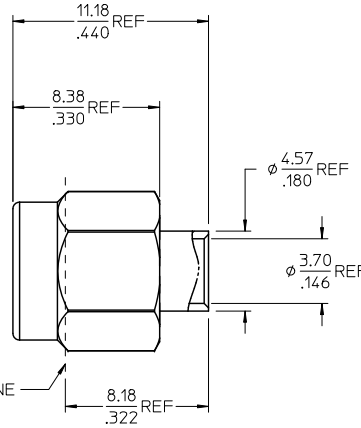
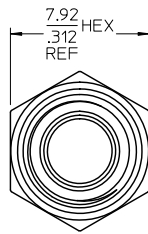
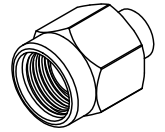

USING CONTACT LOCATOR TOOL 89676-3600,
SLIP CONTACT/CABLE INTO SMA ASSEMBLY
UNTIL BOTTOMS. SOLDER CABLE TO SMA
ASSEMBLY.

USING INSULATOR INSERTION TOOL 89676-3100
PRESS INSULATOR TO DIMENSION SHOWN.

| | |
|--------------------------|-----------------------|
| PS-89675-346 | ELECTRO/MECH PERFORM. |
| MIL-STD-348A, FIG. 310.1 | INTERFACE |
| SPECIFICATION | DESCRIPTION |

| | | | |
|------------|------------------|----------------|----------------|
| 73251-0034 | BY TRAY | 8 MICROINCHES | 8 MICROINCHES |
| 73251-0033 | BY BAG | 30 MICROINCHES | 30 MICROINCHES |
| 73251-0032 | BY TRAY (20 CAV) | 10 MICROINCHES | 30 MICROINCHES |
| 73251-0031 | BY BAG | 10 MICROINCHES | 30 MICROINCHES |
| PART NO. | PACKAGING | FINISH BODY | FINISH CONTACT |

| | |
|---------------------------|---------------------------------------|
| CHG: ADDED -0034 | QUALITY SYMBOLS |
| EC NO: URF2011-0594 | GENERAL TOLERANCES (UNLESS SPECIFIED) |
| DRW: ROBERTSON 2011/04/08 | 4 PLACES ± .005 ± .005 |
| CHKD: JTL 2011/04/08 | 3 PLACES ± .005 ± .005 |
| APPR: JMWENER 2011/04/11 | 2 PLACES ± .005 ± .005 |
| | 1 PLACE ± .005 ± .005 |
| | ANGULAR ± 1 ° |
| | THIRD ANGLE PROJECTION |

| | | | | |
|-------------|-----------------|--------------|--------------------------|------------------------|
| DESCRIPTION | DIMENSION STYLE | SCALE | DESIGN UNITS | THIRD ANGLE PROJECTION |
| | MM/IN | | METRIC | |
| | DRAWN BY | DATE | TITLE | |
| | NBJ | 1997/12/01 | SMA PLUG, SOLDER TYPE | |
| | CHECKED BY | DATE | FOR RG402 CABLE, 50 OHMS | |
| | DHG | 1998/01/05 | SMA-PC, EWR-1980 | |
| | APPROVED BY | DATE | MOLEX INCORPORATED | |
| | GMH | 1998/01/06 | | |
| | MATERIAL NO. | DOCUMENT NO. | SHEET NO. | |
| | SEE TABLE | SD-73251-003 | 1 OF 1 | |

| | | | | |
|-------------------------------|------|---|--|--|
| DRAFT WHERE APPLICABLE | SIZE | THIS DRAWING CONTAINS INFORMATION THAT IS PROPRIETARY TO MOLEX INCORPORATED AND SHOULD NOT BE USED WITHOUT WRITTEN PERMISSION | | |
| MUST REMAIN WITHIN DIMENSIONS | C | | | |