

REV.	DATE	DESCRIPTION
A	01/25/04	UPDATE DRAWING FORMAT
B	12/31/05	MODIFY PART DESCRIPTION TO "COUPLING NUT"

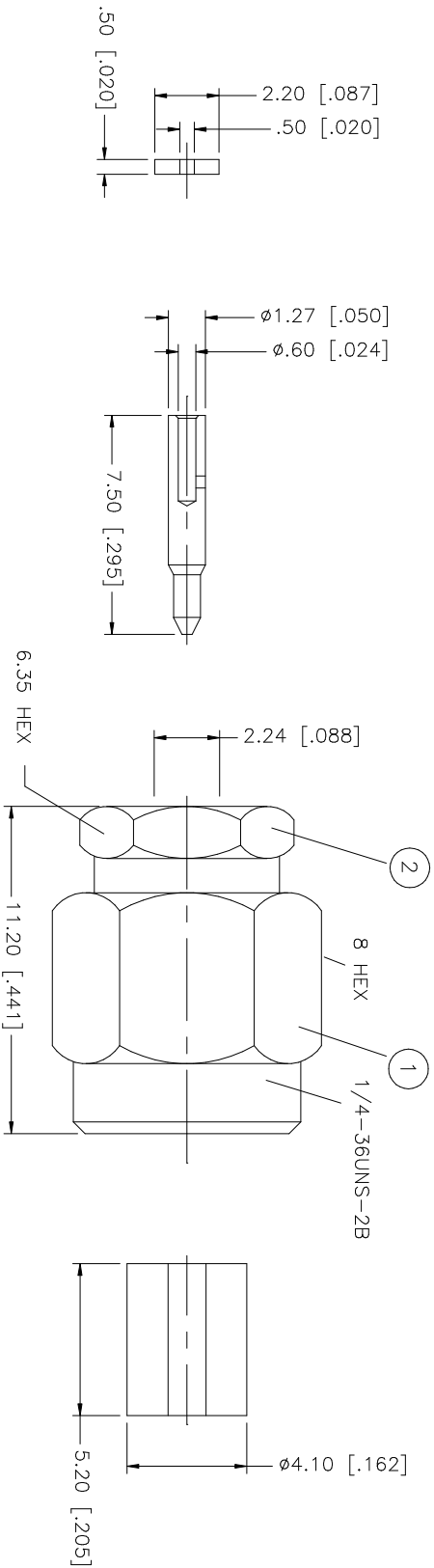
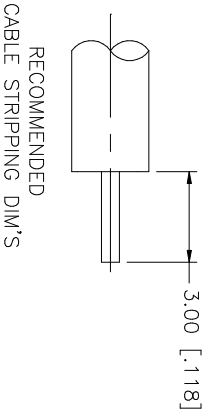

1. CONTACT PIN TO SOLDER

QTY	FINISH	MATERIAL	DESCRIPTION
1	PASSIVATED S.S.	STAINLESS STEEL	COUPLING NUT
1	GOLD	BRASS	BODY
1	NATURAL	TEFLON	INSULATOR
1	GOLD	BRASS	CONTACT PIN
1	RED	SILICONE	GASKET
1	NATURAL	BER. COPPER	RETAINER RING

APPROVALS	DATE
DRAWN G.R.S.	12/31/05
CHECKED	
ISSUED	
SHEET 1 OF 1	

PART DESCRIPTION	PART NO.
SMA DIRECT SOLDER PLUG (FOR .085", .086" CABLE)	132188

UNLESS OTHERWISE SPECIFIED DIMENSIONS ARE IN INCHES AND FOR CUSTOMER REFERENCE ONLY.
TOLERANCES FOR MILLING ARE: 0.5 - 8mm ± 0.20mm 8 - 30mm ± 0.40mm 30 - 120mm ± 0.50mm
TOLERANCES FOR FINISH ARE: UNLESS OTHERWISE SPECIFIED .020 - .315 = ± 0.007" .315 - 1.180 = ± 0.015" 1.180 - 4.724 = ± 0.020"

DO NOT SCALE DRAWING
CAD FILE C:/132/132188.DWG

DWG. NO.	REV.	SIZE	SCALE
132188.DWG	B	A	NA

Amphenol Connex

SMA DIRECT SOLDER PLUG
(FOR .085", .086" CABLE)

132188