

NOTES:

1. PACKAGED IN BAG.
2. USE AMPHENOL CRIMP TOOL #CTL-2.
3. CAPTIVATED CONTACT, .043 WIRE ENTRY.
4. 3 PC. (BODY, FERRULE, CONTACT).
5. MATERIALS OF CONSTRUCTION:
 FERRULE(S):
 COPPER ALLOY
 NICKEL PLATED
 CONTACT PIN:
 BRASS
 GOLD PLATED
 RETAINER RING,
 BODY, WASHER:
 BRASS
 NICKEL PLATED
 INSULATOR:
 DELRIN
 NATURAL
 GASKET:
 RUBBER
 RED
 SHELL:
 ZINC DIECAST
 NICKEL PLATED
 SPRING:
 COPPER ALLOY
 NICKEL PLATED
6. DO NOT SCALE THIS DRAWING.

31-71000-RFX		REVISIONS			
DRAWING NO.	REV	DESCRIPTION	DATE	ECD	APPR
THIRD ANGLE PROJ.	A	RELEASE TO MFG.			
	C	REDRAWN, WAS 'C' SIZE; UPDATED DRAWING.		42543	TV/
	D	SEE SHEET 1	11/11/98	42712	CPM/
	E	SEE SHEET 1	12/7/98	42779	CPM/

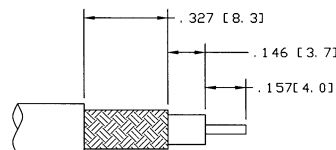

RECOMMENDED CABLE STRIPPING DIM'S

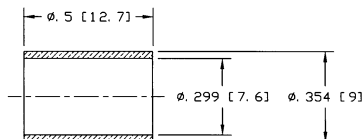
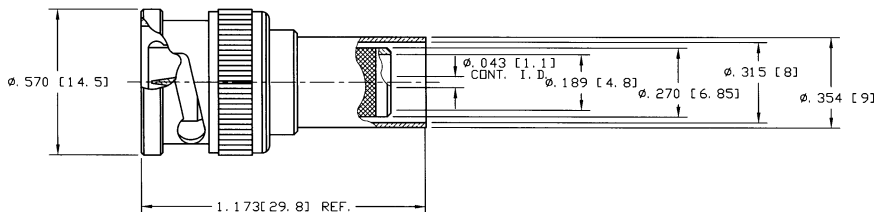

CUSTOMER OUTLINE DRAWING

ENGLISH METRIC

UNLESS OTHERWISE SPECIFIED, DIMENSIONS ARE IN INCHES AND TOLERANCES ARE: 2 PLACE DECIMAL ±.015 (0.381 mm) 3 PLACE DECIMAL ±.005 (0.127 mm) ANGLES ±1°	MATERIAL	DRAWN T. VERHOEVEN	DATE 6/17/98	TITLE BNC CRIMP CRIMP PLUG FOR BELDEN 9248, RG6 CABLE, 75 OHM	Amphenol Amphenol Corporation RF/Microwave Operations Danbury, Conn. U.S.A. 06810			
	NOTICE - These drawings, specifications, or other data (1) are, and remain the property of Amphenol Corp. (2) must be returned upon request; and (3) are confidential and not to be disclosed to any person other than those to whom they are given by Amphenol Corp. The furnishing of these drawings, specifications, or other data by Amphenol Corp. or to any other person for any purpose is not to be regarded by implication or otherwise in any manner licensing, granting rights or permitting such holder or any other person to manufacture, use or sell any product, process or design, patented or otherwise, that may in any way be related to or disclosed by said drawings, specifications, or other data.	REFERENCE EAR 962370 EAR 967010-0 EAR 967127-0	ENGINEER T. AUBIN	DATE		SCALE: 2:1 SHEET 2 OF 2		
		APPROVED T. AUBIN	DATE	CAD FILE H:\DEPT611\BNC\031\ASSY\71000\RFXSH2	CODE ID 74868	DWG SIZE B	DRAWING NO. 31-71000-RFX	ISSUE E