

REV.	DATE	DESCRIPTION
A	03/06/05	MODIFY PLATING SPECS.
B	10/27/05	MODIFY PLATING SPECS. TO BRT. TIN
C	03/16/06	CHANGE CABLE DESCRIPTION TO RG 179/U

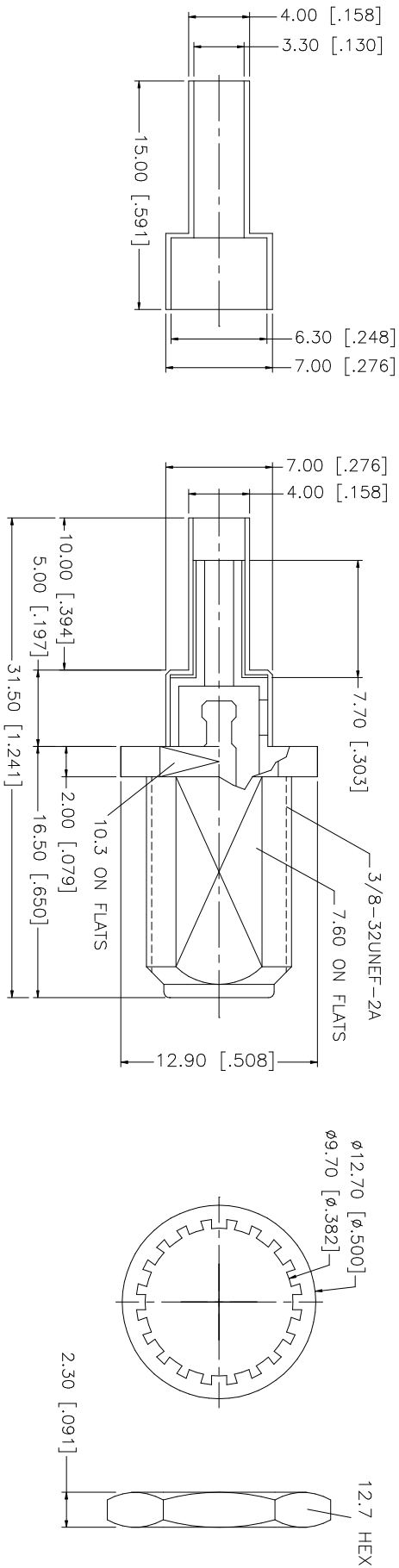
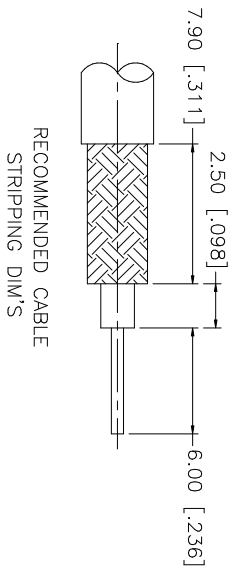

CRIMP NOTES:

1. CRIMPED FERRULE
HEX CRIMP SIZE .128"
2. CONTACT PIN TO SOLDER
3. MAX. PANEL THICKNESS = 4.5mm

QTY	FINISH	MATERIAL	DESCRIPTION
1	BRT. TIN	BRASS	FERRULE
1	BRT. TIN	BRASS	HEX NUT
1	BRT. TIN	BRASS	LOCK WASHER
1	NATURAL	P.P.	INSULATOR
1	BRT-TIN	BRASS	CONTACT PIN
1	NATURAL	P.P.	INSULATOR
1	BRT. TIN	BRASS	HOUSING/BODY
			DESCRIPTION

APPROVALS	DATE
DRAWN G.R.S.	03/16/06
CHECKED	
ISSUED	
SHEET 1 OF 1	

UNLESS OTHERWISE SPECIFIED DIMENSIONS ARE INCHES AND FOR CUSTOMER REFERENCE ONLY.	UNLESS OTHERWISE SPECIFIED TOLERANCES FOR MILLIMETERS ARE:	UNLESS OTHERWISE SPECIFIED DIMENSIONS ARE INCHES AND FOR CUSTOMER REFERENCE ONLY.	UNLESS OTHERWISE SPECIFIED TOLERANCES FOR INCHES ARE:
0.5 - 8mm ± 0.20mm	30 - 120mm ± 0.50mm	.020 - .315 = ± 0.007"	.315 - 1.180 = ± 0.015"
8 - 30mm ± 0.40mm		1.180 - 4.724 = ± 0.020"	

CAD FILE	DWG. NO.	REV.	SIZE	SCALE
C:/222/222114-10.DWG	222114-10.DWG	C	A	NA

PART DESCRIPTION	PART NO.
F BULKHEAD CRIMP JACK (FOR RG179/U WITH NUT AND WASHER)	222114-10

Amphenol Connex