

NOTES:

- 1. MATERIALS OF CONSTRUCTION:
- BODY, & SHELL = BRASS, GOLD PLATED
- CONTACT PIN = BRASS, GOLD PLATED
- INSULATORS (2) = TEFLON, MIL-P-1946B
- RETAINER RING = B2Cu, NATURAL
- GASKET = SILICONE RUBBER, COLOR RED

901-9867-RFX		REVISIONS			
DRAWING NO.	REV	DESCRIPTION	DATE	ECO	APPR
THIRD ANGLE PROJ.	A	RELEASE TO MFG.	2/2/01	43661	CFM

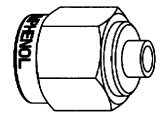

SCALE 3.000

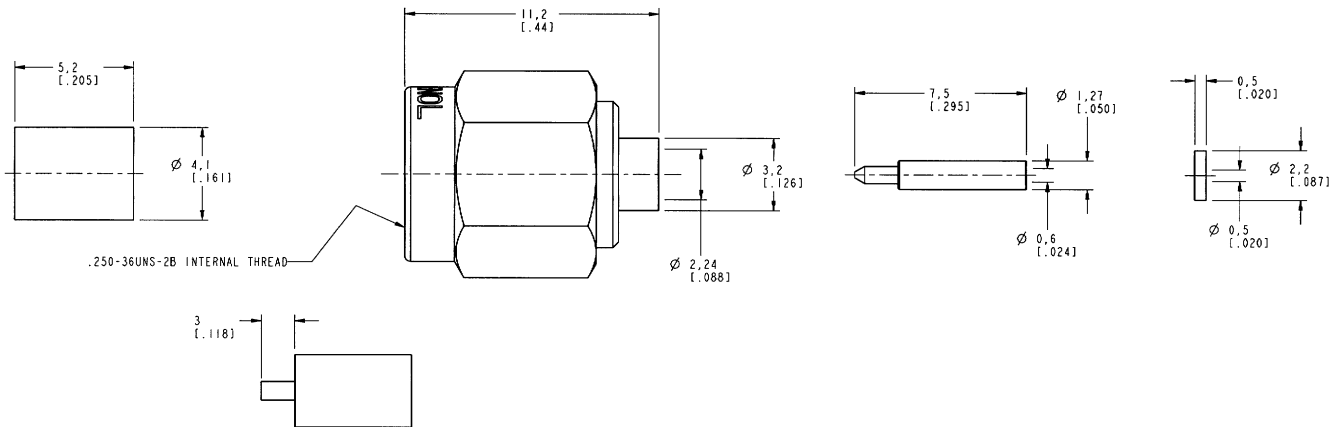

.250-36UNS-2B INTERNAL THREAD

RECOMMENDED CABLE STRIPPING DIMENSIONS
SCALE 3.000

CUSTOMER OUTLINE DRAWING
FOR REFERENCE ONLY

UNLESS OTHERWISE SPECIFIED, DIMENSIONS ARE IN INCHES AND TOLERANCES ARE: 0.5 - 6mm ±0.2mm 6 - 30mm ±0.4mm 30 - 120mm ±0.6mm	MATERIAL	DRAWN	DATE	TITLE	Amphenol Amphenol Corporation Communication and Network Products Division Danbury, CT U.S.A. 06810
		C. McGRATH	1/24/01	SMA SOLDER PLUG FOR .085 & .086 DIA SEMI-RIGID CABLE	
NOTICE - These drawings, specifications, or other data (1) are, and remain the property of Amphenol Corp. (2) must be returned upon request; and (3) are confidential and not to be disclosed to any person other than those to whom they are given by Amphenol Corp. The furnishing of these drawings, specifications, or other data by Amphenol Corp., or to any other person to anyone for any purpose is not to be regarded by implication or otherwise in any manner licensing, granting rights or permitting such holder or any other person to manufacture, use or sell any product, process or design, patented or otherwise, that may in any way be related to or disclosed by said drawings, specifications, or other data.	REFERENCE EAR 967698-0 GENB 901-9868-RFX.ASSY	ENGINEER	DATE	SCALE: 6.0:1 SHEET 2 OF 2	
		O. BARTHELMES	1/24/01	CODE ID	DWG SIZE
		APPROVED	DATE	DRAWING NO.	REV
		<i>[Signature]</i>	1/2/01	901-9867-RFX	A
		CAD FILE			
		1:LSMA\901-9867-RFX			