

THIS DRAWING IS UNPUBLISHED. RECEIVED FOR REVISION
 © 2004 METRIC INC. IN THE ELECTRONICS CORPORATION. ALL RIGHTS RESERVED.

REV	DATE	DESCRIPTION	BY	CHK	APP
AJ	16				
R		REV PER EC 0514-200-04			11/2/04

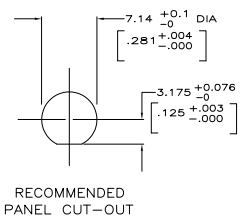
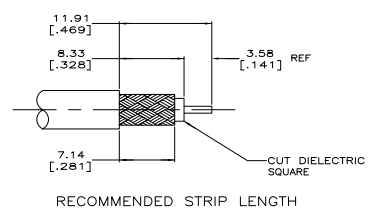
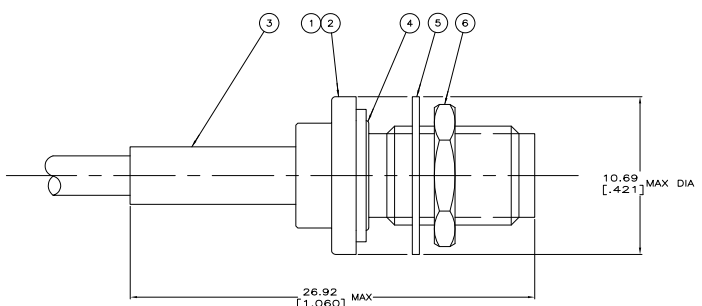

1. STEEL STAMP
2. PARTS PACKAGED UNASSEMBLED.
3. SEE INSTRUCTION SHEET NO. 408-2322.

220061-1	RG-174/U,188A/U & 316/U	2-332004-0	1-22145-3	226315-1	9-50285-0	448180-3	225549-2	9-225608-0	
OBSELETE	59982-1	RG-316	2-332004-0	1-22145-3	226315-1	50285-5	225546-2	225549-2	
OBSELETE	220061-1	RG-141/U,141A/U & 303/U	2-332004-0	1-22145-3	226315-1	225619-2	225546-1	225549-1	
	220061-1	RG-179B/U & 187A/U	2-332004-0	1-22145-3	226315-1	50285-7	225546-2	225549-3	
	220061-1	RG-174/U,188A/U & 316/U	2-332004-0	1-22145-3	226315-1	9-50285-0	448180-3	225549-2	
OBSELETE	220061-1	RG-142/U,142A/U & 142B/U	2-332004-0	1-22145-3	226315-1	225618-3	225546-1	225549-1	
OBSELETE	220061-1	RG-58A/U & 58C/U	2-332004-0	1-22145-3	226315-1	225619-2	225546-1	225549-1	
	HAND TOOL	CABLE SIZE	⑥ JAM NUT QTY=1	⑤ LOCKWASHER QTY=1	④ O-RING QTY=1	③ FERRULE QTY=1	② CONTACT QTY=1	① BULKHEAD JACK ASSY QTY=1	ASSY NO

THIS DRAWING IS A CONTROLLED DOCUMENT.

DESIGNED BY: J. MCGREGOR
 DRAWN BY: E. BULLI
 CHECKED BY: D. VERMEERSCHE
 DATE: 11/2/04

REVISED BY: []
 DATE: []

ISSUED BY: []
 DATE: []

APPROVED BY: []
 DATE: []

DATE: 11/2/04
 DRAWING NO: A100779
 Q=225608

CUSTOMER DRAWING

METRIC
 The Electronics Corporation
 Harrisburg, PA 17105-3608

JACK, BULKHEAD, SERIES SMA

SIZE: 4.1
 SHEET: 1 of 1
 REV: R