

DRAWING MADE IN THIRD ANGLE PROJECTION  
 THIS DRAWING IS UNPUBLISHED. RELEASED FOR PUBLICATION  
 © COPYRIGHT 19 BY AMP INCORPORATED. ALL INTERNATIONAL RIGHTS RESERVED.

LOC		DIST		REVISIONS				DATE	APPD
P	F	ZONE	LTR	DESCRIPTION					
AJ	16			F	OBS -6 PER OE10-0116-99		04FEB00	MO	
				F1	REVISED PER ECO-10-000030		04JAN10	AEG	

- PARTS PACKAGED UNASSEMBLED.
- THREE SAFETY WIRE HOLES  $\phi 0.61$  [.024] MIN, EQUALLY SPACED AROUND CIRCUMFERENCE.
- CRIMP TOOL: 220045-2
- SEE I.S. 2028-1
- BULK PACKAGED VERSION OF 225361-6

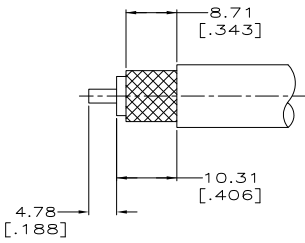

RECOMMENDED STRIP LENGTH  
(SCALE 2:1)

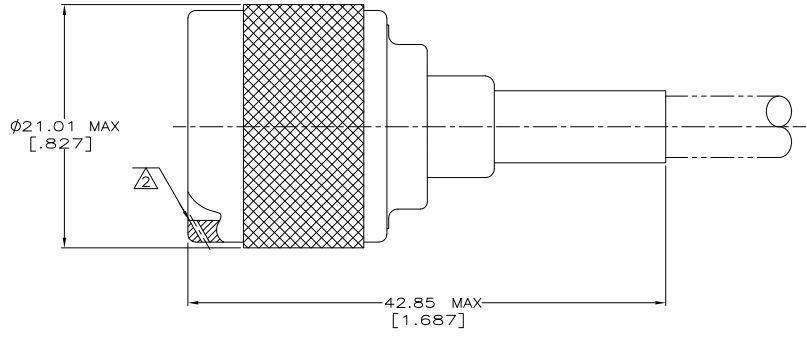

<del>OBSOLETE</del>	RG-142/U,142A/U & 142B/U	225382-3	225343-4	225342-3	225361-7
<del>OBSOLETE</del>	RG-142/U,142A/U & 142B/U	225382-3	225343-4	225342-3	225361-6
	RG-142/U,142A/U & 142B/U	225382-2	225343-4	225342-1	225361-4
	RG-55A/U & 223/U	225382-2	225343-2	225342-1	225361-2
	RG-58A/U & 58C/U	225381-2	225343-2	225342-1	225361-1

CABLE SIZE	③ FERRULE QTY=1	② CONTACT QTY=1	① PLUG ASSY QTY=1	PART NUMBER
------------	--------------------	--------------------	----------------------	-------------

DO NOT SCALE PRINT. UNLESS SPECIFIED DIMENSIONS IN mm [INCHES] TOLERANCES ON : 2 PLC DEC ± 0.41 [.016] 3 PLC DEC ± - ANGLES ± -		DR 06-06-91 B. SCOTT	AMP Incorporated Harrisburg, PA 17105-3608	
MATERIAL	APPD 1-9-92 M. SNEED	CHK 1-3-92 B. MOYER	NAME PLUG, SERIES N	
FINISH	APPD 1-9-92 M. SNEED	PRODUCT SPEC	SIZE C 00779	DRAWING NO 225361
	APPLICATION SPEC	WEIGHT 1.2 OZ MAX	SCALE 4:1	SHEET 1 OF 1

225361

A

D

C

B

A

D

C

B

A

D

C

B

A

D

C

B

A

D

C

B

A

D

C

B

A

D

C

B

A

D

C

B

A

D

C

B

A

D

C

B

A

D

C

B

A

D

C

B

A

D

C

B

A

D

C

B

A

D

C

B

A

D

C

B

A

D

C

B

A

D

C

B

A

D

C

B

A

D

C

B

A

D

C

B

A

D

C

B

A

D

C

B

A

D

C

B

A

D

C

B

A

D

C

B

A

D

C

B

A

D

C

B

A

D

C

B

A

D

C

B

A

D

C

B

A

D

C

B

A

D

C

B

A

D

C

B

A

D

C

B

A

D

C

B

A

D

C

B

A

D

C

B

A

D

C

B

A

D

C

B

A

D

C

B

A

D

C

B

A

D

C

B

A

D

C

B

A

D

C

B

A

D

C

B

A

D

C

B

A

D

C

B

A

D

C

B

A

D

C

B

A

D

C

B

A

D

C

B

A

D

C

B

A

D

C

B

A

D

C

B

A

D

C

B

A

D

C

B

A

D

C

B

A

D

C

B

A

D

C

B

A

D

C

B

A

D

C

B

A

D

C

B

A

D

C

B

A

D

C

B

A

D

C

B

A

D

C

B

A

D

C

B

A

D

C

B

A

D

C