

REV	DATE	DESCRIPTION	BY	CHK	APP
16					
0		REV PER EC-0514-0406-04	31JAN2005	AF	-
01		REVISED PER ECO-09-024608	31OCT09	KK	AEG

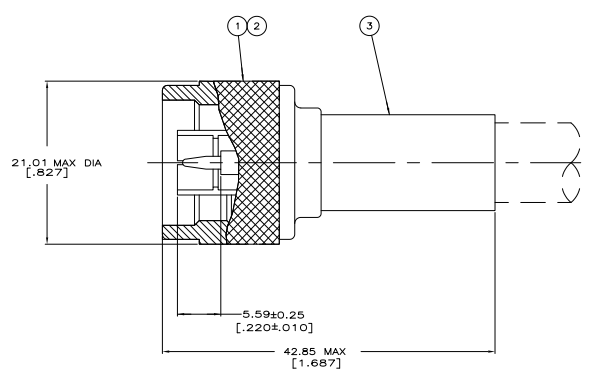

- 1. SEE I.S. 2028-1
- △ SEE SEPERATE RESTRICTED CUSTOMER DRAWING
- △ OBSOLETE PARTS: OBSOLETE CIS STREAMLINING PER D.RENAUD/D.SINISI

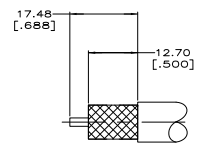

DETAIL A
SCALE 2:1

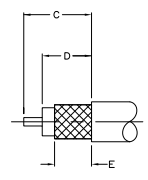

DETAIL B
SCALE 2:1

RECOMMENDED STRIP LENGTH

CABLE	CRIMPING TOOL	E	D	C	DETAIL	FERRULE QTY=1	CONTACT QTY=1	PLUG ASSY QTY=1	PART NUMBER
OBSELETE									
BELDEN 8214	220015-1	9.53 [.375]	12.70 [.500]	17.45 [.687]	B	9-51713-0	1-51695-2	51701-6	1-5225661-9
RC-55A & 223	220045-2	8.71 [.343]	10.31 [.406]	15.09 [.594]	B	9-225382-0	225343-2	225342-3	1-5225661-6
RC-58A/U & 58C/U	220045-2	8.71 [.343]	10.31 [.406]	15.09 [.594]	B	9-225381-0	225343-2	225342-3	1-5225661-3
RC-213/U	220015-1	9.53 [.375]	12.70 [.500]	17.45 [.687]	B	9-51713-0	2-51695-1	51701-6	1-5225661-2
RC-9/U & 214/U	220015-1	9.53 [.375]	12.70 [.500]	17.45 [.687]	A	9-51713-0	2-51695-1	51701-6	5225661-1

THIS DRAWING IS A CONTROLLED DOCUMENT.

APPROVED BY: MICHAEL J. HAVENER

DATE: 00779

PLUG, SERIES N

CUSTOMER DRAWING

DATE: 4.1

REV: 1

OF: 01