

4

3

2

1

THIS DRAWING IS UNPUBLISHED. RELEASED FOR PUBLICATION
 BY TYCO ELECTRONICS CORPORATION. ALL RIGHTS RESERVED.

LOC	DIST	REVISIONS				
		F	LR	DATE	DW	APD
AJ	16	B		REVISED PER ECO 07-002853	21MAR2007	JL

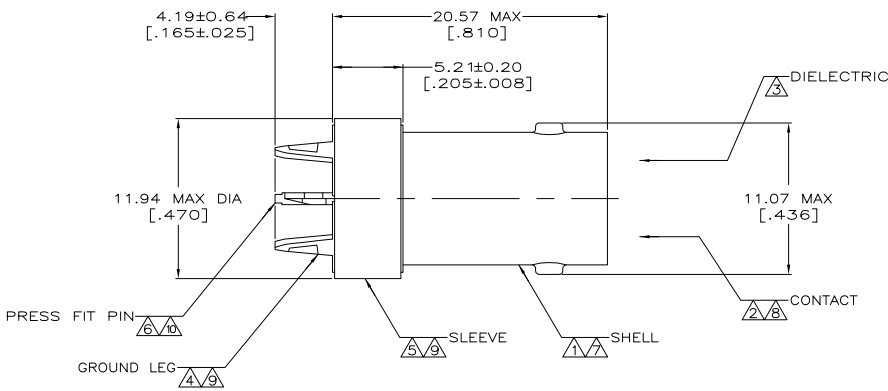

- △ ZINC PER QQ-Z-363.
- △ BERYLLIUM COPPER PER ASTM-B-643
- △ PTFE PER MIL-P-19468.
- △ COPPER-IRON ALLOY PER ASTM-B-465.
- △ COPPER PER QQ-C-576.
- △ COPPER ALLOY PER ASTM-B-122.
- △ NICKEL PLATE PER QQ-N-290
3.81µm [.000150] MINIMUM THICK.
- △ GOLD PLATE PER MIL-G-45204
0.76µm [.000030] MINIMUM THICK.
- △ TIN PLATE PER ASTM-B-545,
2.54 µm [.000100] MIN THICK.
- △ 10 GOLD PLATE PER MIL-G-45204

11 CONNECTOR PRESS FIT IS DESIGNED TO PROVIDE 100 LB. MINIMUM AXIAL RETENTION TO PCB COMPLIANT WITH TYCO APPLICATION SPEC 114-12001. AS A RESULT, DEFORMATION OF PLATED THROUGH HOLES WILL OCCUR. CUSTOMER VALIDATION AND ACCEPTANCE OF THIS DEFORMATION IS RECOMMENDED PRIOR TO SPECIFYING USE OF THIS PRODUCT.

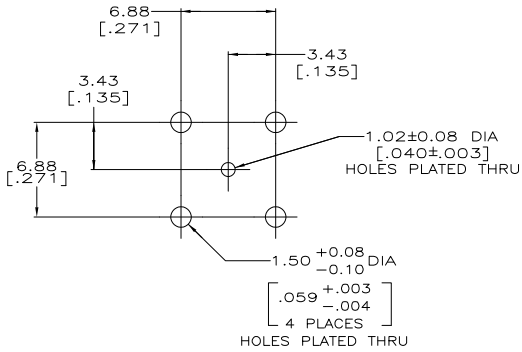

PCB CONFIGURATION

5222006-1
 PART NUMBER

THIS DRAWING IS A CONTROLLED DOCUMENT.		DW J. ALCORTA 21APR2005	Tyco Electronics Corporation Harrisburg, Pa 17105-3608	
DIMENSIONS: mm [INCHES]		CHK J. HAVENER 21APR2005	NAME J. LIPPERT	
TOLERANCES UNLESS OTHERWISE SPECIFIED:		APPC J. LIPPERT 21APR2005	PRODUCT SPEC 108-12103	
0 PLG ± -	1 PLG ± -	APPLICATION SPEC 114-12001		
2 PLG ± 0.05 (0.02)	3 PLG ± -	SIZE CASE CODE DRAWING NO A2 00779 C=5222006		
4 PLG ± -	ANGLES ± -	RESTRICTED TO -		
MATERIAL SEE NOTES 1-6		FINISH SEE NOTES 7-10		
CUSTOMER DRAWING		SCALE 5:1 SHEET 1 OF 1 REV B		

AMP 1471-9 REV 31MAR2000

5222006

A