

4

3

2

1

THIS DRAWING IS UNPUBLISHED. RELEASED FOR PUBLICATION AUGUST, 2005.
 © COPYRIGHT 2005 BY TYCO ELECTRONICS CORPORATION. ALL RIGHTS RESERVED.

| LOC | | DIST | | REVISIONS | | | |
|-----|-----|---------------|--|-----------|------|------|--|
| P | LTR | DESCRIPTION | | DATE | DWN | APVD | |
| B | | ECO-09-003420 | | 24 Feb 09 | RITA | BOB | |

- NOTES**
- 1. 100 TRAY PACK IN ACCORDANCE WITH AMP SPEC 107-3275
 - 2. SINGLE PACK IN ACCORDANCE WITH AMP SPEC 107-3275
 - 3. Au PLATING OVER Ni PLATING OVER Cu PLATING
 - 4. Ni PLATING OVER Cu PLATING
 - 5. FOR TECHNICAL DATA REFER TO YOUR LOCAL TYCO ELECTRONICS SALES OFFICE
 - 6. ALL DIMENSIONS ARE NOMINAL FOR REFERENCE ONLY UNLESS OTHERWISE STATED

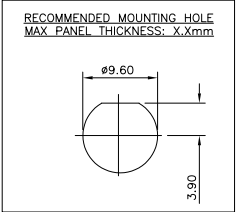
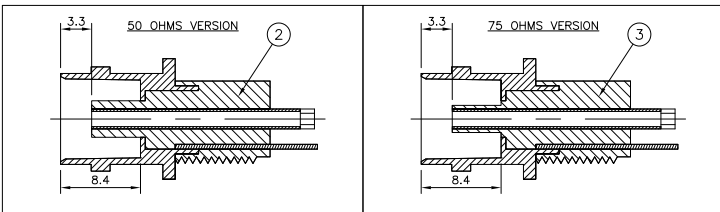
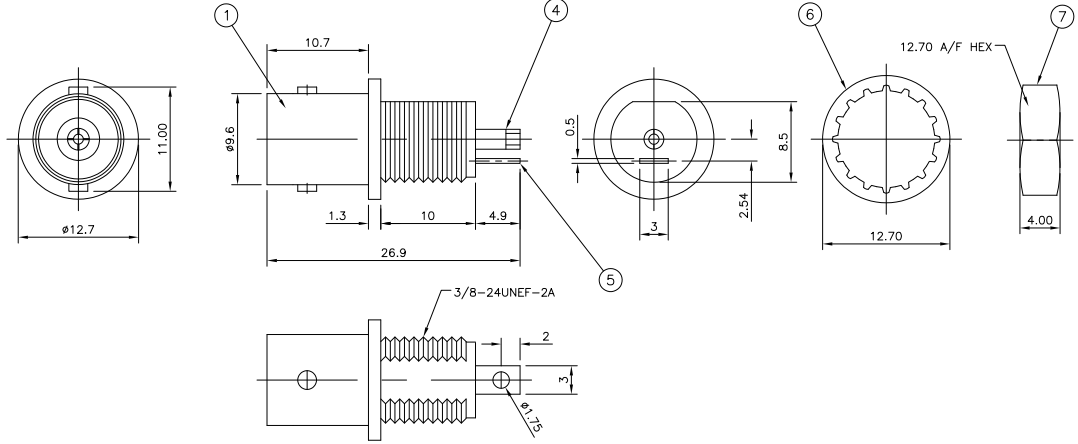

| QTY | UNIT | MATERIAL | DESCRIPTION | ITEM | | | |
|------|------|----------|-------------|------|---------------|-------------|------|
| 1 | 1 | 1 | 1 | 1 | BRASS | HEX NUT | 7 |
| 1 | 1 | 1 | 1 | 1 | STEEL | LOCK WASHER | 6 |
| 1 | 1 | 1 | 1 | 1 | BRASS | GROUND TAG | 5 |
| 1 | 1 | 1 | 1 | 1 | PHOS BRONZE | CONTACT | 4 |
| 1 | 1 | - | - | - | PBT POLYESTER | INSULATOR | 3 |
| - | - | 1 | 1 | 1 | PBT POLYESTER | INSULATOR | 2 |
| 1 | 1 | 1 | 1 | 1 | ZINC ALLOY | BODY | 1 |
| 5--3 | 5--2 | 5--1 | 5--0 | | MATERIAL | DESCRIPTION | ITEM |

THIS DRAWING IS A CONTROLLED DOCUMENT.

| | | | | | | | | | |
|-----------------------|---|--|-------------------------------|-------------------------------|---|------------|--------------------|-----------------------|--------------------|
| DIMENSIONS: MM | TOLERANCES UNLESS OTHERWISE SPECIFIED: 0 PLC ± 0.5 1 PLC ± 0.3 2 PLC ± 0.2 3 PLC ± - 4 PLC ± - ANGLES ± - | DWN RITA ZUO 24 Feb 09 | APVD ANSON MA 24 Feb 09 | APVD BOB ZHAO 24 Feb 09 | NAME BOB ZHAO | SIZE A3 | CAGE CODE 00779 | DRAWING NO 1634504 | RESTRICTED TO - |
| MATERIAL SEE TABLE | FINISH SEE TABLE | Tyco Electronics Corporation Kunshan, Jiangsu, PRC 215312 | | | BNC INSULATED BULKHEAD SOCKET FRONT MOUNT | | SCALE NTS | | |
| CUSTOMER DRAWING | | SHEET 1 OF 1 | | REV B | | | | | |