

DRAWING MADE IN THIRD ANGLE PROJECTION

THIS DRAWING IS UNPUBLISHED. RELEASED FOR PUBLICATION, 19 .  
 © COPYRIGHT 19 BY AMP INCORPORATED. ALL INTERNATIONAL RIGHTS RESERVED.

LOC	DIST	P	F	ZONE	LTR	DESCRIPTION	DATE	APPD
FT	4							
				0		RLSE PER NPR 5254 WAS 94-5029-029-01	01/04/95	AF
				A		REV PER EC 0020-68-95	02/08/95	AF
				B		REV PER EC 0320-7-97	16 JAN 97	KD

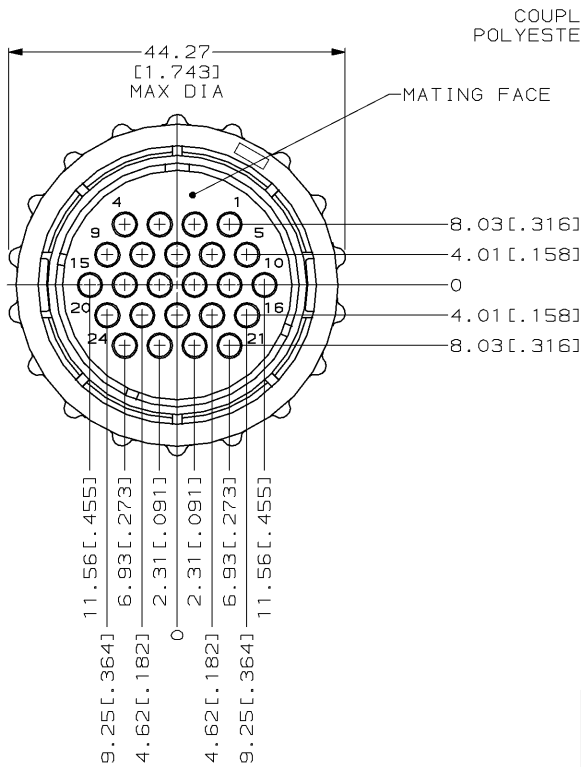

COUPLING RING  
POLYESTER, BLACK

AMP & PART NO  
ON THIS DIA

PLUG HOUSING  
NYLON 6/6,  
GLASS FILLED,  
BLACK

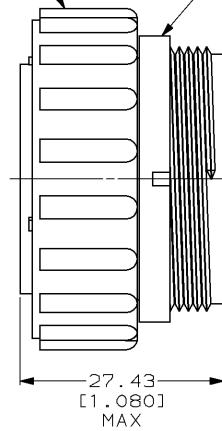

213851-1  
PART NUMBER

- THIS CONNECTOR WILL ACCEPT (24) MULTIMATE SOCKET CONTACTS.
- CONTACT CAVITIES IDENTIFIED BY CHARACTERS ON FRONT AND REAR FACE OF CONNECTOR.

DO NOT SCALE PRINT. UNLESS SPECIFIED DIMENSIONS IN mm [INCHES] TOLERANCES ON: 1. PLC DEC ± 0.13 [0.005] 2. PLC DEC ± - 3. PLC DEC ± - ANGLES ± -		DR 01/04/95 K. POLTZ	<b>AMP</b> AMP Incorporated Harrisburg, PA 17105-3608	
MATERIAL SEE CALLOUT		CHK 01/09/95 R. STONE	NAME PLUG ASSEMBLY, STANDARD SEX, SIZE 23, SERIES I, CPC	
FINISH -		APPD 01/10/95 T. COLLISON	SIZE B	CAGE CODE 00779
		APPD 01/16/95 A. FRANTUM	DRAWING NO 213851	
		PRODUCT SPEC -	SCALE 2:1	SHEET 1 OF 1
		APPLICATION SPEC -		
		WEIGHT -		

AMP 1470-15 REV 11-89  
16-JAN-97 11:29:32 amp06568 /home/ssrv026d/dsk04/dept4023/amp06568/edmod

CUSTOMER DRAWING