

4

3

2

1

THIS DRAWING IS UNPUBLISHED. RELEASED FOR PUBLICATION
 BY AMP INCORPORATED. ALL RIGHTS RESERVED.

LOC	QTY	REV	DESCRIPTION	DATE	BY	APPV
BD	35	0	RELEASED -1 PER NPR 5370, WAS 95-7970-20	06/27/95	-	-
		A	ADDED -2 AND REVISED PER EC 0020-900-95	15 SEP 95	DH	AF
		B	REV PER EC 0020-463-96	16 MAY 96	CR	AF

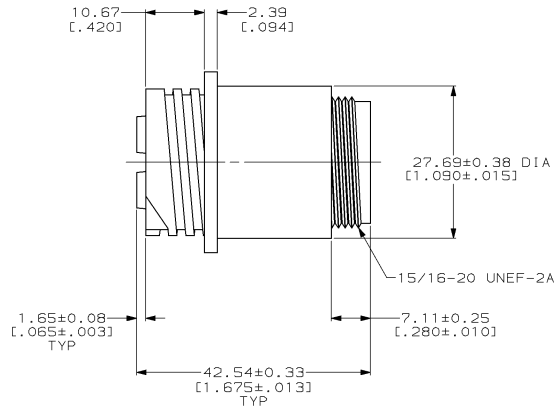
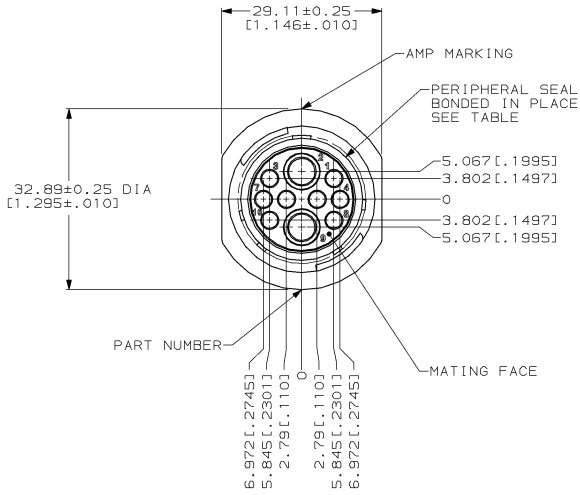

YES	213894-2
NO	213894-1
PERIPHERAL SEAL	PART NUMBER

DIMENSIONS mm (INCHES)	DIMENSIONS SPECIFIED 0 PLC ±- 1 PLC ±- 2 PLC ±0.13 (0.005) 3 PLC ±0.013 (0.005) 4 PLC ±- ANGLES ±-	DWN D. HARDY 06/27/95 CHK S. STONE 06/29/95 APPV S. STONE 06/29/95	NAME AMP Incorporated Harrisburg, PA 17105-3608
MATERIAL NYLON, BLACK	FINISH -	PRODUCT SPEC 108-1579 APPLICATION SPEC -	RECEPTACLE HOUSING, REVERSE SEX, SERIES 6, 17-10, CIRCULAR PLASTIC CONNECTOR
		RECORD -	SIZE A2
		CUSTOMER DRAWING	CASE CODE 00779 DRAWING NO. ©-213894
			SCALE 2:1
			SHEET 1 OF 1
			REV B

213894

A