

THIS DRAWING IS UNPUBLISHED  
 RELEASED FOR INFORMATION  
 © SPYRUS INC. ALL RIGHTS RESERVED

REV	DATE	DESCRIPTION	BY	CHK	APP
0					
1					

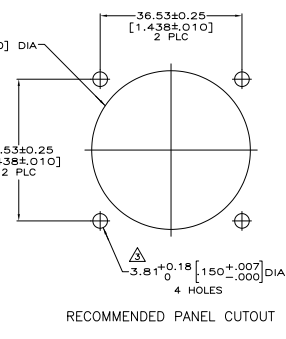

DETAIL A

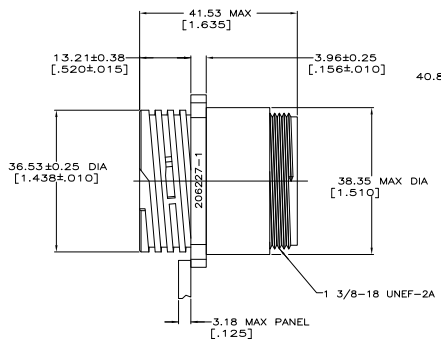
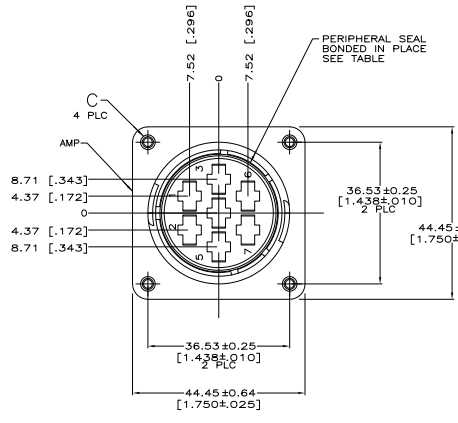
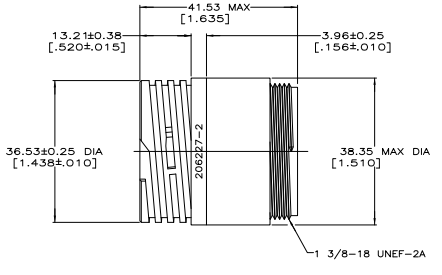
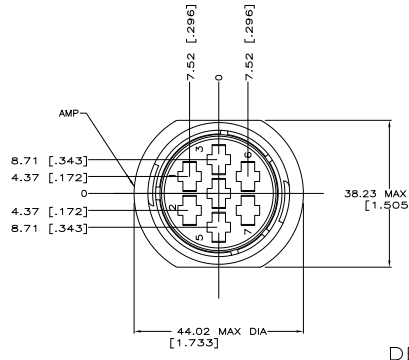

DETAIL B

1. CAVITY IDENTIFICATION ON FRONT AND REAR FACE.
  2. WILL ACCEPT SEVEN (7) TYPE XII SOCKET CONTACTS.
- #4 FASTENER RECOMMENDED FOR MOUNTING.
- OBsolete PARTS: OBSOLETE CIS STREAMLINING PER D.RENAUD/D.SINISI

4-40 THREADED INSERTS	NO	A	206227-6
3.8 1EO.08 [1.50±.003]	YES	A	206227-5
3.8 1EO.08 [1.50±.003]	NO	B	206227-2
3.8 1EO.08 [1.50±.003]	NO	A	206227-1
C		PERIPHERAL SEAL SEE DETAIL	PART NUMBER
THIS DRAWING IS A CONTROLLED DOCUMENT. DATE: 02/21/11			
DESIGNED BY: J. SLENNER		TE Connectivity	
CHECKED BY: J. SLENNER		RECEPTACLE HOUSING, REVERSE	
MATERIAL: NYLON BLACK		SEX, SHELL SIZE 25, CPC	
PART: 108-10024		REVISED TO: 108-10024	
SPEC: 108-10024		DATE: 02/21/11	
DRAWING NO: A100779		C=206227	
CUSTOMER DRAWING		SCALE: 2:1	

488 (2/11)