

REV	DATE	DESCRIPTION	BY	CHK	APP
0					
1					
2					
3					
4					
5					
6					
7					
8					

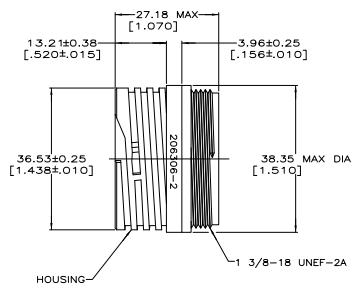
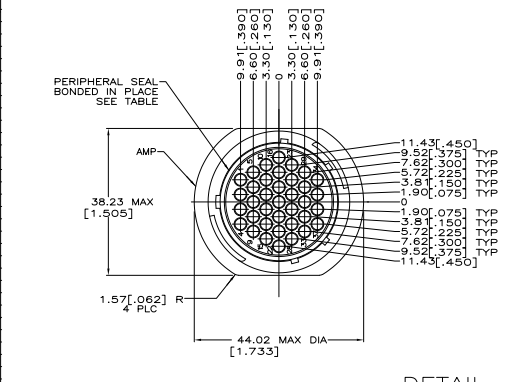
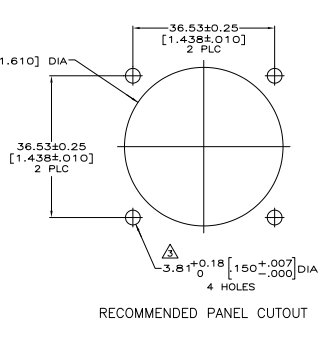
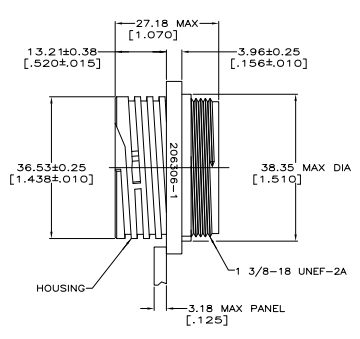
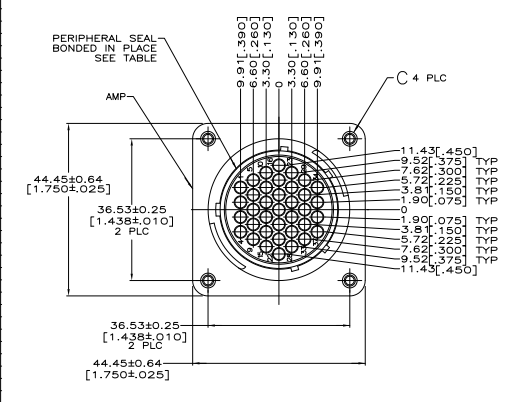

1. CAVITY IDENTIFICATION ON FRONT AND REAR FACE.
 2. WILL ACCEPT THIRTY-SEVEN (37) MULTIMATE SOCKET CONTACTS. NO 4 FASTENER RECOMMENDED FOR MOUNTING.
- NYLON 6/6, NATURAL.
 OBSOLETE PARTS: OBSOLETE CIS STREAMLINING PER D.RENAUD/D.SINISI

STANDARD	NO	3.81 [150] DIA HOLE	A	206306-8
SMALL PACK	NO	3.81 [150] DIA HOLE	A	206306-6
STANDARD	NO	4-40 THREADED INSERT	A	206306-5
STANDARD	YES	-	B	206306-4
STANDARD	YES	3.81 [150] DIA HOLE	A	206306-3
STANDARD	NO	-	B	206306-2
STANDARD	NO	3.81 [150] DIA HOLE	A	206306-1

THIS DRAWING IS A CONTROLLED DOCUMENT. THE ORIGINAL IS STORED IN THE CONTROL ROOM. THIS DRAWING IS A CONTROLLED DOCUMENT FOR THE CUSTOMER. IT IS SUBJECT TO CHANGE AND THE CONTROLLING ENGINEERING ORGANIZATION SHOULD BE CONTACTED FOR THE LATEST REVISION.

DRAWING: NYLON, BLACK
 INSERT: BRASS

THIS DRAWING IS A CONTROLLED DOCUMENT. THE ORIGINAL IS STORED IN THE CONTROL ROOM. THIS DRAWING IS A CONTROLLED DOCUMENT FOR THE CUSTOMER. IT IS SUBJECT TO CHANGE AND THE CONTROLLING ENGINEERING ORGANIZATION SHOULD BE CONTACTED FOR THE LATEST REVISION.

THIS DRAWING IS A CONTROLLED DOCUMENT. THE ORIGINAL IS STORED IN THE CONTROL ROOM. THIS DRAWING IS A CONTROLLED DOCUMENT FOR THE CUSTOMER. IT IS SUBJECT TO CHANGE AND THE CONTROLLING ENGINEERING ORGANIZATION SHOULD BE CONTACTED FOR THE LATEST REVISION.