

REVOLUTIONS		DATE	BY	APPD
P	LYA			
B1	REVISED PER ECO-11-004917	12MAR2011	AK	HMA

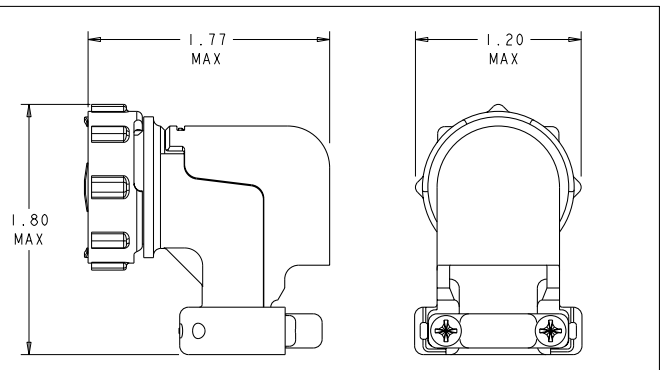
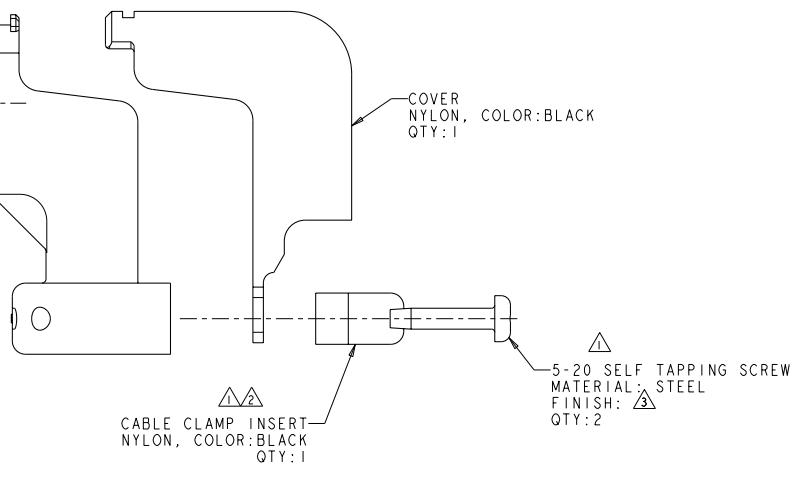
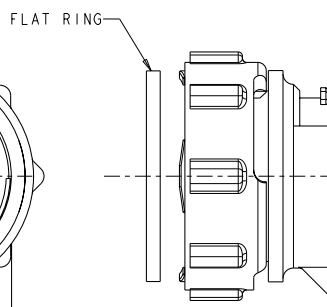
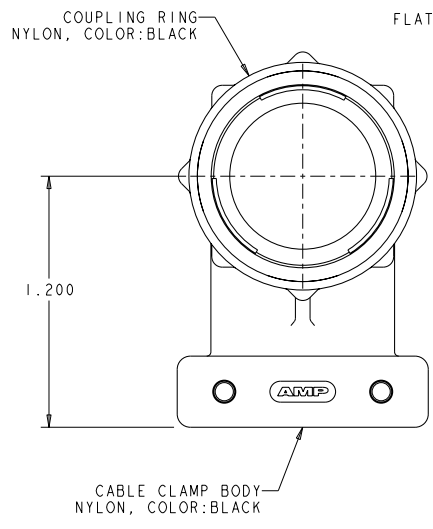

ASSEMBLED VIEW
SCALE 2:1

- △ SELF TAPPING SCREWS AND CABLE CLAMP INSERTS PACKAGED UNASSEMBLED.
- △ CLAMPING AREA ADJUSTABLE TO .453 O.D. MAX CABLE. CABLE CLAMP INSERTS CAN BE ADJUSTED BY INVERTING OR CHANGING CABLE CLAMP INSERT.
- △ SCREW FINISH ZINC WITH NON HEXAVALENT CHROMATE.

SUPERSEDED BY - 2	1546349-2
	1546349-1
	PART NUMBER

THIS DRAWING IS A CONTROLLED DOCUMENT.		DATE	13AUG2002
DRAWN BY S. WELDON		DATE	13AUG2002
CHECKED BY S. BEAVER		DATE	13AUG2002
APPROVED BY S. BEAVER		DATE	13AUG2002
PRODUCT SPEC		NAME	CABLE CLAMP KIT, UNASSEMBLED, R/A, W/COVER, SIZE 17, CPC
APPLICATION SPEC		SIZE	A200779
MATERIAL		CASE CODE	1546349
WEIGHT		DRAWING NO	
FINISH		RESTRICTED TO	
CUSTOMER DRAWING		SCALE	3:1
		SHEET	1 OF 1
		REV	B1