

4

3

2

1

THIS DRAWING IS UNPUBLISHED. RELEASED FOR PUBLICATION
 © COPYRIGHT - By - ALL RIGHTS RESERVED.

LOC	DIST	REVISIONS			
P	LTR	DESCRIPTION	DATE	DWN	APVD
BD	0				
	N1	REVISED PER ECO-11-004820	11MAR11	RK	HMR

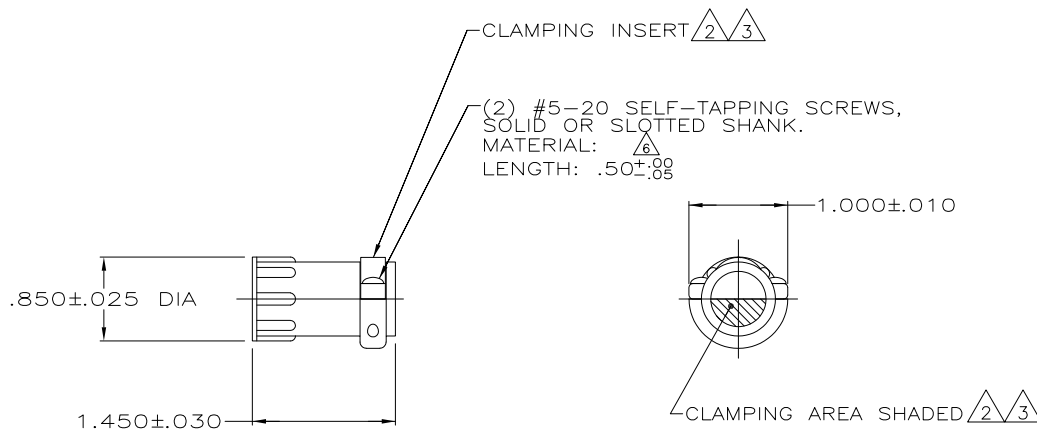

- 1 PARTS PACKAGED UNASSEMBLED.
- $\triangle 2$ CABLE CLAMPING AREA ADJUSTABLE FROM .010 TO .161 SQ IN BY REVERSING CLAMPING INSERTS. (2 INSERTS SUPPLIED, -1 AND -2 ONLY)
- $\triangle 3$ CABLE CLAMPING AREA ADJUSTABLE FROM .010 TO .161 SQ IN BY CHANGING CLAMPING INSERTS. (4 INSERTS SUPPLIED, -3 ONLY)
- 4 .453 MAXIMUM CABLE OUTSIDE DIAMETER.
- $\triangle 5$ BULK PACKAGED KITS TO BE ORDERED IN MULTIPLES OF 200 ONLY.
- $\triangle 6$ STEEL, ZINC PLATE WITH NON-HEXAVALENT CHROMATE.

$\triangle 6$	$\triangle 5$	BULK	206358-6
$\triangle 6$		INDIVIDUAL	206358-5
$\triangle 6$		INDIVIDUAL	206358-4
		OBSELETE	$\triangle 5$ BULK 206358-3
$\triangle 6$		SUPERSEDED BY 206358-6	$\triangle 5$ BULK 206358-2
$\triangle 6$		SUPERSEDED BY 206358-5	INDIVIDUAL 206358-1

PACKAGING	PART NUMBER

THIS DRAWING IS A CONTROLLED DOCUMENT.		DWN A GRAFF 4/23/91	TE Connectivity	
DIMENSIONS: INCHES		CHK W.G.LENKER 7-23-92	CABLE CLAMP KIT, LARGE, SHELL SIZE 11, CPC	
TOLERANCES UNLESS OTHERWISE SPECIFIED:		APVD -	NAME	
0 PLC	± -	PRODUCT SPEC 108-10024	RESTRICTED TO	
1 PLC	± -	APPLICATION SPEC	-	
2 PLC	± -	WEIGHT	SIZE A3	CAGE CODE 00779
3 PLC	± -	MATERIAL THERMOPLASTIC	DRAWING NO C-206358	SCALE NTS
4 PLC	± -	FINISH	CUSTOMER DRAWING	SHEET 1 OF 1
ANGLES	± -			REV N1