

4

3

2

1

THIS DRAWING IS UNPUBLISHED. RELEASED FOR PUBLICATION
 BY TYCO ELECTRONICS CORPORATION. ALL RIGHTS RESERVED.

LOC	DIST	REVISIONS			
FT	0	REV	DESCRIPTION	DATE	BY
		C	REVISED PER ECO-07-010208	5/1/07	SS SH

NOTES:

- △ TUBING: POLYOLEFIN, 94V2 RATED.
SLEEVE: NYLON, BLACK.
- △ ACTUAL SHAPE MAY VARY DUE TO PROCESS VARIANCE.

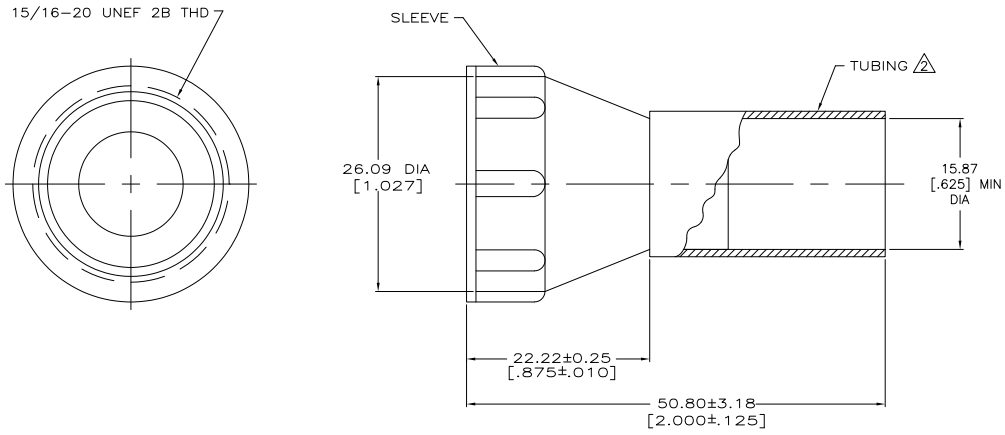

THIS DRAWING IS A CONTROLLED DOCUMENT.		DRN W.C. LENKER 19 MAR 98	Tyco Electronics Corporation Harrisburg, PA 17105-3608																			
DIMENSIONS: mm [INCHES]		CHK R. STONE 19 MAR 98	Tyco Electronics																			
TOLERANCES UNLESS OTHERWISE SPECIFIED:		APP'D A. FRANTZ 20 MAR 98	NAME STRAIN RELIEF ASSEMBLY, SHELL SIZE 17, CPC																			
<table border="1"> <tr><td>0. PLC</td><td>±</td><td>-</td></tr> <tr><td>1. PLC</td><td>±</td><td>-</td></tr> <tr><td>2. PLC</td><td>±</td><td>0.1% (0.05)</td></tr> <tr><td>3. PLC</td><td>±</td><td>-</td></tr> <tr><td>4. PLC</td><td>±</td><td>-</td></tr> <tr><td>ANGLES</td><td>±</td><td>-</td></tr> </table>		0. PLC	±	-	1. PLC	±	-	2. PLC	±	0.1% (0.05)	3. PLC	±	-	4. PLC	±	-	ANGLES	±	-	PRODUCT SPEC	APPLICATION SPEC	RESTRICTED TO
0. PLC	±	-																				
1. PLC	±	-																				
2. PLC	±	0.1% (0.05)																				
3. PLC	±	-																				
4. PLC	±	-																				
ANGLES	±	-																				
MATERIAL	- △	WEIGHT	SIZE A2 00779 C=213933	REVISIONS																		
FINISH	-	CUSTOMER DRAWING	SCALE NTS	SHEET 1 of 1																		

AMP 1471-9 REV 31MAR2000

213933

A

C