

DRAWING MADE IN THIRD ANGLE PROJECTION
 THIS DRAWING IS UNPUBLISHED. RELEASED FOR PUBLICATION
 © COPYRIGHT 19 BY AMP INCORPORATED. ALL INTERNATIONAL RIGHTS RESERVED.

REVOLUTIONS		DATE	APPD
CM	52		
F	OBS -4 & -14 PER EC 030-0123-96	8-13-97	PL-25
F1	REVISED PER ECO-09-022908	08/07/98	PL-26

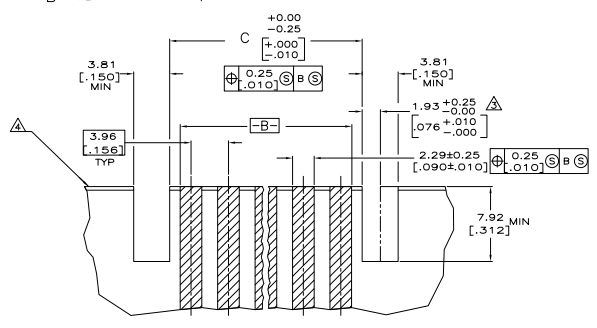
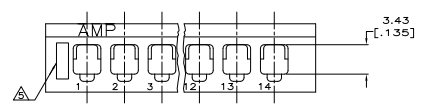
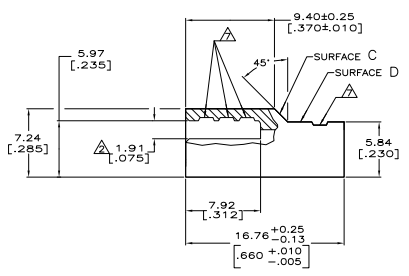
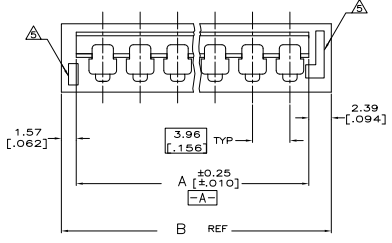
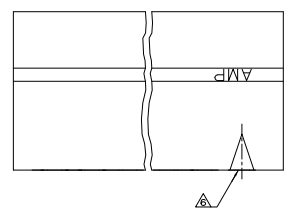

RECOMMENDED LAYOUT PATTERN
 FOR 1.575±0.191 [.0620±0.0075] THICK
 P.C. BOARD INCLUDING CIRCUITRY

- HOUSING ACCEPTS CONTACTS P/N 61668 OR 350194.
- MEASURED AT ENDS OF CARD SLOT.
- RECOMMENDED CUTOUT FOR HOUSING POLARIZATION, WHERE REQUIRED.
- 0.38 [.015] MIN X 45° CHAMFER RECOMMENDED ON BOTH SIDES OF BOARD.
- CORING OPTIONAL.
- OPTIONAL FROSTED SURFACE LOCATED ON 1/4 OF CIRCUIT NO. 1; ANOTHER OPTION IS A RECESSED TRIANGLE ON SURFACE C WITH A FROSTED AMP LOGO ON SURFACE D.
- OPTIONAL PULL GROOVE AS REQUIRED FOR MOLDING.
- DIMENSIONS IN BRACKETS ARE IN INCHES.
- OBsolete PARTS: OBsolete CIS STREAMLINING PER D.RENAUD/D.SINISI

C	B	A	NO. OF CIRCUITS	PART NO.
44.17[1.739]	48.41[1.906]	44.45[1.750]	11	1-770438-1
36.25[1.427]	40.49[1.594]	36.53[1.438]	9	770438-9
24.33[.958]	28.58[1.125]	24.61[.969]	6	770438-6
20.37[.802]	24.61[.969]	20.65[.813]	5	770438-5
OBsolete	12.42[.489]	16.66[.656]	3	770438-3

DO NOT SCALE PRINT. UNLESS SPECIFIED DIMENSIONS IN mm [INCHES] TOLERANCES IN MILLIMETERS OR INCHES		DR 2-20-92 K. SALMON	AMP Incorporated Harrisburg, PA 17105-3608	
MATERIAL POLYESTER, UL94V-0 (NATURAL)		CHK 2-20-92 R. SPRY	NAME HOUSING, EDGE CONNECTOR, BIFURCATED LEAF	
FINISH -	APPLICATION SPEC -	APPD 4-24-92 W. LONG	SIZE D	CAGE CODE 00779
WEIGHT -	SCALE 5:1	PRODUCT SPEC -	DRAWING NO 770438	REV F1
			SHEET 1 OF 1	



CUSTOMER DRAWING