

4

3

2

1

THIS DRAWING IS UNPUBLISHED. RELEASED FOR PUBLICATION
 © COPYRIGHT BY TYCO ELECTRONICS CORPORATION. ALL RIGHTS RESERVED.

LOC	DIST	REVISIONS			
P	LTR	DESCRIPTION	DATE	BY	APPD
B		ECO-05-004683	18JAN06	BSV	MM
B1		REV PER ECO-09-021510	14SEP09	KK	AEG

MINIMUM CONTACT
AREA GOLD PLATED

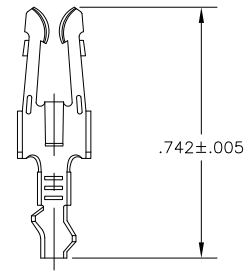
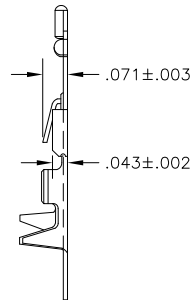
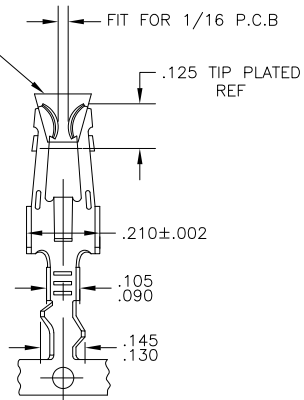

LOOSE PIECE

1. WIRE SIZE: #20-#18 AWG, INSULATION RANGE .070-.110 DIA.

② L-R REELING FOR MINI-APPLICATOR.

③ MATTE TIN PLATE IN CRIMP AREA.

④ OBSOLETE PARTS: OBSOLETE CIS STREAMLINING PER D.RENAUD/D.SINISI

NICKEL PLATE ALL OVER, TIP PLATE .000030 THICK GOLD.	583362-4 L.P.(5-583363-3)	583362-7	③
NICKEL PLATE ALL OVER, TIP PLATE .000015 THICK GOLD.	583362-3 L.P.(5-583363-2)	583362-6	③
TIN.	583362-2 L.P.(5-583363-1)	583362-5	③
NICKEL PLATE ALL OVER, TIP PLATE .000030 THICK GOLD.	583362-4 L.P.(583363-3)	583362-4	②
NICKEL PLATE ALL OVER, TIP PLATE .000015 THICK GOLD.	583362-3 L.P.(583363-2)	583362-3	②
TIN.	583362-2 L.P.(583363-1)	583362-2	②
FINISH	LOOSE PIECE COMBINATION NO.	PART NO.	

THIS DRAWING IS A CONTROLLED DOCUMENT.		DATE	Tyco Electronics Corporation	
DIMENSIONS:	TOLERANCES UNLESS OTHERWISE SPECIFIED:	16SEP07	Harrisburg, PA 17105-3608	
INCHES		OK	APVD	
Ø	0 PLC ± .0005	PRODUCT SPEC	MODIFIED FORK CONTACT	
1 PLC ± .0005	1 PLC ± .0005	APPLICATION SPEC	SIZE	CAGE CODE
2 PLC ± .0005	2 PLC ± .0005	WEIGHT	A2	00779
3 PLC ± .0005	3 PLC ± .0005	FINISH	C=583362	
4 PLC ± .0005	4 PLC ± .0005		RESTRICTED TO	
ANGLES ± .0005	ANGLES ± .0005		CUSTOMER DRAWING	
MATERIAL	PHOS. BRONZE	SEE TABLE	SCALE	4:1
			SHEET	1 of 1
			REV	B1

AMP 1471-9 REV 31MM0200

583362

A