

4

3

2

1

THIS DRAWING IS UNPUBLISHED.
 © COPYRIGHT 19 BY AMP INCORPORATED. ALL RIGHTS RESERVED.

REVISONS		DATE	BY	APPD
FT	22			
F	LWR			
W	REDRAWN W/O CHANGE PER EC 0320-299-97	28 AUG 97	-	-

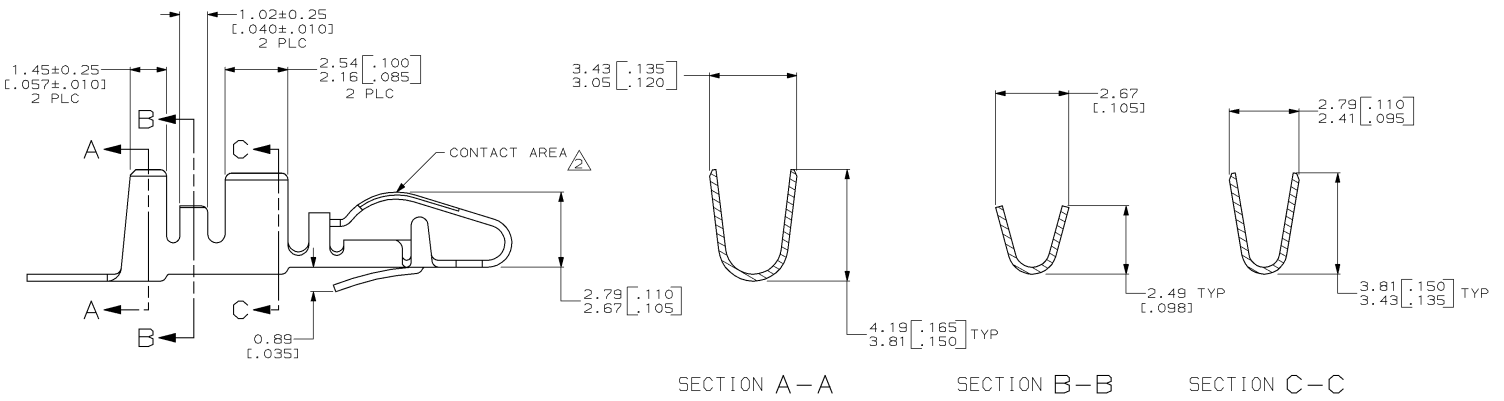
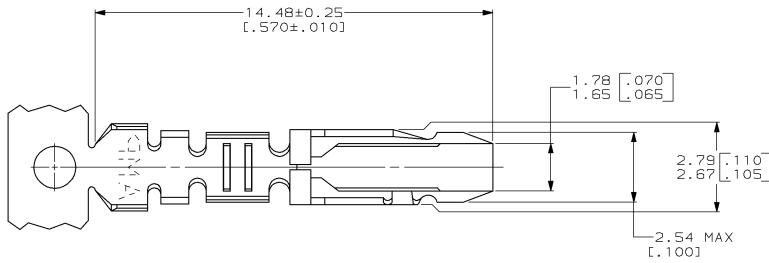

- 1 PHOSPHOR BRONZE.
- 2 0.76µm [L.000030] MIN GOLD IN CONTACT AREA,
GOLD FLASH ON REMAINDER OF CONTACT, BOTH OVER 1.27µm [L.000050] MIN NICKEL.
- 3. REVERSE REELED (LEFT TO RIGHT FEED), FOR MINI-APPLICATOR.
- 4. INSULATION RANGE: 2.03 [L.080] DIA.

60151-6
PART NUMBER

THIS DRAWING IS A CONTROLLED DOCUMENT.		DN D. HARDY	28 AUG 97	AMP Incorporated Harrisburg, PA 17105-3608
		CHK R. STONE	04 SEP 97	
		APPD N. SCHROLL	05 SEP 97	CONTACT, 16 AWG, AMP-LEAF™
		PRODUCT SPEC		
DIMENSIONS mm (INCHES)	TOLERANCES UNLESS SPECIFIED	APPLICATION SPEC	SIZE CASE CODE DRAWING NO	RESTRICTED TO
	0 PLC ±.01 1 PLC ±.015 2 PLC ±.02 3 PLC ±.03 4 PLC ±.04 ANGLES ±.05	WEIGHT	A200779 C= 60151	
MATERIAL	FINISH		CUSTOMER DRAWING	SCALE 10:1 SHEET 1 OF 1 REV W

60151