

4 3 2 1

THIS DRAWING IS UNPUBLISHED. RELEASED FOR PUBLICATION. COPYRIGHT 20 BY - ALL RIGHTS RESERVED.

NOTES:  
 ⚠ MATERIALS AND FINISH  
 - HOUSING: LCP  
 - CONTACTS: COPPER ALLOY,  
 FINISH: TIN  
 2 PRODUCT TO COMPLY WITH  
 DIRECTIVE 2002/95/EC (ROHS)  
 3 PACKAGED IN TAPE AND REEL  
 PER EIA-481 SPECIFICATIONS  
 ⚠ OPTIONAL PADS FOR SMT  
 POKE-IN CONNECTOR PN 1954097-1

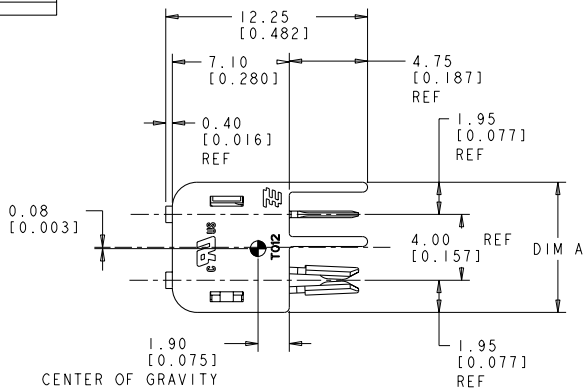

REVISIONS				
P	LY	DESCRIPTION	DATE	BY
B1		REVISED PER ECO-11-004587	11MAR2011	RK HMA

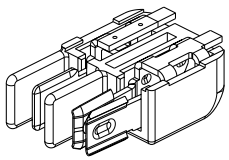
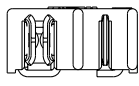
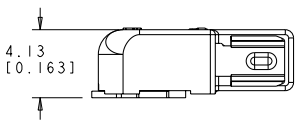

1954289-1/  
1-1954289-1  
SHOWN

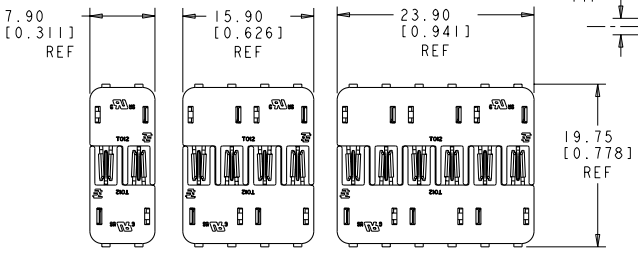

1954289-1/ 1-1954289-1 SCALE 3:1  
 1954289-2/ 1-1954289-2 SCALE 3:1  
 1954289-3/ 1-1954289-3 SCALE 3:1

MATED PAIRS SHOWN FOR REFERENCE

POSITION	COLOR	DIM A	PART NO.
6	BLACK	23.90	1-1954289-3
4	BLACK	15.90	1-1954289-2
2	BLACK	7.90	1-1954289-1
6	NATURAL	23.90	1954289-3
4	NATURAL	15.90	1954289-2
2	NATURAL	7.90	1954289-1

THIS DRAWING IS A CONTROLLED DOCUMENT. DWG: 18DEC2006  
 S: RAGHU  
 S: HORST  
 DATE: 17APR2007

TE Connectivity

CONNECTOR ASSEMBLY  
 HERMAPHRODITIC BLADE AND RECEPTACLE

PRODUCT SPEC: 108-2342	SHEET: A2	CASE CODE: 00779	DRAWING NO: 1954289	RESTRICTED TO: -
APPLICATION SPEC: 114-13225	WEIGHT: -	CUSTOMER DRAWING	SCALE: 3:1	SHEET 1 OF 2 REV B1

LOC	DISP	REV	DATE	BY	APPR
-	-	1	-	-	-
REVISIONS					
DESCRIPTION			DATE	BY	APPR
SEE SHEET 1			-	-	-

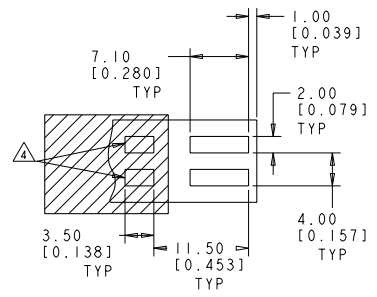

RECOMMENDED PCB LAYOUT FOR 1954289-1 & 1-1954289-1

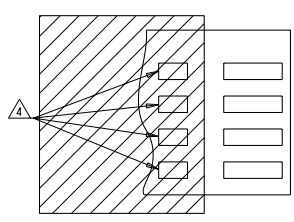

RECOMMENDED PCB LAYOUT FOR 1954289-2 & 1-1954289-2

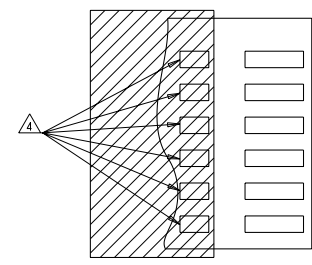

RECOMMENDED PCB LAYOUT FOR 1954289-3 & 1-1954289-3

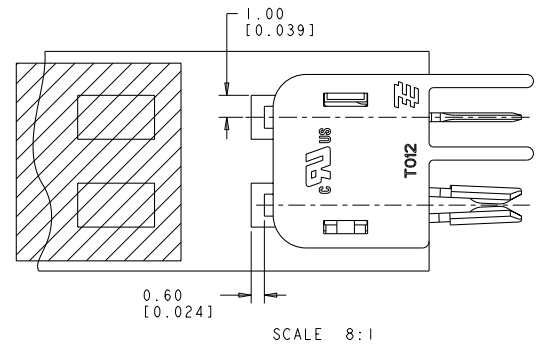

SCALE 8:1

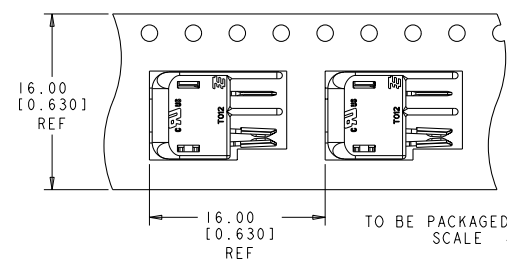

TO BE PACKAGED AS SHOWN SCALE 4:1

THIS DRAWING IS A CONTROLLED DOCUMENT.		DN RAGHU	18DEC2006	TE Connectivity	
DIMENSIONS: mm		CC S. HORST	17APR2007	CONNECTOR ASSEMBLY: HERMAPHRODITIC BLADE AND RECEPTACLE	
MATERIAL		APPR	NAME	SHEET	RESTRICTED TO
		PRODUCT SPEC	108-2342	A2	00779
		APPLICATION SPEC	114-13225	CASE CODE	1954289
		WEIGHT		DRAWING NO	
		CUSTOMER DRAWING		SCALE	3:1
				SHEET	2 OF 2
				REV	B1