

DRAWING MADE IN THIRD ANGLE PROJECTION
 THIS DRAWING IS UNPUBLISHED. RELEASED FOR PUBLICATION
 © COPYRIGHT 19 BY AMP INCORPORATED. ALL INTERNATIONAL RIGHTS RESERVED.

REVOLUTIONS		DATE	APPD
H	REV PER 003C-0538-04	210004	JR/DS
H1	REV PER ECO-10-003194	000010	02/HR

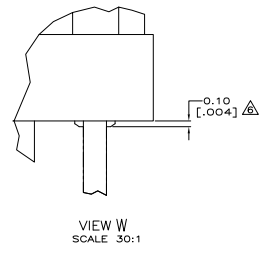

VIEW W
SCALE 30:1

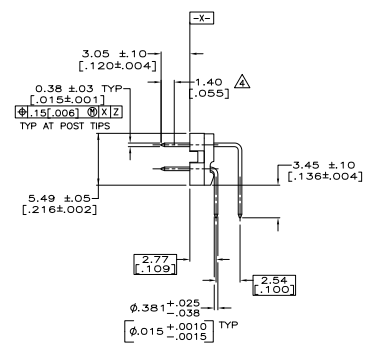
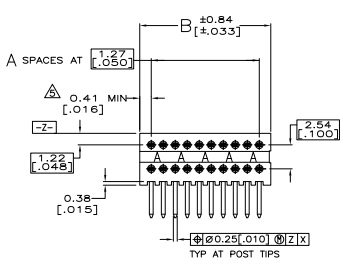
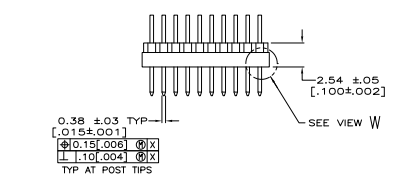
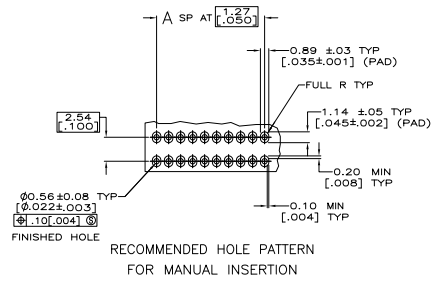

RECOMMENDED HOLE PATTERN
FOR MANUAL INSERTION

- △ FLAME REDARTANT THERMOPLASTIC, COLOR - BLACK
- △ COPPER ALLOY
- △ CONTACTS PLATED WITH .00381[.000150] MIN TIN-LEAD; ALL OVER .00127[.000050] MIN NICKEL
- △ POINT OF MEASUREMENT FOR PLATING THICKNESS
- △ THE NOTED DIMENSION APPLIES AT THE INTERSECTION OF THE POST AND HOUSING
- △ MAXIMUM CARRIER PROTRUSION BEYOND HOUSING.
- △ CONTACTS PLATED WITH .00381[.000150] MIN TIN; ALL OVER .00127[.000050] MIN NICKEL
- △ OBSOLETE PARTS: OBSOLETE CIS STREAMLINING PER D.RENAUD/D.SINISI

14.35 [1.563]	10	22	△ 5-104746-2
63.88 [2.515]	49	100	△ 5-104746-1
14.35 [1.563]	10	22	△ 104746-2
63.88 [2.515]	49	100	△ 104746-1

8 SUPERCEDED BY 5-104746-1

B	A	NO OF POSN	PART NUMBER

DO NOT SCALE PRINT, UNLESS SPECIFIED		DR 10/20/90 DATE HELD		AMP AMP Incorporated Harrisburg, PA 17105-3608	
DIMENSIONS IN mm [INCHES]		CHK 10-31-90	Q. GORDON	NAME	
TOLERANCES UNLESS OTHERWISE SPECIFIED		APPD 10-31-90	R. FELIX	HDR ASSY, AMPMODU System 50	
2 P.L.C. DEC 1/16, 005		PRODUCT SPEC	108-1093	RT-ANGLE, UNSHROUDED, DBL-ROW	
MATERIAL		FINISH	SEE TABLE	SIZE	D 00779
HOUSING: △		APPLICATION SPEC	114-25031	CAGE CODE	104746
CONTACT: △		WEIGHT		SCALE	5:1
				DRAWING NO	104746
				SHEET	1 OF 1



CUSTOMER DRAWING