

| POSITIONS/ CONTACTS | A | | B | |
|------------------------|---------|--------------|---------|--------------|
| | MM±0.20 | [INCH±0.008] | MM±0.30 | [INCH±0.012] |
| 02/02 | 1.00 | 0.039 | 2.00 | 0.079 |
| 03/03 | 2.00 | 0.079 | 3.00 | 0.118 |
| 04/04 | 3.00 | 0.118 | 4.00 | 0.157 |
| 05/05 | 4.00 | 0.157 | 5.00 | 0.197 |
| 06/06 | 5.00 | 0.197 | 6.00 | 0.236 |
| 07/07 | 6.00 | 0.236 | 7.00 | 0.276 |
| 08/08 | 7.00 | 0.276 | 8.00 | 0.315 |
| 09/09 | 8.00 | 0.315 | 9.00 | 0.354 |
| 10/10 | 9.00 | 0.354 | 10.00 | 0.394 |
| 11/11 | 10.00 | 0.394 | 11.00 | 0.433 |
| 12/12 | 11.00 | 0.433 | 12.00 | 0.472 |
| 13/13 | 12.00 | 0.472 | 13.00 | 0.512 |
| 14/14 | 13.00 | 0.512 | 14.00 | 0.551 |
| 15/15 | 14.00 | 0.551 | 15.00 | 0.591 |
| 16/16 | 15.00 | 0.591 | 16.00 | 0.630 |
| 17/17 | 16.00 | 0.630 | 17.00 | 0.669 |
| 18/18 | 17.00 | 0.669 | 18.00 | 0.709 |
| 19/19 | 18.00 | 0.709 | 19.00 | 0.748 |
| 20/20 | 19.00 | 0.748 | 20.00 | 0.787 |
| 21/21 | 20.00 | 0.787 | 21.00 | 0.827 |
| 22/22 | 21.00 | 0.827 | 22.00 | 0.866 |
| 23/23 | 22.00 | 0.866 | 23.00 | 0.906 |
| 24/24 | 23.00 | 0.906 | 24.00 | 0.945 |
| 25/25 | 24.00 | 0.945 | 25.00 | 0.984 |
| 26/26 | 25.00 | 0.984 | 26.00 | 1.024 |
| 27/27 | 26.00 | 1.024 | 27.00 | 1.063 |
| 28/28 | 27.00 | 1.063 | 28.00 | 1.102 |
| 29/29 | 28.00 | 1.102 | 29.00 | 1.142 |
| 30/30 | 29.00 | 1.142 | 30.00 | 1.181 |
| 31/31 | 30.00 | 1.181 | 31.00 | 1.220 |
| 32/32 | 31.00 | 1.220 | 32.00 | 1.260 |
| 33/33 | 32.00 | 1.260 | 33.00 | 1.299 |
| 34/34 | 33.00 | 1.299 | 34.00 | 1.339 |
| 35/35 | 34.00 | 1.339 | 35.00 | 1.378 |
| 36/36 | 35.00 | 1.378 | 36.00 | 1.417 |
| 37/37 | 36.00 | 1.417 | 37.00 | 1.457 |
| 38/38 | 37.00 | 1.457 | 38.00 | 1.496 |
| 39/39 | 38.00 | 1.496 | 39.00 | 1.535 |
| 40/40 | 39.00 | 1.535 | 40.00 | 1.575 |
| 41/41 | 40.00 | 1.575 | 41.00 | 1.614 |
| 42/42 | 41.00 | 1.614 | 42.00 | 1.654 |
| 43/43 | 42.00 | 1.654 | 43.00 | 1.693 |
| 44/44 | 43.00 | 1.693 | 44.00 | 1.732 |
| 45/45 | 44.00 | 1.732 | 45.00 | 1.772 |
| 46/46 | 45.00 | 1.772 | 46.00 | 1.811 |
| 47/47 | 46.00 | 1.811 | 47.00 | 1.850 |
| 48/48 | 47.00 | 1.850 | 48.00 | 1.890 |
| 49/49 | 48.00 | 1.890 | 49.00 | 1.929 |
| 50/50 | 49.00 | 1.929 | 50.00 | 1.969 |

PART NUMBER CODING
SMH100-LP_E-S_-ST-BK

TERMINATION
STRAIGHT

NUMBER OF POSITIONS
(CONTACTS PER ROW, 2 THRU 50)

PLATING
P = GOLD FLASH OVERALL
S = 10u" GOLD OVERALL

| REVISIONS | | | | |
|-----------|---------|-----------------|----------|----|
| REV. | ECO. NO | DESCRIPTION | DATE | BY |
| A | 1910 | INITIAL RELEASE | 2/5/2009 | JH |

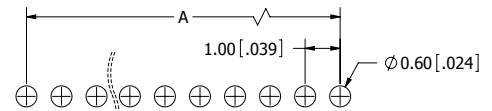
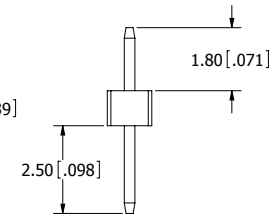
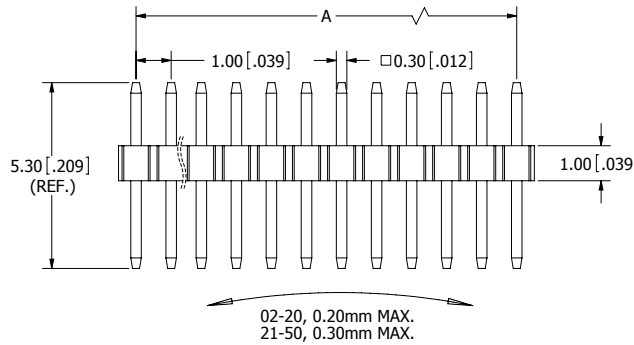
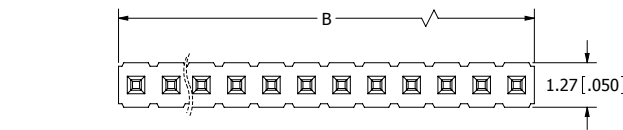

- NOTES:**
1. INSULATOR MATERIAL: L.C.P, UL 94V-0, BLACK COLOR.
 2. CONTACT MATERIAL: PHOSPHOR BRONZE.
 3. CONTACT PLATING: SEE PART NUMBER CODING.
 4. CURRENT RATING: 1 AMP.
 5. INSULATOR RESISTANCE: 1000 MEGA OHMS MIN.
 6. CONTACT RESISTANCE: 20 MILLI OHMS MAX.
 7. DIELECTRIC WITHSTANDING: AC 300V.
 8. OPERATING TEMPERATURE: -40° C TO +125° C.
 9. PROCESSING TEMP.: 260° C FOR 10 SECS MAX.

(INDICATED TEMPERATURE AND TIME IS FOR COMPONENT INSULATOR. HIGHER PROCESSING TEMPERATURES MAY BE USED, PROVIDED HEAT IS APPLIED FROM BACK SIDE OF PCB, AND INSULATOR DOES NOT EXCEED INDICATED TEMPERATURE AND TIME.)



RoHS COMPLIANT

UNLESS OTHERWISE SPECIFIED:
DIMENSIONS ARE IN MM(INCHES)

TOLERANCES:
ANGULAR: ± 5°
X = ± .30 [0.012]
XX = ± .25 [0.008]
XXX = ± .10 [0.004]
SURFACE FINISH: 63 Ra
REMOVE ALL BURRS AND SHARP EDGES .010 MAX

INTERPRET DIMENSIONS AND GEOMETRIC TOLERANCING PER: ANSI Y14.5M-1994

| DRAWN | DATE | NAME |
|-------|---------|------|
| JH | 2/05/09 | JH |

THE INFORMATION HEREIN CONTAINS PROPRIETARY INFORMATION OF SULLINS ELECTRONICS AND IS NOT TO BE REPRODUCED, COPIED OR DISCLOSED TO OTHERS FOR ANY PURPOSE EXCEPT AS SPECIFICALLY AUTHORIZED IN WRITING BY AN OFFICER OF SULLINS ELECTRONICS.

DESCRIPTION: HEADER, MALE 1mm CC, 1 ROW, ST
PART NUMBER: SMH100-LP_E-S_-ST-BK
SIZE: C
DWG. NO.: 11192
SCALE: 1:1



DESCRIPTION: HEADER, MALE 1mm CC, 1 ROW, ST
PART NUMBER: SMH100-LP_E-S_-ST-BK

SIZE: C
DWG. NO.: 11192
SCALE: 1:1