

REV	DATE	DESCRIPTION	BY	CHK	APP
AD 47		REVISED PER EDD-11-004835			

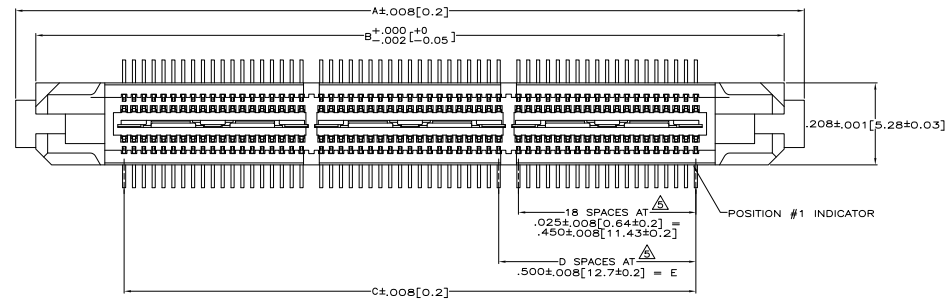

- △ HOUSING: LIQUID CRYSTAL POLYMER, COLOR BLACK.
- △ CONTACTS: HIGH RELIABILITY COPPER ALLOY.
- △ GROUND BUSES: PHOSPHOR BRONZE ALLOY, UNS C51100.
- △ CONTACTS & GROUND BUSES: NICKEL UNDERPLATE ALL OVER, MATING SURFACE PLATED TO MEET LEVEL 1 PERFORMANCE REQUIREMENTS OF TE CONNECTIVITY PRODUCTION SPECIFICATION 108-1422, SOLDER TAILS PLATED TIN-LEAD.
- △ DATE CODE MARKED IN AREA INDICATED ON SAME SIDE AS POSITION #1.
- △ ONE GROUND BUS WITH 5 TAILS PER EACH MODULE.
- △ TOLERANCE NON-ACCUMULATIVE.
- △ FOR SLIP-FIT APPLICATIONS, ORIENTATION HOLE TO BE  $\phi .079 \pm .001 [2.00 \pm 0.03]$ .

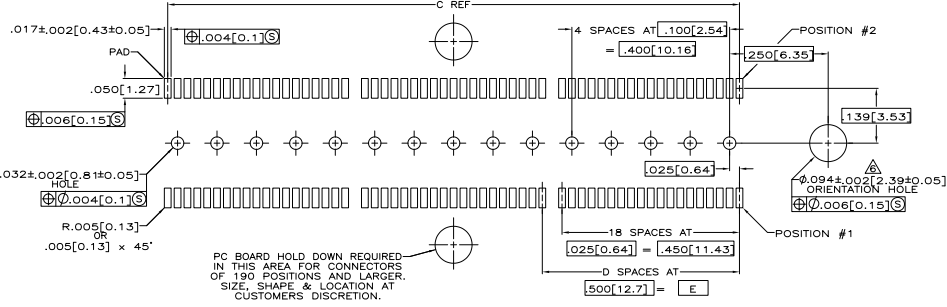
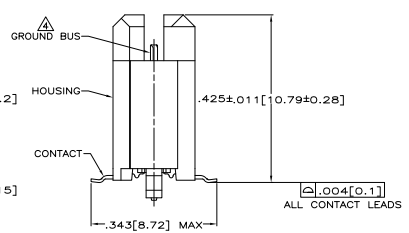
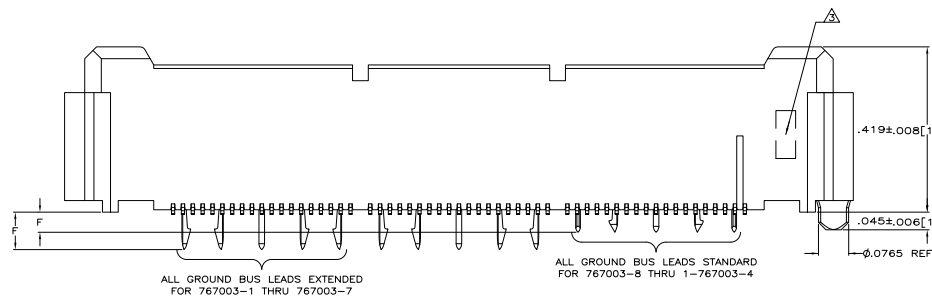

STANDARD	Q60 [1.52]	3,000 [76.2]	6	3,450 [87.63]	3,898 [99]	4,000 [101.6]	266	1-767003-4	
STANDARD	Q60 [1.52]	2,000 [50.8]	5	2,950 [74.93]	3,398 [86.31]	3,500 [88.9]	238	1-767003-3	
STANDARD	Q60 [1.52]	2,000 [50.8]	4	2,450 [62.23]	2,898 [73.61]	3,000 [76.2]	190	1-767003-2	
STANDARD	Q60 [1.52]	1,000 [25.4]	2	1,450 [36.83]	1,898 [48.21]	2,000 [50.8]	114	1-767003-1	
STANDARD	Q60 [1.52]	500 [12.7]	1	950 [24.13]	1,398 [35.11]	1,500 [38.1]	76	767003-0	
OBSOLETE	EXTENDED	1,042 [26.4]	3,000 [76.2]	6	3,450 [87.63]	3,898 [99]	4,000 [101.6]	266	767003-5
OBSOLETE	EXTENDED	1,042 [26.4]	2,000 [50.8]	5	2,950 [74.93]	3,398 [86.31]	3,500 [88.9]	238	767003-4
OBSOLETE	EXTENDED	1,042 [26.4]	1,000 [25.4]	2	1,450 [36.83]	1,898 [48.21]	2,000 [50.8]	114	767003-3
OBSOLETE	EXTENDED	1,042 [26.4]	500 [12.7]	1	950 [24.13]	1,398 [35.11]	1,500 [38.1]	76	767003-2
OBSOLETE	EXTENDED	1,042 [26.4]	0 [0]	0	450 [11.43]	898 [22.61]	1,000 [25.4]	38	767003-1

THIS DRAWING IS A CONTROLLED DOCUMENT.

DESIGNER	DATE	REVISED BY	DATE
108-1422	114-11004		

TE Connectivity  
 PLUG ASSEMBLY, 430[10.92] VERTICAL, .025[0.64] GULL WING LEADS, VECTOR

114-11004  
 108-1422  
 114-11004  
 100779 Q=767003