

REV.	DESCRIPTION	DATE
A	NEW DRAWING	4/20/2006

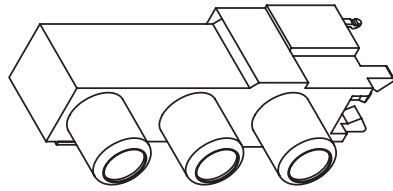

SPECIFICATIONS:
 CONTACT RESISTANCE: 30m OHMS MAX
 INSULATION RESISTANCE: 100M OHMS MIN: 500V DC
 VOLTAGE WITHSTAND: 500V AC R.M.S. FOR 1 MINUTE
 LIFE: 5,000 CYCLES
 OPERATING TEMP: -20° ~ +85°C

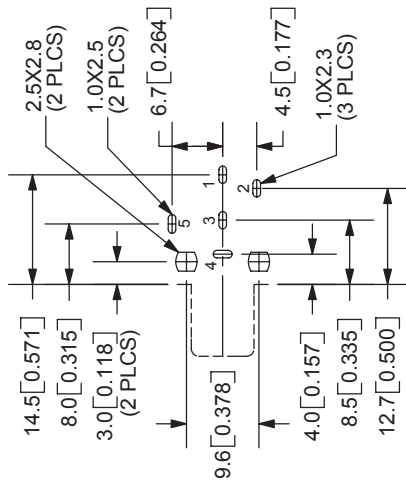
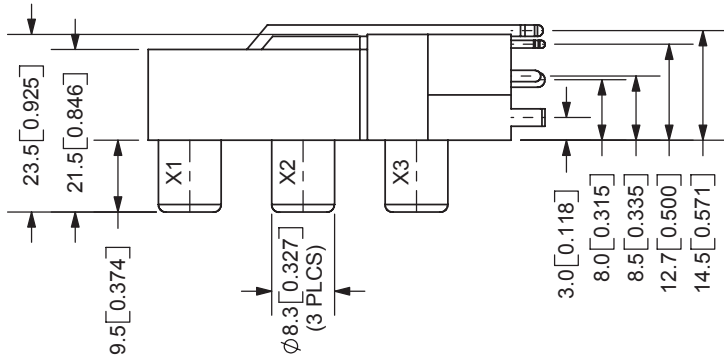
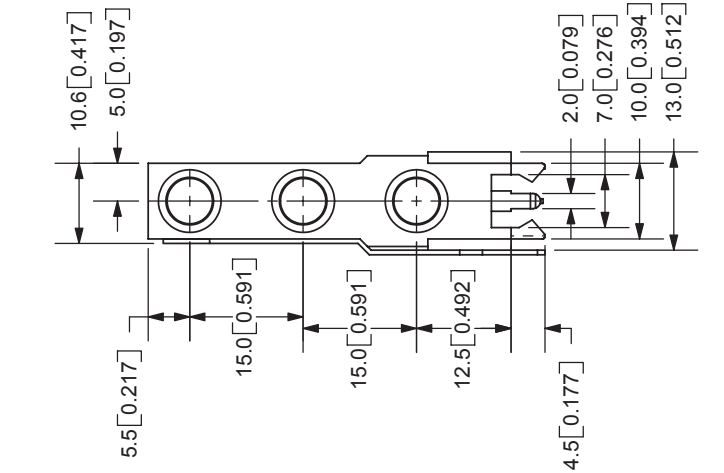

TOLERANCE:
 ±0.3mm UNLESS OTHERWISE
 SPECIFIED



9615 SW Allen Blvd., Ste. 103
 Beaverton, OR 97005
 Phone: 503-643-4899
 800-275-4899
 Fax: 503-372-1266
 Website: www.cui.com

COLOR INDEX			
PART NO.	INPUT X1	INPUT X2	INPUT X3
RCJ-33234	Red Color	White Color	Yellow Color
RCJ-33X1 X2 X3	Color X1	Color X2	Color X3

COLOR CHART	
1	Black
2	Red
3	White
4	Yellow
5	Blue
6	Green
7	Orange

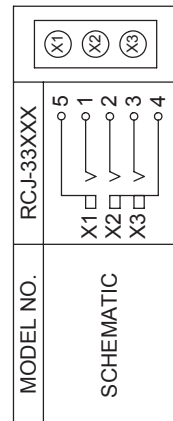

TITLE:	RCA Jack, Dual, Rt Angle, PCB Mount, Vert.	REV:	A
PART NO:	RCJ-33XXX	UNITS:	MM [INCHES]
DRAWN BY:	ZRJ	APPROVED BY:	
SCALE:	1:1		

PC FILE NAME: RCJ-33XXX
 COPYRIGHT 2006 BY CUI INC.