

Model 122505A & 122506A & Assembly Instructions Do-It-Yourself Retractable Sheath Banana Plug

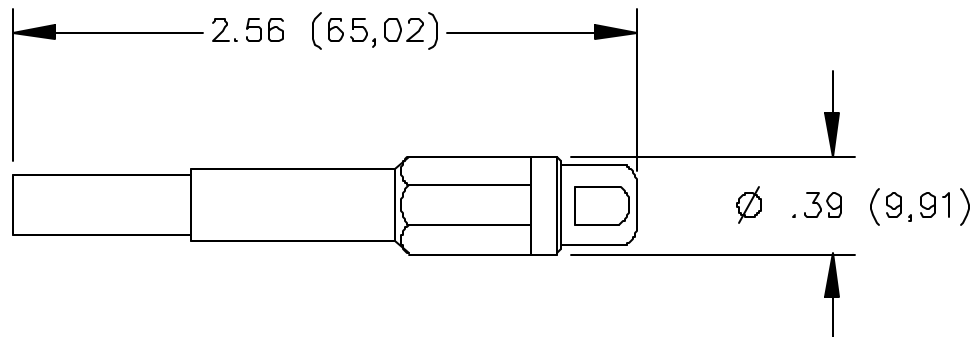

FEATURES:

- Models 122505A and 122506A accepts 18 to 22 AWG wire.
- Ideal for creating a special patch cord length.
- Spring loaded retractable sheath offers versatile use in sheathed and non-sheathed style of banana jacks.

MATERIALS:

Insulation: Lucel Acetal Polymer (N127)

Contact: Nickel plated brass & Beryllium Copper

RATINGS:

Operating Voltage: 1500 VRMS per IEC 1010, CAT III

Operating Temperature: -10°C to +80°C

Current: 20 Amperes

ORDERING INFORMATION:

Model 122505A (Color: Black)

Model 122506A (Color: Red)

All dimensions are in inches. Tolerances (except noted): .xx = ±.02" (.51 mm), .xxx = ± .005" (.127 mm).

All specifications are to the latest revisions. Specifications are subject to change without notice.

Registered trademarks are the property of their respective companies. Made in USA

Model 122505A & 122506A & Assembly Instructions Do-It-Yourself Retractable Sheath Banana Plug

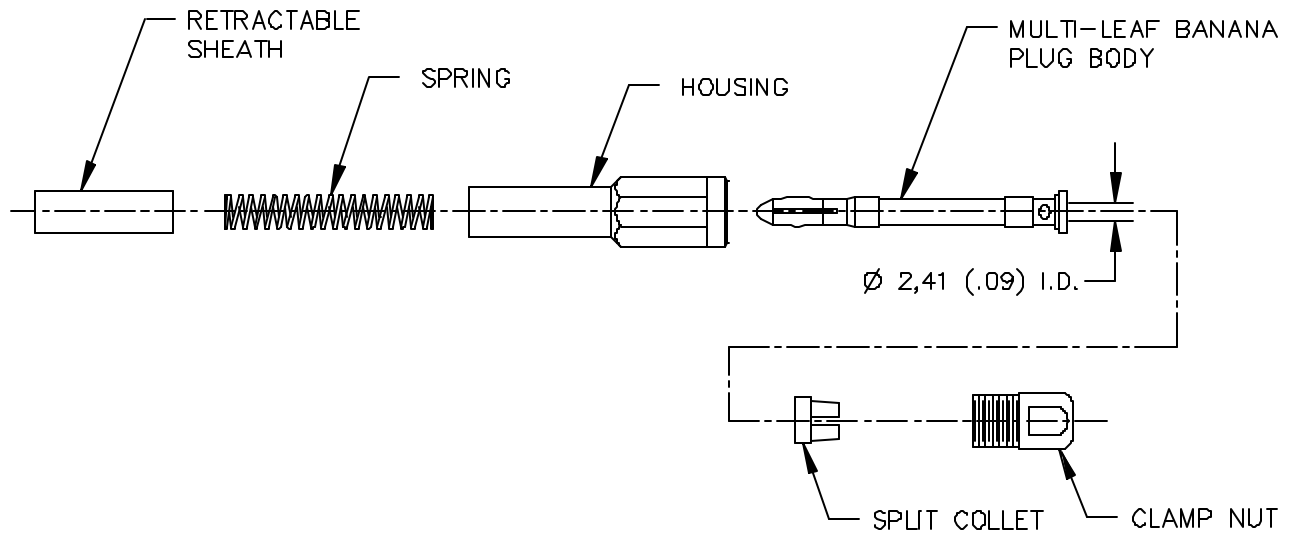

ASSEMBLY INSTRUCTIONS:

- A. Slide clam nut and split collet over wire.
- B. Solder wire to body.
- C. Tighten clam nut.
- D. Slide spring over banana plug body.
- E. Slide sheath over banana plug body until snap.

All dimensions are in inches. Tolerances (except noted): .xx = ±.02" (.51 mm), .xxx = ± .005" (.127 mm).
All specifications are to the latest revisions. Specifications are subject to change without notice.
Registered trademarks are the property of their respective companies. Made in USA

6/9/99

SY/EH/LS

S:\Engineering\Release\DataSheets\FIukeDataSheetd_AI_122505A_6A_2_01.doc

Sales: 800-490-2361 Fax: 888-403-3360

Technical Assistance: 800-241-2060

PomonaACCESS 90260 (800) 444-6785 or (425) 446-6010

More drawings available at www.pomonaelectronics.com

Page 1 of 2