

**Models 72913**

**Panel Mt IEC1010 4mm (0.16in) jack for sheathed banana**

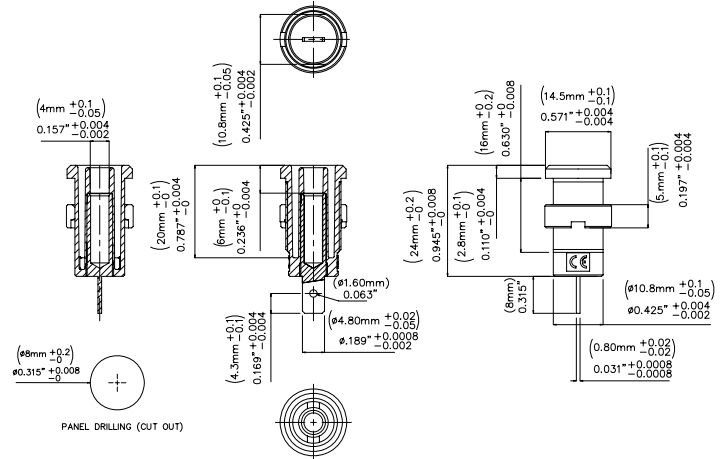
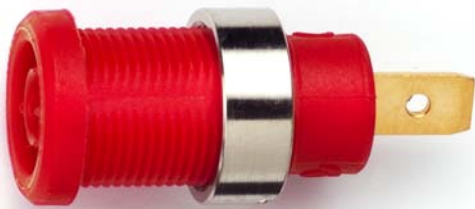

**Features**

- Panel Mt IEC1010 4mm (0.16in) jack for sheathed banana plugs.

**Materials**

- Body: Polyamide.
- Nut: Nickel plated
- Solder Tab: Gold plated Nickel brass.

**Ordering Information**

Model: 72913-Color sold in packages of 10 pieces.  
Available colors: Black (-0), Red (-2)

**Specifications**

Max Current	36A
Max Voltage	1000 V CAT III
Max Resistance	Less than 5 m Ω

**USA:** Sales: 800-490-2361 Technical Support: 800-241-2060 Fax: 888-403-3360

**Europe:** 31-(0) 40 2675 150 **International:** 425-446-5500

**e-mail:** [technicalsupport@pomonatest.com](mailto:technicalsupport@pomonatest.com)

**Where to Buy:** [www.pomonaelectronics.com](http://www.pomonaelectronics.com)

All dimensions are in inches. Tolerances (except noted): .xx = ± .02" (.51 mm), .xxx = ± .005" (.127 mm). All specifications are to the latest revisions. Specifications are subject to change without notice. Registered trademarks are the property of their respective companies.