

| REV | DATE | BY | CHKD | APPD | DESCRIPTION | DATE | APPD |
|-----|----------|----|------|------|-----------------------------------|----------|------|
| B | 6-13-91 | | | | REDRAWN ON CAD PER ECN A05477 | 6-13-91 | |
| C | 6-13-91 | | | | REVISED PER ECN 0010-1013-93 T.S. | 6-13-91 | |
| D | 11-17-93 | | | | ECN: 0010-1634-94 TH | 11-17-93 | |
| E | 14-06-91 | | | | REV PER ECN 0018-0199-01 | 14-06-91 | |
| F | 10-24-91 | | | | ADDED -7 PER ECN 0512-0200-02 | 10-24-91 | |

△ HOUSING MATERIAL: THERMOPLASTIC, BLACK.
 △ CONTACT MATERIAL: BERYLLIUM COPPER.
 △ CONTACT FINISH: .000050-.000100 NICKEL UNDERPLATE ALL OVER WITH .000030 GOLD IN CONTACT AREA AND .000100-.000200 TIN-LEAD PLATED POSTS.

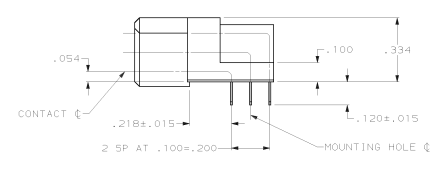

| | | | | | | | | |
|----------|-------|-------|----|--------|--------|--------|------------|-------------|
| | 6.475 | 6.000 | 60 | 12.524 | 12.950 | 13.250 | 366 | 534027-8 |
| | 4.475 | 4.100 | 41 | 8.524 | 8.950 | 9.250 | 246 | 534027-7 |
| OBsolete | 6.375 | 5.900 | 59 | 12.324 | 12.750 | 13.050 | 360 | 534027-6 |
| OBsolete | 6.125 | 5.700 | 57 | 11.924 | 12.350 | 12.650 | 348 | 534027-4 |
| | 5.575 | 5.100 | 51 | 10.724 | 11.150 | 11.450 | 312 | 534027-3 |
| OBsolete | 4.975 | 4.500 | 45 | 9.524 | 9.950 | 10.250 | 276 | 534027-2 |
| | 4.375 | 3.900 | 39 | 8.324 | 8.750 | 9.050 | 240 | 534027-1 |
| | F | E | D | C | B | A | NO OF POSN | PART NUMBER |

| | | |
|---|--|--|
| DO NOT SCALE PRINT, UNLESS SPECIFIED. DIMENSIONS IN INCHES. TOLERANCES: .010 ± P.L.C. DEC # .005 INCHES # ± | DR 6-13-91 J. GALLUCI BS CHR 12/10/91 DAVID WOFFORD | AMP AMP Incorporated Harrisburg, PA 17105-3608 |
| MATERIAL | NAME WAYNE WILKINSON | |
| FINISH | APPD 12/10/91 JIM WEBSTER MODIFY SPEC 108-1188 | ASSEMBLY, RECEPTACLE, TWIN BEAM CONNECTOR, 3 ROW, 2 MOUNTING HOLES, 1 GUIDE PIN, .120 POST LENGTH |
| RETURN | APPLICATION SPEC | SIZE D 00779 SCALE 4:1 DRAWING NO 534027 SHEET 1 OF 1 |

CUSTOMER DRAWING