

REPRODUCED IN THIS DRAWING WITHOUT PERMISSION
 THIS DRAWING IS UNPUBLISHED. RELEASED FOR PUBLICATION
 BY AMP INCORPORATED. ALL INTERNATIONAL RIGHTS RESERVED.
 © COPYRIGHT 19

REV	DATE	BY	CHKD	DESCRIPTION	DATE	APPD
D				REDRAWN ON LAD PER CON AD2477		TH
E				REVISED PER ECN 00 0-1013-93 T.S.		JW
F				ECN 0010-1176-93 C.J.		JW
G				REV 20 0010-1814-93 Q.L.		JW
H				ECN 0010-1684-94 TH		JW
J				PER EC 0010-0843-96 T.S.		JW
K				REV PER EC 0118-015-01		JW
L				REV PER EC 0118-0199-01		JW
M				REV PER EC 0312-0464-02		JW

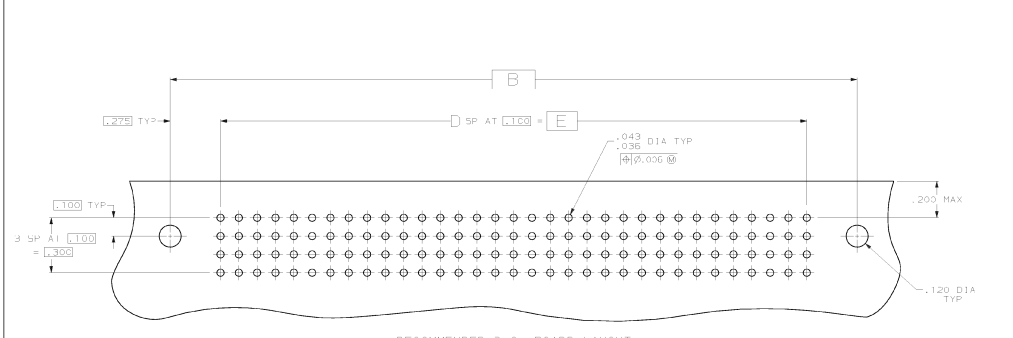

△ HOUSING MATERIAL: THERMOPLASTIC, BLACK.
 △ CONTACT MATERIAL: COPPER ALLOY.
 △ CONTACT FINISH: .00050-.000100 NICKEL UNDERPLATE ALL OVER WITH .000030 GOLD IN CONTACT AREA AND .000100-.000200 T14-LEAD PLATED POSTS.

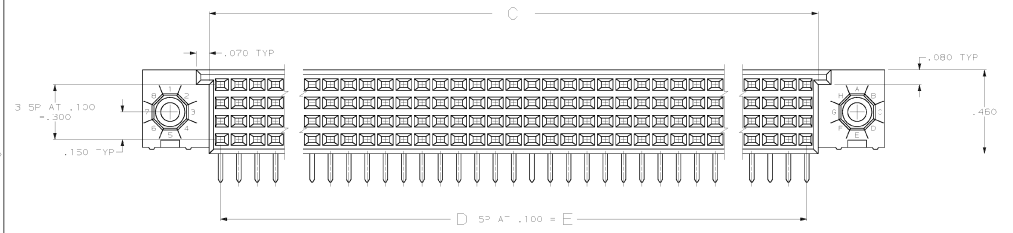
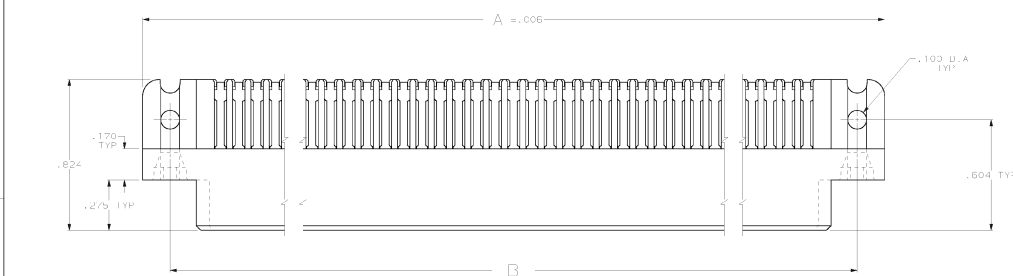
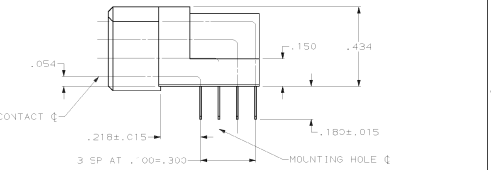

OBsolete	6.900	69	7.624	7.450	7.750	280	1-534047-8
OBsolete	7.100	41	7.624	7.750	7.950	160	1-534047-2
OBsolete	7.300	29	7.624	7.950	8.250	320	1-534047-6
OBsolete	7.400	24	7.624	7.950	8.250	300	1-534047-5
OBsolete	7.000	70	7.124	7.950	7.850	284	1-534047-4
OBsolete	6.400	64	6.624	6.750	7.050	260	1-534047-3
OBsolete	5.900	59	6.024	6.450	6.750	240	1-534047-2
OBsolete	4.900	49	5.024	5.450	5.750	200	1-534047-1
OBsolete	3.900	39	4.024	4.450	4.750	160	1-534047-0
OBsolete	1.400	34	1.524	1.950	2.250	140	1-534047-9
OBsolete	3.100	31	3.224	3.650	3.950	128	534047-B
OBsolete	2.900	29	3.024	3.450	3.750	120	534047-7
OBsolete	2.400	24	2.524	2.950	3.250	100	534047-6
OBsolete	1.900	19	2.024	2.450	2.750	80	534047-5
OBsolete	1.400	14	1.524	1.950	2.250	50	534047-4
OBsolete	1.100	11	1.224	1.650	1.950	48	534047-3
OBsolete	1.000	9	1.124	1.550	1.750	40	534047-2
OBsolete	700	7	7.124	7.250	1.310	37	534047-1

CONTRACT SCALE PRINT	DR 0-11-91	AMP	AMP Incorporated
UNLESS SPECIFIED DIMENSIONS IN INCHES TOLERANCES PER ASME Y14.5-1994	DR 7-28-93	NAME	Harrisburg, PA 17105-9606
PLS DEC * .05	AMPD 7-28-93	ASSEMBLY, RECEPTACLE,	
INCHES * .05	AMPD 7-28-93	14N FRAM CONDUCTOR,	
RESISTANCE	PRODOT SPEC	4 ROW, 3 MOUNTING HOLES,	
	108-109B	.180 POST LENGTH	
FINISH	APPLICATION SPEC	SIZE	DRAWING NO
		00779	534047
REIGHT		4:1	1 OF 1

CUSTOMER DRAWING