

13	12	11	10	9	8	7	6	5	4	3	2	1
ASSEMBLY NUMBER		FINISH										
73656-0000		SEE NOTE 2.										
73656-0001		SEE NOTE 3.										

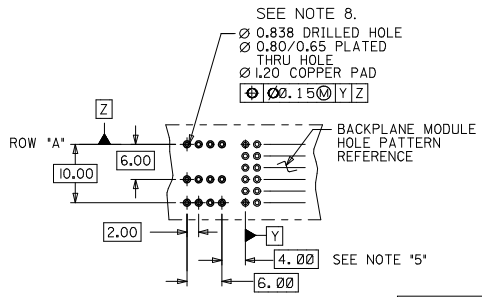
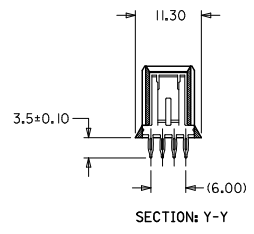
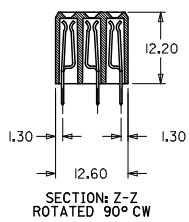
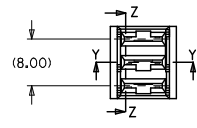
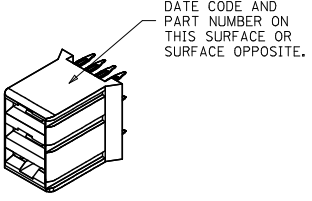

PCB LAYOUT: COMPONENT SIDE
RECOMMENDED PCB THICKNESS: 2.50 MIN

- NOTES:
1. MATERIALS: HOUSING - LIQUID CRYSTAL POLYMER (LCP), GLASS-FILLED, UL94V-0, COLOR: BLACK
TERMINAL - COPPER ALLOY
 2. FINISH: SELECTIVE GOLD (Au) IN CONTACT AREA, 0.76 micrometer MINIMUM THICKNESS: NICKEL (Ni) AND GOLD FLASH OVERALL
 3. FINISH: SELECTIVE GOLD (Au) IN CONTACT AREA, 0.76 micrometer MINIMUM THICKNESS: TIN/LEAD (Sn/Pb) OVER NICKEL (Ni) IN COMPLIANT AREA: NICKEL (Ni) OVERALL ON REMAINING WITH SELECTIVE GOLD (Au) FLASH.
 4. THIS DIMENSION MUST BE A MULTIPLE OF 4.00 mm.
 5. DIMENSIONS ARE IN MILLIMETERS.
 6. THIS PART CONFORMS TO MOLEX PRODUCT SPECIFICATION PS-73670-9999.
 7. PACKAGE ASSEMBLIES PER PK-70873-0819.
 8. HOLE SIZE SPECIFICATION IS FOR TIN/LEAD PLATED HOLES ONLY. FOR OTHER PLATING TYPES SEE MOLEX APPLICATION AS-73670-9996.
 9. THIS PART CONFORMS TO MOLEX COSMETIC SPECIFICATION PS-45499-002 CLASS B.

ADD NOTES 8 & 9 EC NO: LCP2009-1813 DRW:SDANIELLEY 2009/07/17 CHK:RSWART 2009/07/24 APPR:SMILLER 2009/07/24	QUALITY SYMBOLS	GENERAL TOLERANCES (UNLESS SPECIFIED)	DIMENSION STYLE	SCALE	DESIGN UNITS	THIRD ANGLE PROJECTION																				
	$\nabla=0$ $\nabla=0$	<table border="1"> <tr><th colspan="2">mm</th><th colspan="2">INCH</th></tr> <tr><td>4 PLACES</td><td>±---</td><td>±---</td><td>±---</td></tr> <tr><td>3 PLACES</td><td>±---</td><td>±---</td><td>±---</td></tr> <tr><td>2 PLACES</td><td>±---</td><td>±---</td><td>±---</td></tr> <tr><td>1 PLACE</td><td>±---</td><td>±---</td><td>±---</td></tr> </table>	mm		INCH		4 PLACES	±---	±---	±---	3 PLACES	±---	±---	±---	2 PLACES	±---	±---	±---	1 PLACE	±---	±---	±---	MM ONLY	1:1	METRIC	
	mm		INCH																							
	4 PLACES	±---	±---	±---																						
3 PLACES	±---	±---	±---																							
2 PLACES	±---	±---	±---																							
1 PLACE	±---	±---	±---																							
DESCRIPTION	<table border="1"> <tr><td>DRAWN BY</td><td>DATE</td><td>TITLE</td></tr> <tr><td>ELO</td><td>1998/05/21</td><td>SALES ASSY , HDM</td></tr> <tr><td>CHECKED BY</td><td>DATE</td><td>BACKPLANE POWER MODULE</td></tr> <tr><td>SMR</td><td>1998/05/21</td><td>(PRESSFIT)</td></tr> <tr><td>APPROVED BY</td><td>DATE</td><td></td></tr> <tr><td>CAB</td><td>1998/05/21</td><td></td></tr> </table>	DRAWN BY	DATE	TITLE	ELO	1998/05/21	SALES ASSY , HDM	CHECKED BY	DATE	BACKPLANE POWER MODULE	SMR	1998/05/21	(PRESSFIT)	APPROVED BY	DATE		CAB	1998/05/21		MOLEX INCORPORATED	MATERIAL NO.	DOCUMENT NO.	SHEET NO.			
DRAWN BY	DATE	TITLE																								
ELO	1998/05/21	SALES ASSY , HDM																								
CHECKED BY	DATE	BACKPLANE POWER MODULE																								
SMR	1998/05/21	(PRESSFIT)																								
APPROVED BY	DATE																									
CAB	1998/05/21																									
REV	DRAFT WHERE APPLICABLE MUST REMAIN WITHIN DIMENSIONS	SEE TABLE	SDA-73656-*00*	1 OF 4																						

DATE CODE AND PART NUMBER ON THIS SURFACE OR SURFACE OPPOSITE.

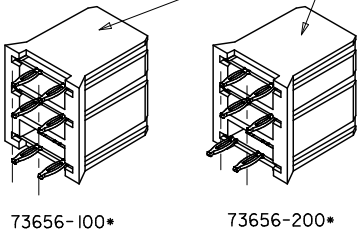

MIDPLANE OPTION

ASSEMBLY NUMBER	FINISH (SEE SHT 1)
73656-1000	SEE NOTE 2. (GOLD TAILS)
73656-2000	
73656-1001	SEE NOTE 3. (TIN/LEAD TAILS)
73656-2001	

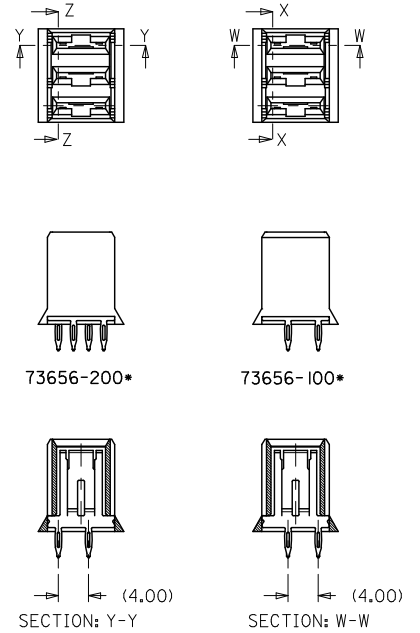

USE BACKPLANE MODULE HOLE REFERENCE PATTERN FROM SHEET 1

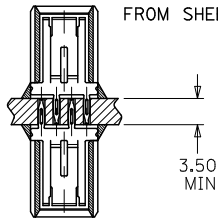

BACK-TO-BACK MOUNTING APPLICATION

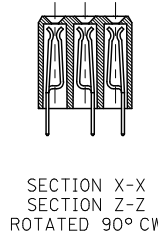

SEE SHEET 1 EC NO. UCP2009-1813 DRWN:SDANIELLEY 2009/07/17 CHKD:RSMART 2009/07/24 APPR:SKILLER 2009/07/24	QUALITY SYMBOLS ▽=0 ▽=0	GENERAL TOLERANCES (UNLESS SPECIFIED)		DIMENSION STYLE MM ONLY	SCALE 1:1	DESIGN UNITS METRIC	THIRD ANGLE PROJECTION	
			mm	INCH	DRAWN BY ELO	DATE 1998/05/21	TITLE SALES ASSY , HDM BACKPLANE POWER MODULE (PRESSFIT) MOLEX INCORPORATED	
		4 PLACES	± ---	± ---	CHECKED BY SMR	DATE 1998/05/21		
		3 PLACES	± ---	± ---	APPROVED BY CAB	DATE 1998/05/21		
2 PLACES	± ---	± ---	MATERIAL NO. SEE TABLE	DOCUMENT NO. SDA-73656-*00*	SHEET NO. 2 OF 4			
1 PLACE	± ---	± ---	ANGULAR ±1/2°		THIS DRAWING CONTAINS INFORMATION THAT IS PROPRIETARY TO MOLEX INCORPORATED AND SHOULD NOT BE USED WITHOUT WRITTEN PERMISSION			
DRAFT WHERE APPLICABLE MUST REMAIN WITHIN DIMENSIONS								

ASSEMBLY NUMBER	FINISH (SHT I)
73656-5000	SEE NOTE 2.
73656-5001	SEE NOTE 3.

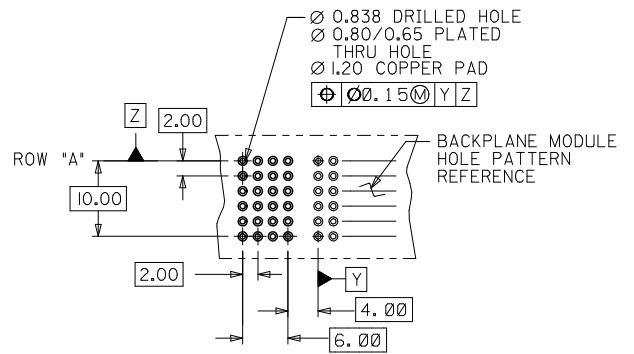
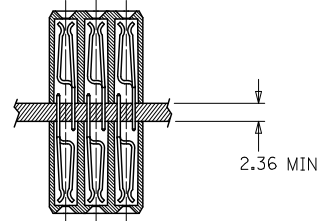
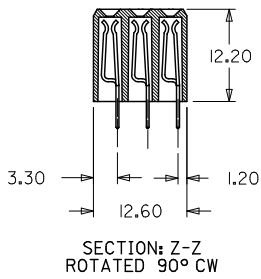
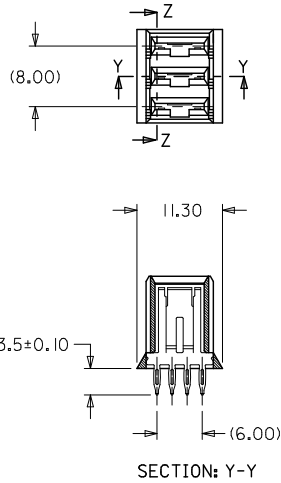
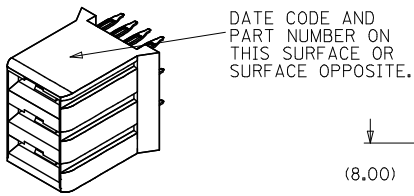

SEE SHEET 1 IEC NO. UCP2009-1813 DRWN:SDANIELLEY 2009/07/17 CHKD:RSMART 2009/07/24 APPR:SKILLER 2009/07/24	QUALITY SYMBOLS ▽=0 ▽=0	GENERAL TOLERANCES (UNLESS SPECIFIED)		DIMENSION STYLE MM ONLY	SCALE 1:1	DESIGN UNITS METRIC	THIRD ANGLE PROJECTION		
		4 PLACES ± --- ± ---	3 PLACES ± --- ± ---	2 PLACES ± --- ± ---	1 PLACE ± --- ± ---	DRAWN BY ELO	DATE 1998/05/21	TITLE SALES ASSY , HDM BACKPLANE POWER MODULE (PRESSFIT)	
		ANGULAR ±1/2°				CHECKED BY SMR	DATE 1998/05/21	MOLEX INCORPORATED	
		DRAFT WHERE APPLICABLE MUST REMAIN WITHIN DIMENSIONS				APPROVED BY CAB	DATE 1998/05/21	MATERIAL NO. SEE TABLE	DOCUMENT NO. SDA-73656-*00*
				SIZE B	THIS DRAWING CONTAINS INFORMATION THAT IS PROPRIETARY TO MOLEX INCORPORATED AND SHOULD NOT BE USED WITHOUT WRITTEN PERMISSION			SHEET NO. 3 OF 4	

ASSEMBLY NUMBER	FINISH
73656-0180	SEE NOTE 2.
73656-0181	SEE NOTE 3.

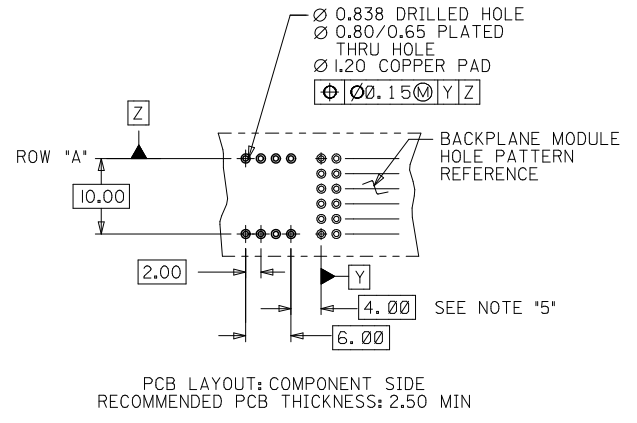
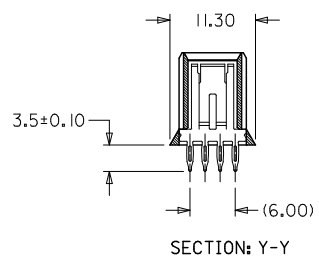
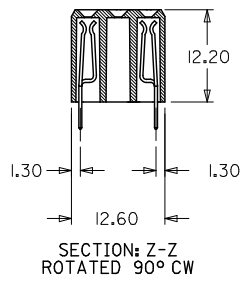
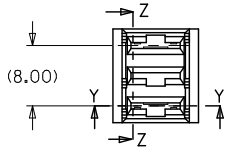
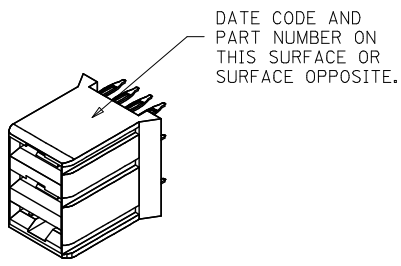

SEE SHEET 1 EC NO: UCP2009-1813 DRAWN: DANIELLEY 2009/07/17 CHKD: SMART 2009/07/24 APPR: MILLER 2009/07/24	QUALITY SYMBOLS ▽=0 ▽=0	GENERAL TOLERANCES (UNLESS SPECIFIED)		DIMENSION STYLE MM ONLY	SCALE 1:1	DESIGN UNITS METRIC	THIRD ANGLE PROJECTION		
		4 PLACES ± --- ± ---	3 PLACES ± --- ± ---	2 PLACES ± --- ± ---	1 PLACE ± --- ± ---	DRAWN BY ELO 1998/05/21	CHECKED BY SMR 1998/05/21	TITLE SALES ASSY, HDM BACKPLANE POWER MODULE (PRESSFIT)	
		ANGULAR ±1/2°				APPROVED BY CAB 1998/05/21	MOLEX INCORPORATED		
		DRAFT WHERE APPLICABLE MUST REMAIN WITHIN DIMENSIONS		MATERIAL NO. SEE TABLE	DOCUMENT NO. SDA-73656-*00*	SHEET NO. 4 OF 4			

10 9 8 7 6 73656 4 3 2 73656

DATE CODE AND PART NUMBER ON THIS SURFACE OR SURFACE OPPOSITE.

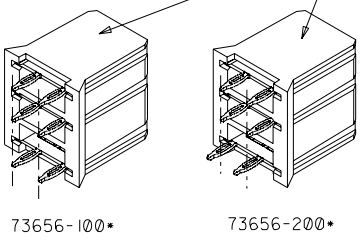

MIDPLANE OPTION

ASSEMBLY NUMBER	FINISH (SEE SHT 1)
73656-1000	SEE NOTE 2. (GOLD TAILS)
73656-2000	
73656-1001	SEE NOTE 3. (TIN/LEAD TAILS)
73656-2001	

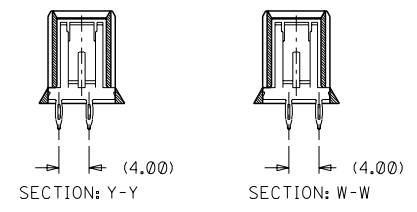
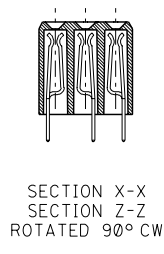
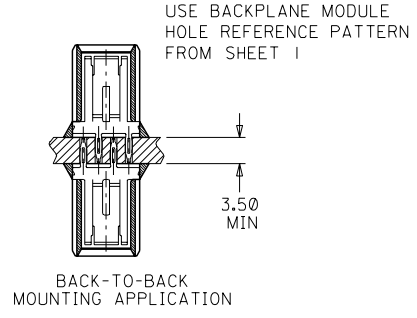
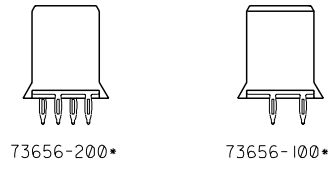
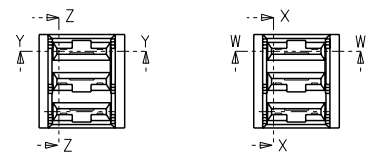

				D		B		A		REVISIONS		REVISIONS		DIMENSIONS SHOWN (METRIC) INCH UNLESS OTHERWISE SPECIFIED TOLERANCES: ANGULAR ± 1/2°		REVISE ONLY ON CAD SYSTEM	
					SEE SHEET 1										3 PLACE ± N/A	---	TITLE
					SEE SHEET 1										2 PLACE ± N/A	± ---	SALES ASSY, HDM BACKPLANE POWER MODULE (PRESS FIT)
					SEE SHEET 1										1 PLACE ---	± ---	MOLEX INCORPORATED
																	LSLEJLL
																	68532
																	SHEET NO.
																	2
																	DATE
																	98/05/21
																	U.S.A.
																	DRWG. NO.
																	SDA-73656-00*
																	FILE NAME
																	S73656X2
																	DGN
																	THIS DRAWING CONTAINS INFORMATION THAT IS PROPRIETARY TO MOLEX INC. AND SHOULD NOT BE USED WITHOUT WRITTEN PERMISSION.
																	DIV.
																	DA
																	SIZE
																	B