

4

3

2

1

THIS DRAWING IS UNPUBLISHED. RELEASED FOR PUBLICATION
 © COPYRIGHT - BY TYCO ELECTRONICS CORPORATION. ALL RIGHTS RESERVED.

LOC	DIST	REVISIONS				
P	LTR	DESCRIPTION	DATE	DWN	APVD	
GP	00	REV PER ECO-10-020184	12JAN2011	RG	NE	

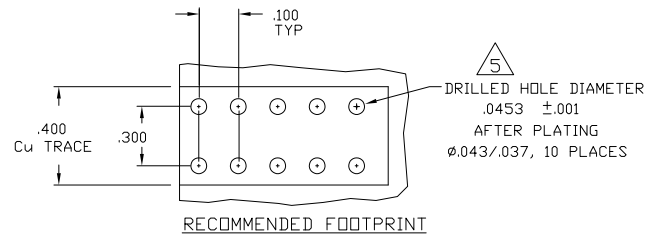
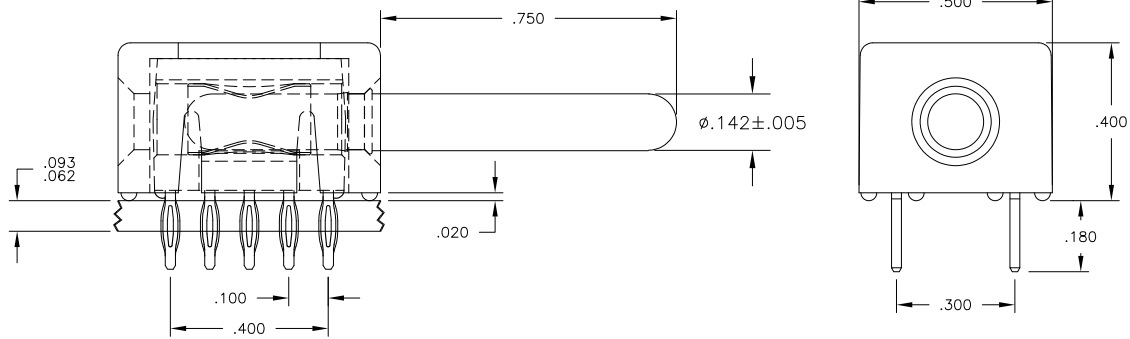

- △ FINISH FOR COMPLIANT PIN: .00020 MIN THK. SILVER OVER .000040 MIN THK. NICKEL.
- △ FINISH FOR COMPLIANT PIN: .000040 MIN THK. TIN OVER .000050 MIN THK. NICKEL.
- △ FOR APPLICATIONS UTILIZING AN IMMERSION SILVER PLATED PCB, CONTACT TYCO ENGINEERING.
- 4. FINISH:
 - INSULATOR - AS MOLDED COLOR BLACK
 - MODULE - SILVER PLATED .0002 MIN THK. OVER NICKEL .000040 MIN THK.
 - CROWN - GOLD PLATED .000030 MIN THK. OVER NICKEL .000040 MIN THK.
 - PIN CONTACT - SILVER PLATED .00020 MIN THK. OVER NICKEL .000040 MIN THK.

- 3. MATERIAL:
 - INSULATOR - POLYESTER, GLASS FILLED, UL 94 V-0
 - MODULE - ZINC ALLOY
 - CROWN - COPPER ALLOY
 - PIN CONTACT - BRASS
 - COMPLIANT PIN - PHOSPHOR BRONZE

2. ITEMS PROVIDED TO THIS SPECIFICATION SHALL BE IDENTIFIED ON CONTAINER WITH THE FOLLOWING INFORMATION PART NUMBER AND DATE CODE OF MANUFACTURE.

1. PART NUMBER CHANGES AND/OR DESIGN CHANGES AFFECTING ITEM INTERCHANGEABILITY REQUIRE PRIOR TYCO APPROVAL AND AUTHORIZATION BY REVISION TO THIS DRAWING.

△ 6	6643443-2
△ 7	6643443-1
DESCRIPTION	PART NUMBER

THIS DRAWING IS A CONTROLLED DOCUMENT.		DWN R.GRZYBOWSKI 21AUG06	Tyco Electronics Tyco Electronics Corporation Harrisburg, PA 17105-3608													
DIMENSIONS: INCHES		CHK S.FLICKINGER 21AUG06	NAME S.FLICKINGER													
TOLERANCES UNLESS OTHERWISE SPECIFIED:		APVD S.FLICKINGER 21AUG06	PRODUCT SPEC													
<table border="1"> <tr><td>0 PLC</td><td>± .</td></tr> <tr><td>1 PLC</td><td>± .</td></tr> <tr><td>2 PLC</td><td>± .02 [-.3]</td></tr> <tr><td>3 PLC</td><td>± .010 [-.25]</td></tr> <tr><td>4 PLC</td><td>± .</td></tr> <tr><td>ANGLES</td><td>± .5</td></tr> </table>		0 PLC	± .	1 PLC	± .	2 PLC	± .02 [-.3]	3 PLC	± .010 [-.25]	4 PLC	± .	ANGLES	± .5	APPLICATION SPEC		ICCON PIN, PARALLEL, COMPLIANT PIN NONLOCKING, 10 PIN FOOTPRINT
0 PLC	± .															
1 PLC	± .															
2 PLC	± .02 [-.3]															
3 PLC	± .010 [-.25]															
4 PLC	± .															
ANGLES	± .5															
MATERIAL	FINISH	WEIGHT	SIZE A3	CAGE CODE 00779												
			DRAWING NO C-6643443	RESTRICTED TO												
CUSTOMER DRAWING			SCALE 4:1	SHEET 1 OF 1 REV C												